

DATE	
BY	
REVISION	
NO.	
PLAN	
NOTE BOOK	
NO.	
DATE	
BY	
REVISION	
NO.	

DATE	
BY	
REVISION	
NO.	
PROFILE	
NOTE BOOK	
NO.	
DATE	
BY	
REVISION	
NO.	

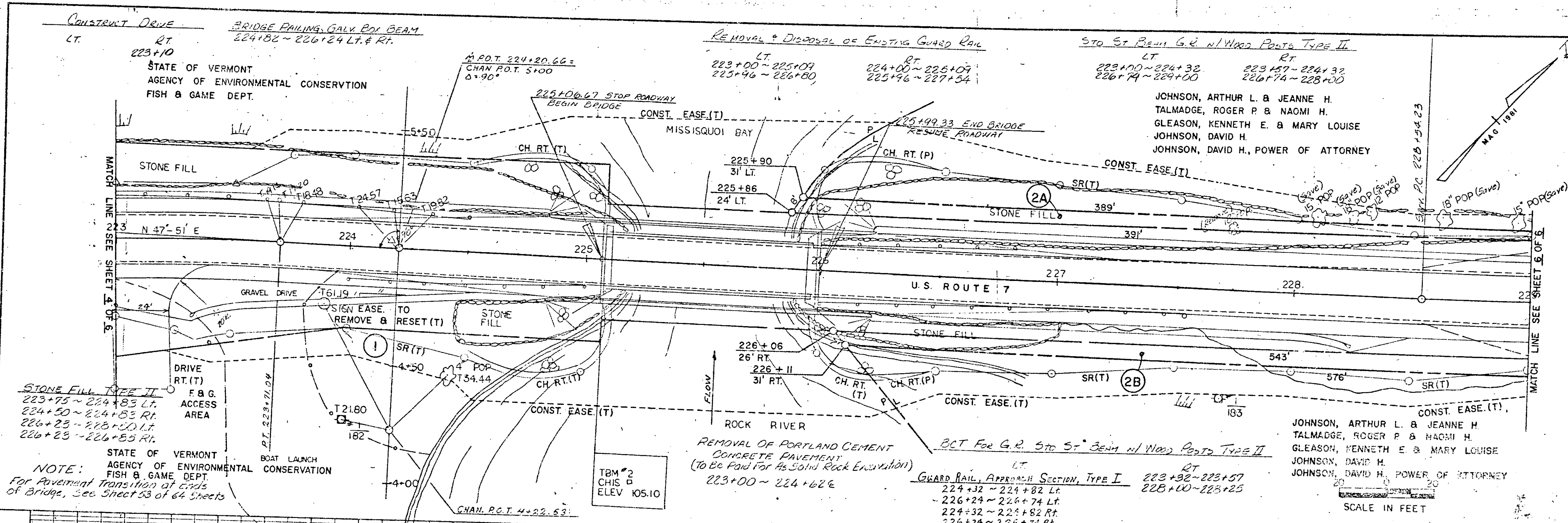

STONE FILL TYPE II  
 223+75 ~ 224+83 LT.  
 224+50 ~ 224+83 RT.  
 226+23 ~ 228+50 LT.  
 226+23 ~ 226+85 RT.

STATE OF VERMONT  
 AGENCY OF ENVIRONMENTAL CONSERVATION  
 FISH & GAME DEPT.  
 NOTE:  
 For Pavement Transition at ends  
 of Bridge, See Sheet 53 of 64 sheets

REMOVAL OF PORTLAND CEMENT  
 CONCRETE PAVEMENT  
 (TO BE PAID FOR AS SOLID ROCK EXCAVATION)  
 223+00 ~ 224+62 E

GUARD RAIL, APPROACH SECTION, TYPE I  
 LT. 224+32 ~ 224+82 Lt.  
 RT. 226+24 ~ 226+74 Rt.  
 224+32 ~ 224+82 Rt.  
 226+24 ~ 226+74 Rt.

JOHNSON, ARTHUR L. & JEANNE H.  
 TALMADGE, ROGER P. & NAOMI H.  
 GLEASON, KENNETH E. & MARY LOUISE  
 JOHNSON, DAVID H.  
 JOHNSON, DAVID H., POWER OF ATTORNEY

JOHNSON, ARTHUR L. & JEANNE H.  
 TALMADGE, ROGER P. & NAOMI H.  
 GLEASON, KENNETH E. & MARY LOUISE  
 JOHNSON, DAVID H.  
 JOHNSON, DAVID H., POWER OF ATTORNEY

SCALE IN FEET

THIS SHEET TO BE USED  
 FOR ROW INFORMATION ONLY

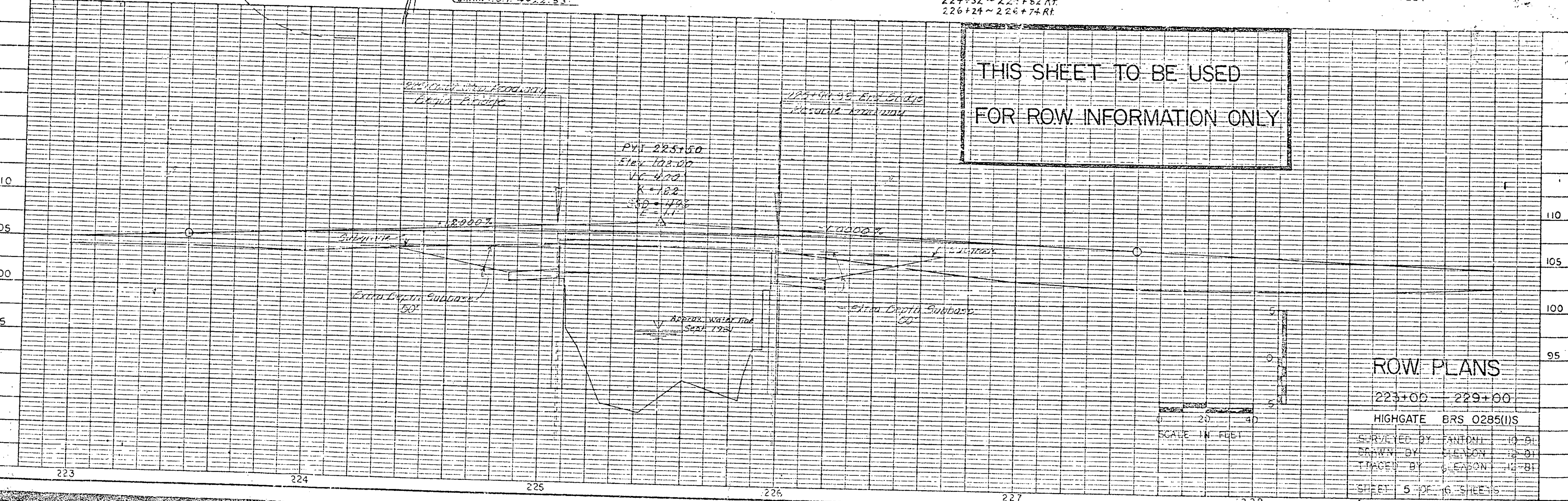

ROW PLANS

223+00 - 229+00

HIGHGATE BRS 0285(II)

SURVEYED BY FANTONI 10-BI

DRAWN BY GLEASON 12-BI

TRACED BY GLEASON 12-BI

SHEET 5 OF 6 SHEETS