

METRIC

1. ALL DIMENSIONS ARE IN MILLIMETERS UNLESS OTHERWISE NOTED.
2. ALL WEIGHTS ARE IN KILOGRAMS.

FED. ROAD DIV. NO.	STATE	FED. AID PROJ. NO.
	VT	

BILL OF MATERIAL

QTY EA.	MARK	COMM.	DESCRIPTION	LENGTH	SPEC	GRADE	TEST	REMARKS	GRP.	ITEM	SHIP WEIGHT EA.
CF22 CROSSFRAMES											
2	CF22		CROSSFRAMES								355.57
4	a	L	152 x 152 x 12.7	1915	M270M	345W	T	(L6 x6x1/2)	11	2	56.88
2	b	L	152 x 152 x 12.7	2564	M270M	345W	T	(L6 x6x1/2)	11	2	76.15
2	c	L	152 x 152 x 12.7	2316	M270M	345W	T	(L6 x6x1/2)	11	2	68.79
4	m1h	PL	16 x 425	460	M270M	345W	T		11	3	24.55
4	m1m	PL	16 x 400	415	M270M	345W	T		11	3	20.85
2	m1p	PL	16 x 202	240	M270M	345W	T	FILL	11	3	6.09
CF23 CROSSFRAMES											
3	CF23		CROSSFRAMES								355.48
6	a	L	152 x 152 x 12.7	1914	M270M	345W	T	(L6 x6x1/2)	11	2	56.85
3	b	L	152 x 152 x 12.7	2560	M270M	345W	T	(L6 x6x1/2)	11	2	76.03
3	c	L	152 x 152 x 12.7	2319	M270M	345W	T	(L6 x6x1/2)	11	2	68.87
6	m1h	PL	16 x 425	460	M270M	345W	T		11	3	24.55
6	m1m	PL	16 x 400	415	M270M	345W	T		11	3	20.85
3	m1p	PL	16 x 202	240	M270M	345W	T	FILL	11	3	6.09
ONE CF24 CROSSFRAME											
2	a	L	152 x 152 x 12.7	1914	M270M	345W	T	(L6 x6x1/2)	11	2	56.85
1	b	L	152 x 152 x 12.7	2560	M270M	345W	T	(L6 x6x1/2)	11	2	76.03
1	c	L	152 x 152 x 12.7	2319	M270M	345W	T	(L6 x6x1/2)	11	2	68.87
2	m1k	PL	16 x 425	460	M270M	345W	T		11	3	24.55
2	m1n	PL	16 x 400	415	M270M	345W	T		11	3	20.85
1	m1s	PL	16 x 202	240	M270M	345W	T	FILL	11	3	6.09
ONE CF25 CROSSFRAME											
2	a	L	152 x 152 x 12.7	1914	M270M	345W	T	(L6 x6x1/2)	11	2	56.85
1	b	L	152 x 152 x 12.7	2557	M270M	345W	T	(L6 x6x1/2)	11	2	75.94
1	c	L	152 x 152 x 12.7	2322	M270M	345W	T	(L6 x6x1/2)	11	2	68.96
2	m1h	PL	16 x 425	460	M270M	345W	T		11	3	24.55
2	m1m	PL	16 x 400	415	M270M	345W	T		11	3	20.85
1	m1p	PL	16 x 202	240	M270M	345W	T	FILL	11	3	6.09
ONE CF26 CROSSFRAME											
2	a	L	152 x 152 x 12.7	1913	M270M	345W	T	(L6 x6x1/2)	11	2	56.82
1	b	L	152 x 152 x 12.7	2550	M270M	345W	T	(L6 x6x1/2)	11	2	75.74
1	c	L	152 x 152 x 12.7	2329	M270M	345W	T	(L6 x6x1/2)	11	2	69.17
2	m1h	PL	16 x 425	460	M270M	345W	T		11	3	24.55
2	m1m	PL	16 x 400	415	M270M	345W	T		11	3	20.85
1	m1p	PL	16 x 202	240	M270M	345W	T	FILL	11	3	6.09
CF27 CROSSFRAMES											
2	CF27		CROSSFRAMES								355.39
4	a	L	152 x 152 x 12.7	1913	M270M	345W	T	(L6 x6x1/2)	11	2	56.82
2	b	L	152 x 152 x 12.7	2546	M270M	345W	T	(L6 x6x1/2)	11	2	75.62
2	c	L	152 x 152 x 12.7	2332	M270M	345W	T	(L6 x6x1/2)	11	2	69.26
4	m1h	PL	16 x 425	460	M270M	345W	T		11	3	24.55
4	m1m	PL	16 x 400	415	M270M	345W	T		11	3	20.85
2	m1p	PL	16 x 202	240	M270M	345W	T	FILL	11	3	6.09

TOTAL WEIGHT THIS SHEET: 3554.78 kg

VTmas
RECEIVED
OK'D BY: JWC
JUN 21 2005
RESUBMIT: _____
BY: _____ DATE: _____

- Reviewed
- Rejected
- Furnish as Corrected
- Revise and Resubmit
- Submit Specified Item

This review is only for general conformance with the design concept and the information given in the Construction Documents. Corrections or comments made on the shop drawings during this review do not relieve the contractor from compliance with the requirements of the plans and specifications. Review of a specific item shall not include review of an assembly of which the item is a component. The Contractor is responsible for dimensions to be confirmed and corrected at the jobsite; information that pertains solely to the fabrication process or to the materials, methods, techniques, sequences, and procedures of construction; coordination of the Work with that of all other trades and performing all work in a safe and satisfactory manner.

McFarland-Johnson, Inc.
Date: 6/10/05
By: etw

SHOP NOTE

HOLES: 1 5/16"
BOLTS: NONE
PAINT: SEE DWG. GNI (U.N.)
FOR GENERAL SHOP NOTES, SEE DWG. GNI.

NO.	REVISION	BY	DATE

1770 Hempstead Road
Lancaster, PA 17605-0008
Phone 717/299-5211
HIGH STEEL STRUCTURES, INC.
A Division of High Industries, Inc.

CROSSFRAMES CF22 THRU CF27
U.S. RTE. 5 (BRIDGE #60) OVER LULLS BROOK
U.S. RTE. 5 STA. 3+080.77 TO STA. 3+123.110
TOWN OF HARTLAND
WINDSOR COUNTY, VERMONT
STATE OF VERMONT, AGENCY OF TRANSPORTATION

STATE CONTRACT OR REF. NO. PROJECT NO. BRS-0113(22)
CONTRACTOR MILLER CONSTRUCTION, INC.
IN CHARGE: GLIDDEN (IH) MADE BY: K.L.W. CHK'D BY: MGK DATE: 4/18/05
CONTRACT NUMBER: VT-05017-1 DRAWING NUMBER: 4 OF 15

CODE:63

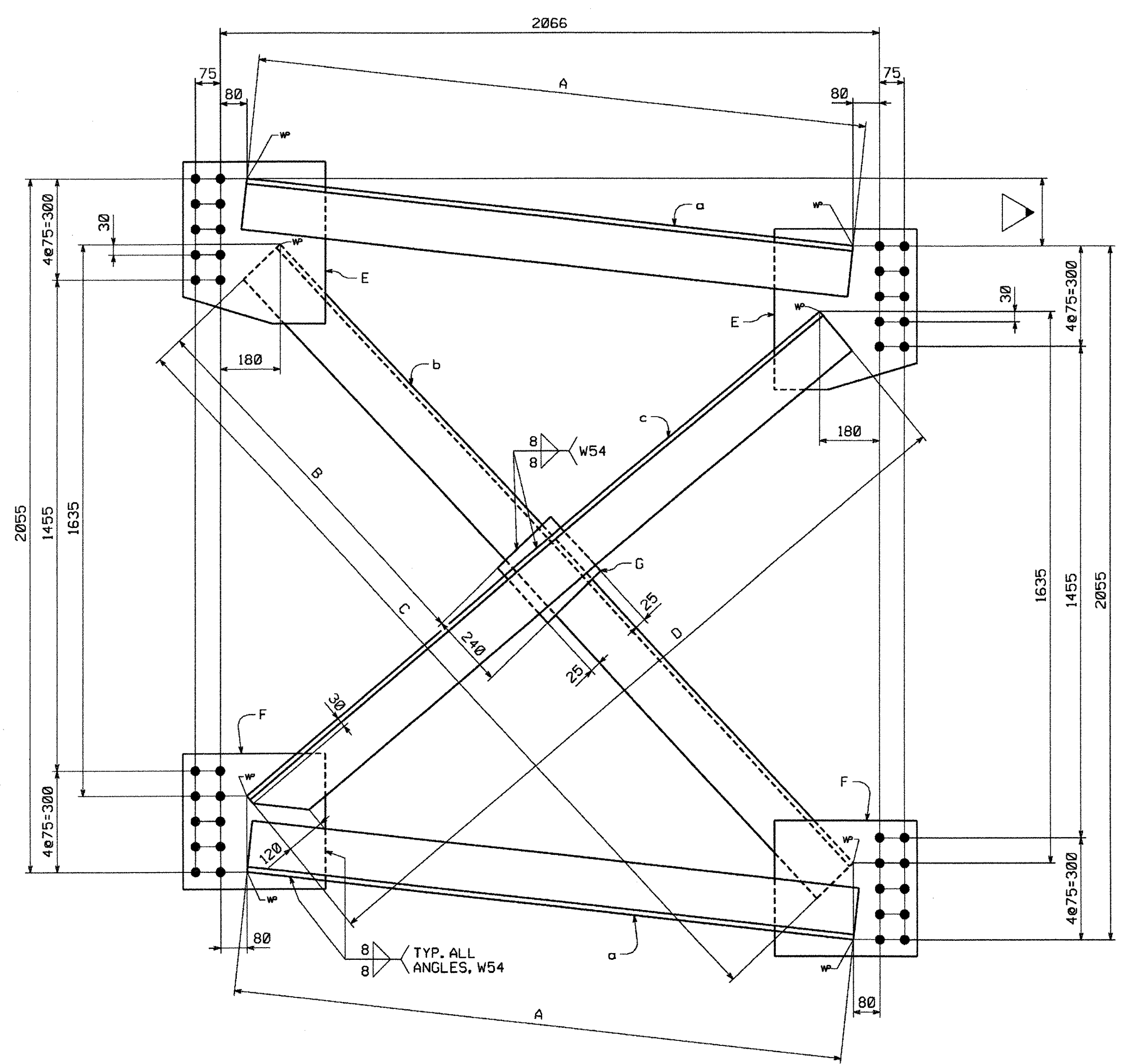

INTERMEDIATE CROSSFRAMES

MARK	A	B	C	D	E	F	G	REMARKS	
CF22	185	1915	1167	2564	2316	m1h	m1m	m1p	NO PAINT
CF23	180	1914	1166	2560	2319	m1h	m1m	m1p	NO PAINT
CF24						m1k	m1n	m1s	PAINTED
CF25	175	1914	1164	2557	2322	m1h	m1m	m1p	NO PAINT
CF26	165	1913	1160	2550	2329	m1h	m1m	m1p	NO PAINT
CF27	160	1913	1158	2546	2332	m1h	m1m	m1p	NO PAINT

BY: mkreud01
PLOTTED: 4/20/2005 6:45:05 AM