

NOTE: REBAR MARKS WITH A 2W PREFIX INDICATES A WINGWALL NO. 2 BAR, REBAR MARKS WITH A 2A OR 3W PREFIX INDICATES A WINGWALL NO. 3 BAR.

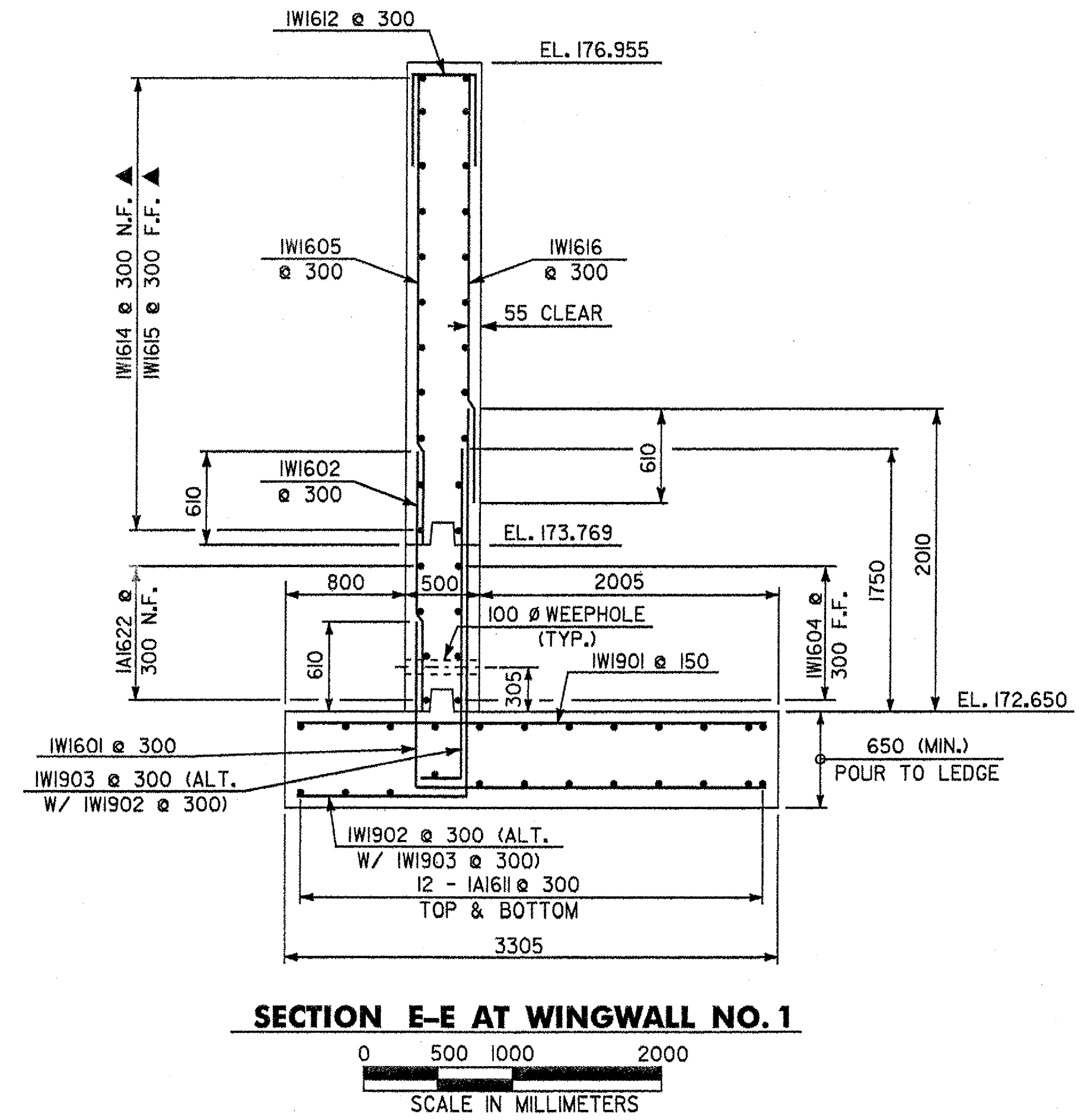
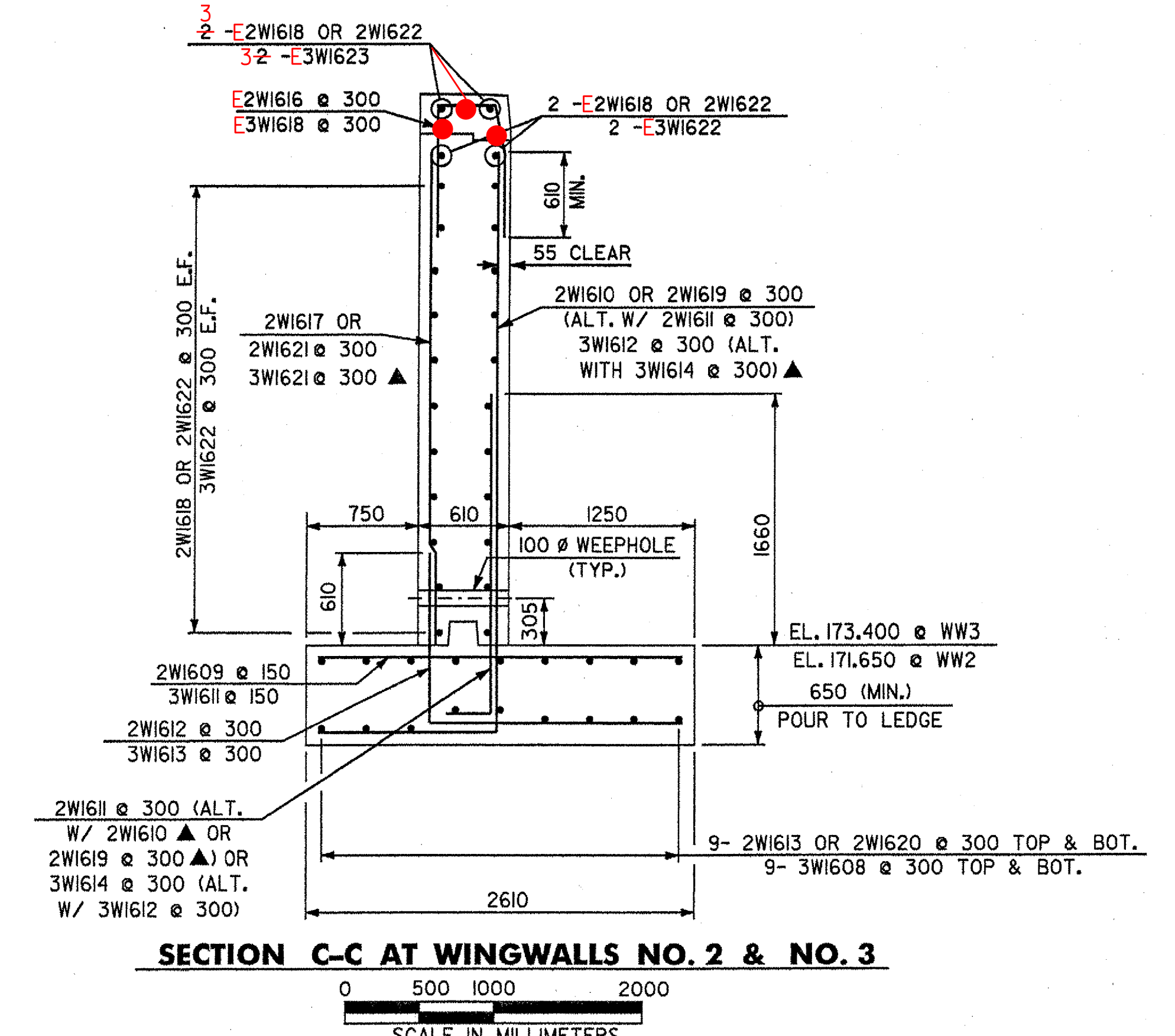
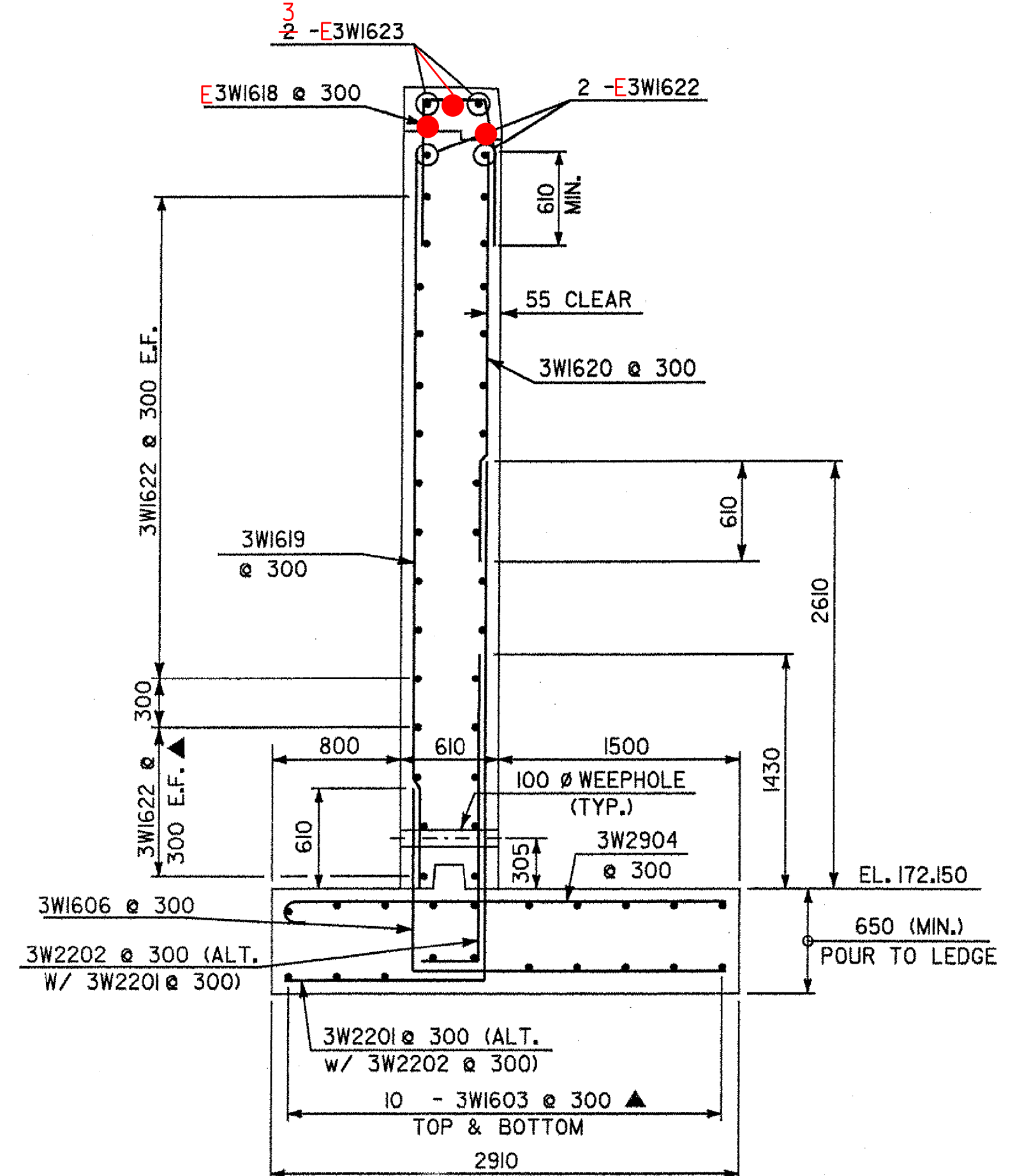

NOTES:
 N.F. - NEAR FACE
 F.F. - FAR FACE
 E.F. - EACH FACE
 REINFORCING COVER 80 CLEAR ON ALL FACES EXCEPT WHERE NOTED.
 FOR LOCATION OF SECTIONS A-A, B-B AND C-C, SEE SHEET BR124.
 FOR LOCATION OF SECTION E-E, SEE SHEET BR122.

STATE OF VERMONT AGENCY OF TRANSPORTATION	
Town Of	HARTLAND
Bridge No.	60
Highway No.	U.S. ROUTE 5
Log Sta.	
Surv. Sta.	
U.S. ROUTE 5 OVER LULLS BROOK	
WINGWALL NO. 1, NO. 2 & NO. 3 SECTIONS	
Designed By	S. BAKI
Drawn By	W. GAYNOR
Checked By	S. BAKI
Date	
Bridge Design Supervisor	J. MIECZKOWSKI
Date	
PROJECT	HARTLAND
PROJECT NO.	BRS No. 0113(22)
I.G.C. Info. M:\1456201\VA01 Hartland\struct\zf204wdt.dgn	
Bridge Sheet No.	BR125
Sheet	60 of 86