

LEGEND:

- PROPERTY LINE
- PERMANENT SLOPE LIMITS
- RIPARIAN BUFFER
- STONE LINED APRON
- DISTURBED AREAS WHERE SEEDING AND MULCHING HAVE BEEN APPLIED

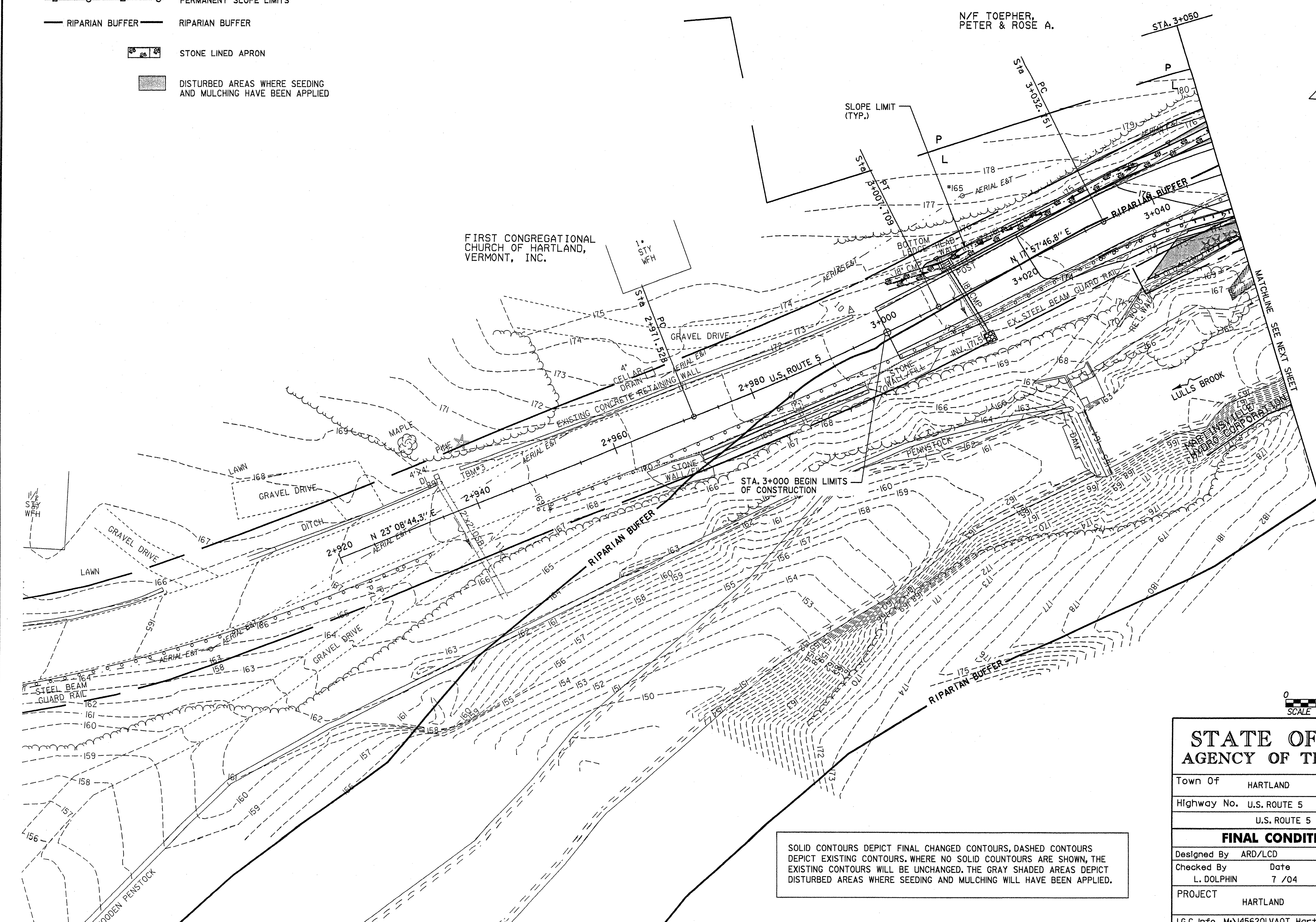
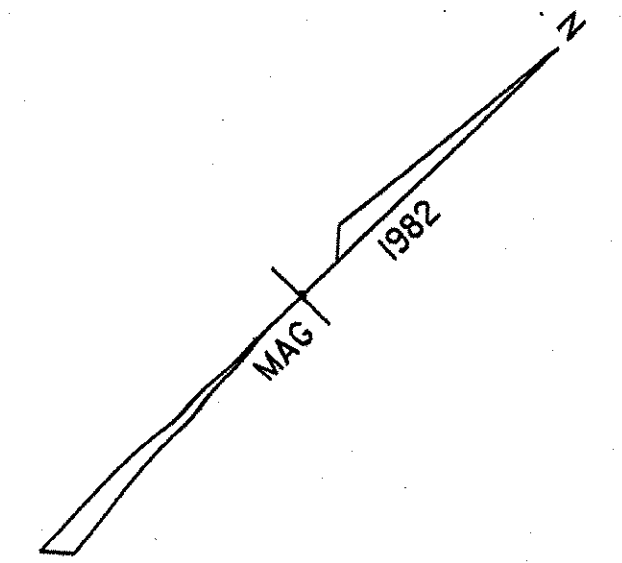

FIRST CONGREGATIONAL CHURCH OF HARTLAND, VERMONT, INC.

N/F TOEPHER, PETER & ROSE A.

SLOPE LIMIT (TYP.)

2+980 U.S. ROUTE 5

STA. 3+000 BEGIN LIMITS OF CONSTRUCTION

STA. 3+050

MATCHLINE SEE NEXT SHEET



**STATE OF VERMONT
AGENCY OF TRANSPORTATION**

Town Of	HARTLAND	Bridge No.	60
Highway No.	U.S. ROUTE 5	Log Sta.	
		Surv. Sta.	
U.S. ROUTE 5 OVER LULLS BROOK			

FINAL CONDITIONS SITE PLAN

Designed By	ARD/LCD	Drawn By	A. DUGON
Checked By	L. DOLPHIN	Bridge Design Supervisor	J. MIECZKOWSKI
Date	7 / 04	Date	7 / 04
PROJECT	HARTLAND	PROJECT NO.	BRS No. 013(22)
I.G.C. Info.	M:\1456201\VA0T Hartland\zvf204ES_ECFINAL.dgn		
Bridge Sheet No.		Sheet	30 of 86

SOLID CONTOURS DEPICT FINAL CHANGED CONTOURS, DASHED CONTOURS DEPICT EXISTING CONTOURS. WHERE NO SOLID CONTOURS ARE SHOWN, THE EXISTING CONTOURS WILL BE UNCHANGED. THE GRAY SHADED AREAS DEPICT DISTURBED AREAS WHERE SEEDING AND MULCHING WILL HAVE BEEN APPLIED.