

- LEGEND:**
- SOIL BOUNDARY
  - P --- PROPERTY LINE
  - L --- PROPERTY LINE
  - FLOOD PLAN BOUNDARY
  - RIPARIAN BUFFER
  - RIPARIAN BUFFER
  - HIGHWAY RIGHT-OF-WAY
  - TEST UNIT INDICATING HISTORIC MATERIAL
  - (ID) SOIL TYPE
  - VT-WN-XXX HISTORIC SITE

- SOILS KEY AND DESCRIPTION**
- (ID) HITCHCOCK SILT LOAM  
15-25% SLOPES  
HYDROLOGIC SOIL GROUP B  
DEPTH TO BEDROCK: 60'  
DEPTH TO WATER TABLE: 6'  
HIGHLY ERODIBLE
  - (20E) SHELBURNE FINE SANDY LOAM  
3-8% SLOPES  
HYDROLOGIC SOIL GROUP D  
DEPTH TO BEDROCK: 10'-40'  
DEPTH TO WATER TABLE: 6'  
HIGHLY ERODIBLE
  - (32B) RUMNEY FINE SANDY LOAM  
0 TO 3% SLOPES  
HYDROLOGIC SOIL GROUP: NOT RATED  
DEPTH TO BEDROCK: UNRANKED  
DEPTH TO WATER TABLE: UNRANKED  
NOT HIGHLY ERODIBLE

LINES SHOWN ON THIS PLAN AS EXISTING PROPERTY LINES (P/L) ARE BELIEVED TO BE ACCURATE BUT SHOULD NOT BE RELIED UPON FOR PURPOSES UNRELATED TO THE STATE OF VERMONT'S ACQUISITION OF LAND AND RIGHTS FOR THIS PROJECT.

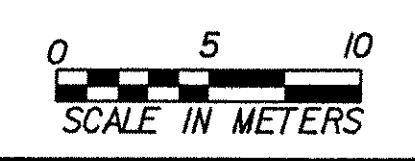
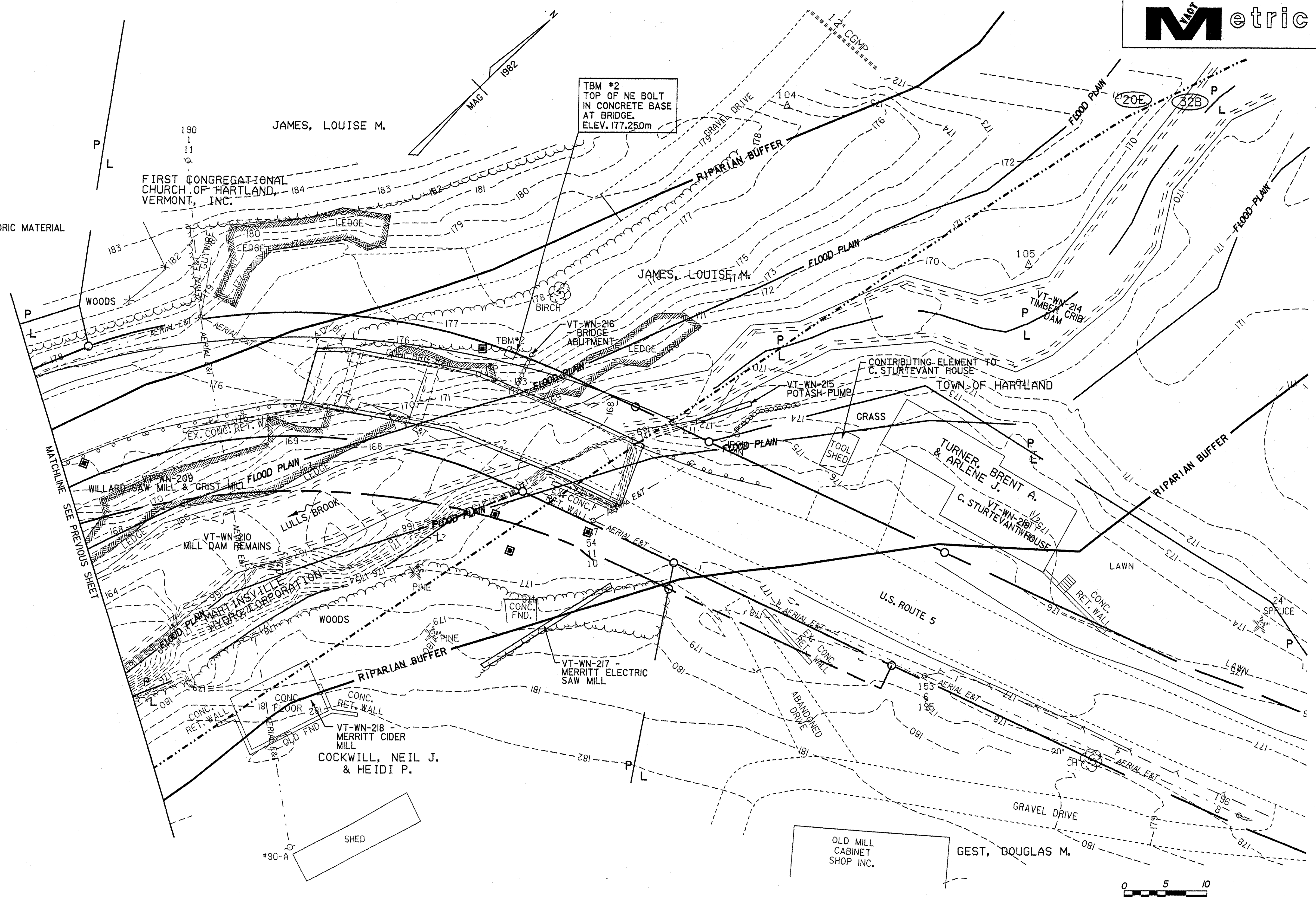

<b>STATE OF VERMONT AGENCY OF TRANSPORTATION</b>			
Town Of	HARTLAND	Bridge No.	60
Highway No.	U.S. ROUTE 5	Log Sta.	
		Surv. Sta.	
U.S. ROUTE 5 OVER LULLS BROOK			
<b>EXISTING CONDITIONS SITE PLAN</b>			
Designed By	A. DUGON	Drawn By	A. DUGON
Checked By	L. DOLPHIN	Bridge Design Supervisor	J. MECZKOWSKI
Date	7 / 04	Date	7 / 04
PROJECT	HARTLAND	PROJECT NO.	BRS No. 0113(22)
I.G.C. Info. M:\145620\VAOT Hartland\z\204ES.EXIST2.dgn			
Bridge Sheet No.		Sheet	27 of 86