

Match Pavement and Shoulders  
To Existing Roadway

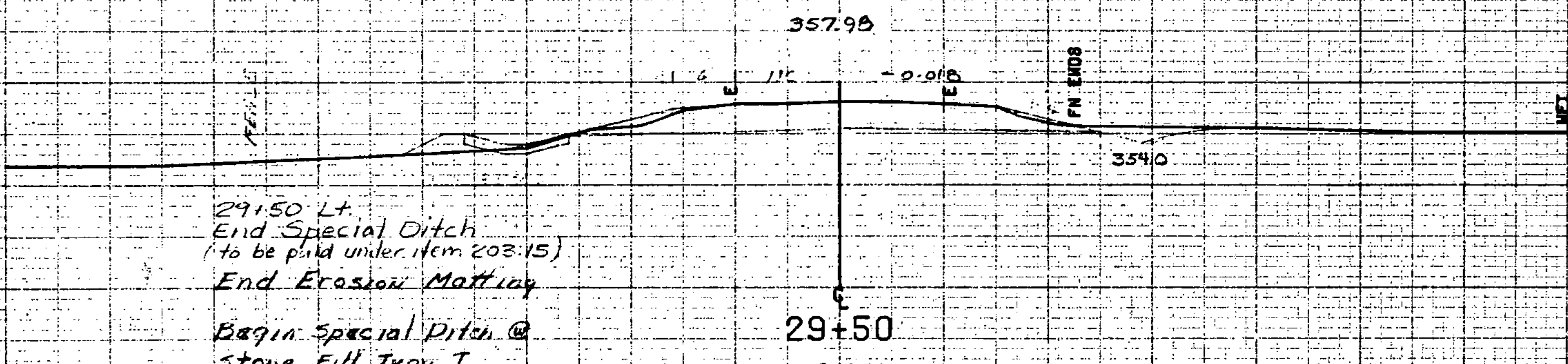

29+50 Lt.  
End Special Ditch  
(to be paid under item 203.15)  
End Erosion Matting

Begin Special Pitch @  
Stone Fill Type I  
(Erosion Matting to be paid for  
Under Item 203.15)

Begin Bituminous Concrete Overlay  
Note: Taper Overlay to Match Existing  
Road Conditions

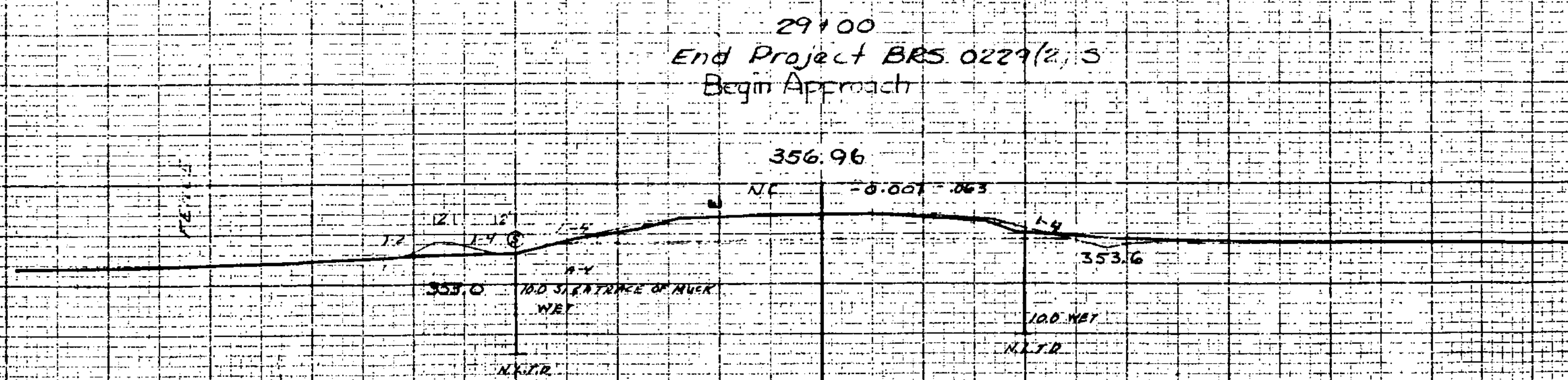

29+00  
End Project BR 0229(2.5)  
Begin Approach

350

350

350

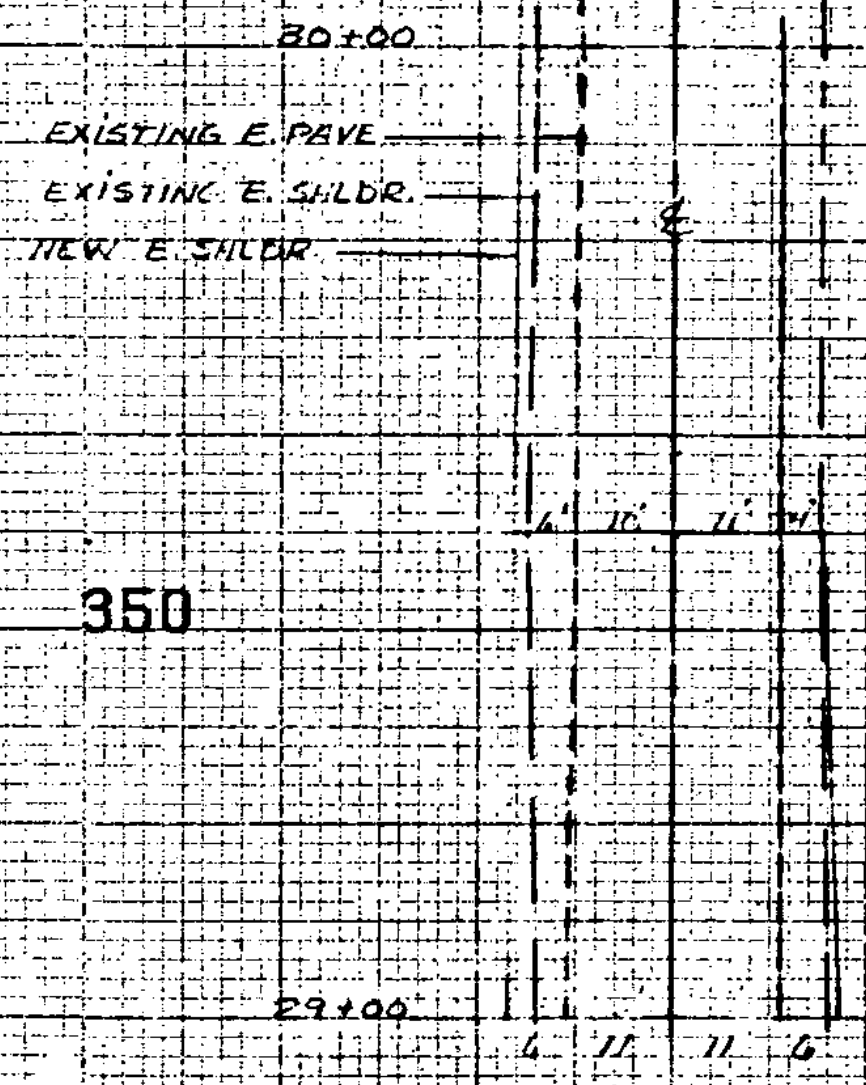

End Approach Detail  
0 20 40  
Scale in Feet

|              |              |             |              |
|--------------|--------------|-------------|--------------|
| FROM STA.    | 29+00        | TO STA.     | 30+00        |
| PROJECT NAME | FAIRFAX MAIN | PLANNED     | CONSTRUCTION |
| NO.          | BR0229(2.5)  | DATE        | 11/15/00     |
| SURVEYED BY  | PAUL         | DESIGNED BY | PAUL         |
| DRAWN BY     | PAUL         | CHECKED BY  | PAUL         |