

PT 27+31.11  
 D 7°30' LT  
 Bank 0.080 #/ft

27+30 LT  
 End Paved Shoulder (6' wide)  
 Begin Paved Shoulder Transition  
 27+23 LT  
 Begin Erosion Matting  
 Begin Special Ditch  
 via 203.15

Section B-B  
 @ Sta 27+10.50 RT  
 Scale 1" = 10' Horiz. & Vert.

27+00 LT (14' wide)  
 Construct Drive  
 New 15" x 44" Optiok Pipe  
 (CGMP 064 or CACP 060)

27+00 RT  
 Construct Drive (14' wide)  
 New 15" x 32" Optiok Pipe  
 (CGMP 064, CACP 060)

26+00 LT  
 End Erosion Matting  
 End Special Ditch via 205.5

26+81 RT  
 End Special Ditch  
 (Item 204.20)  
 End Erosion Matting

26+25 RT  
 End Paved Shoulder (6' wide)  
 Begin Paved Shoulder Transition

Section A-A  
 @ Sta 27+00.24 LT  
 Scale 1" = 10' Horiz. & Vert.

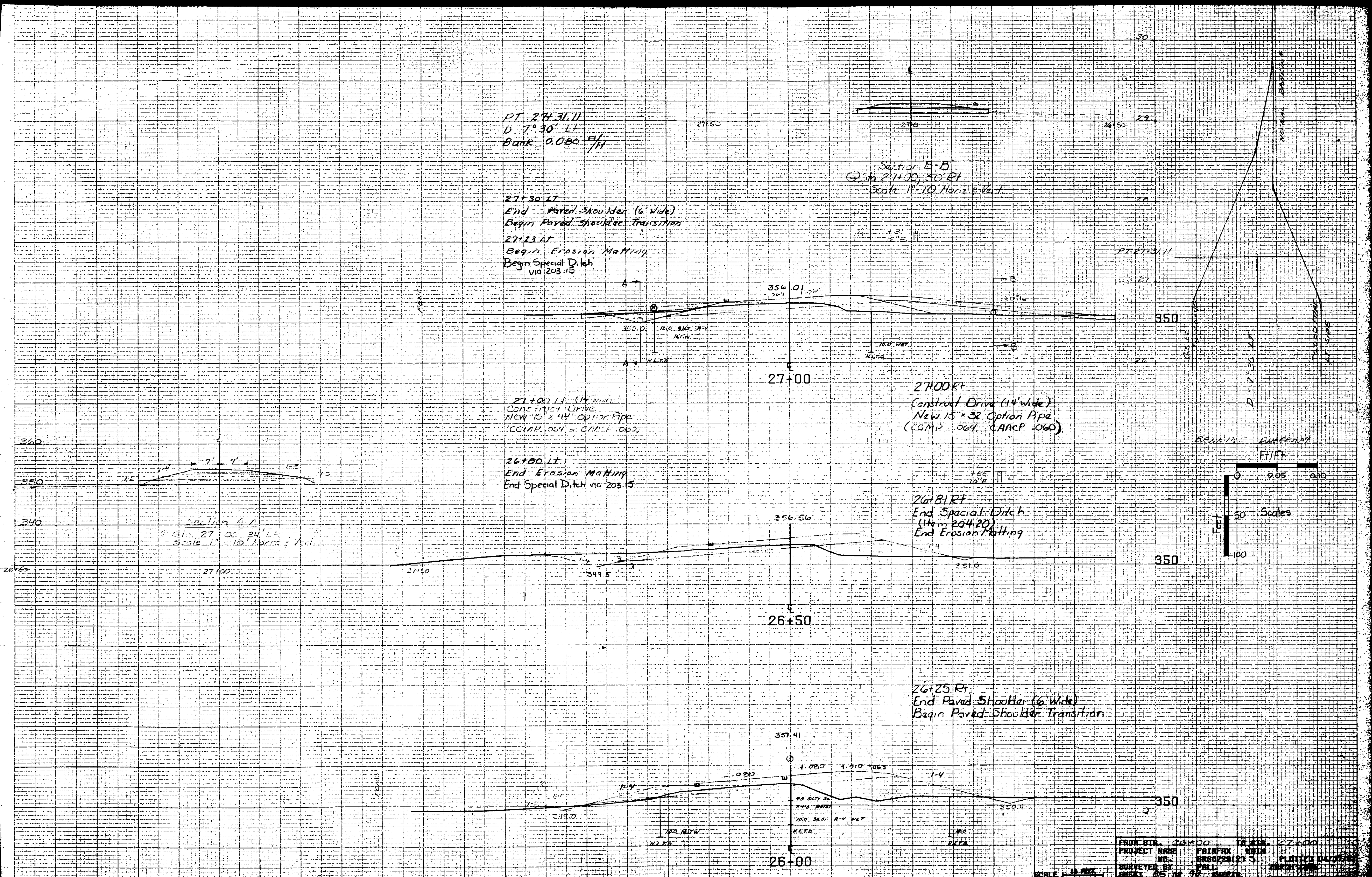
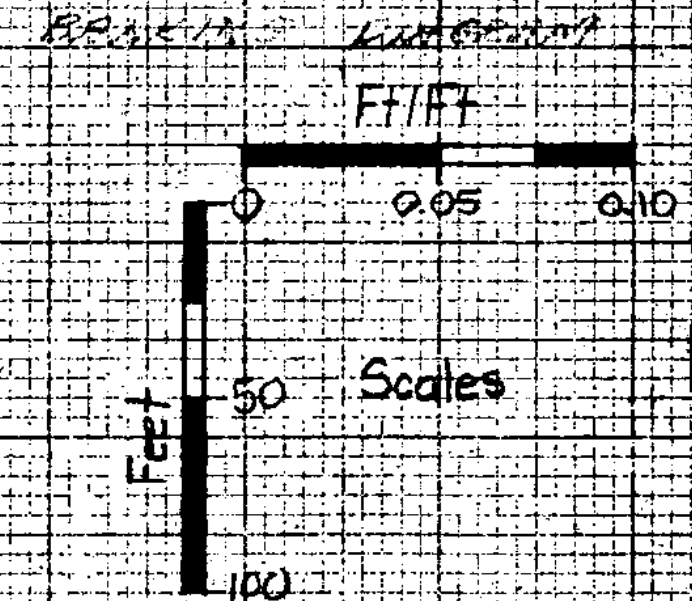

FROM STA. 26+00	TO STA. 27+00
PROJECT NAME	FAIRFAX HIGHWAY
NO.	880220123 S
SURVEYED BY	FALL
DATE	92