

Construct Special Ditch
(Excavation To Be Paid Under Item 204.20)
24+75 R2 ~ 26+00 R2.

**THIS SHEET TO BE USED
FOR ROW INFORMATION ONLY**

CHAMBERLAIN, RICHARD J. & MARYANNE T.
d/k/a MARIANNE

BOISSONEAULT, RENE P & BARBARA A.

Guard Rail, Standard Steel Beam
w/ Wood Posts, Type II
22+87.5 Lt ~ 23+37.5 Lt
22+40.5 Pt ~ 23+28 Pt
25+14 Lt ~ 25+89 Lt
25+04.5 Rt ~ 25+79.5 Rt

MAHALICK, ALBERT I. & AUGUSTE E.

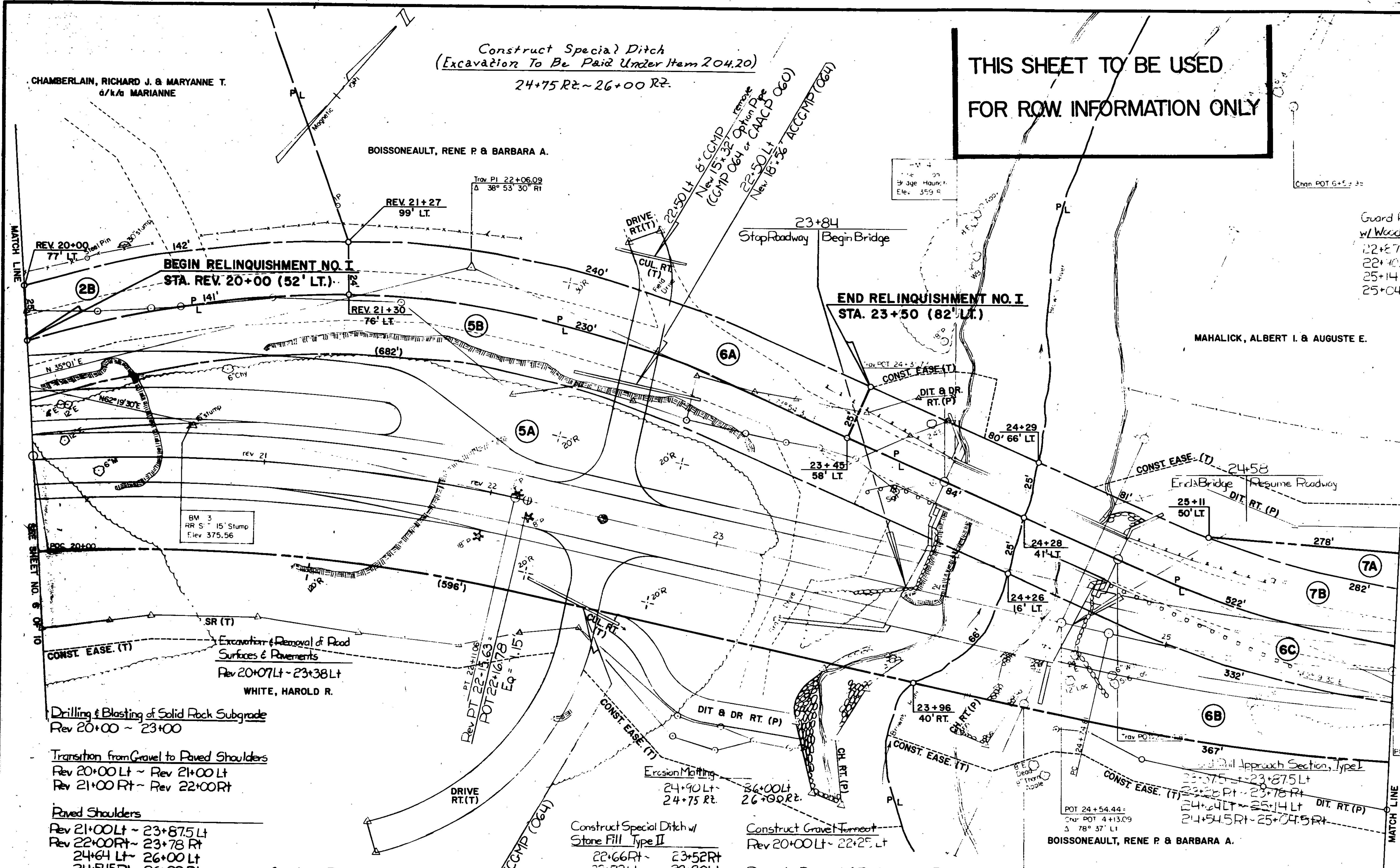

DATUM

VERTICAL	Assumed
HORIZONTAL	N/A

Construct Drive
22+50 Lt
22+50 Rt

Construct Special Ditch w/
Stone Fill Type II
22+66 Rt ~ 23+52 Rt
22+72 Lt ~ 23+90 Lt

Construct Special Ditch (to be
paid under item 20315)
24+90 Lt ~ 26+00 Lt

Construct Gravel Turnout
Rev 20+00 Lt ~ 22+25 Lt

Removal & Disposal of Existing Guard Rail
23+31 Lt ~ 23+94 Lt 25+53 Rt ~ 25+56 Rt
23+58 Lt ~ 23+88 Lt
24+69 Lt ~ 25+53 Lt
24+73 Lt ~ 25+40 Lt

SEE SHEET NO. 8 OF 10

SURVEYED BY	DATE
DRAWN BY	DATE
TRACED BY	DATE
FAIRFAX	
PROJ. BRS	NO. 0229 (2) 5
SHEET 12 OF 98	