

Bench Mark #1
 I+028, 6m Lt.
 Spike in Root
 Elev. 208.550

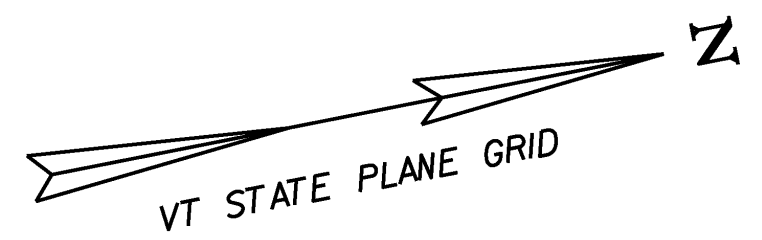

VT14 CURVE #1
 $\Delta = 35^\circ 21' 49.48''$
 $R = 170.000\text{m}$
 $T = 54.195\text{m}$
 $L = 104.926\text{m}$
 $E = 8.429\text{m}$

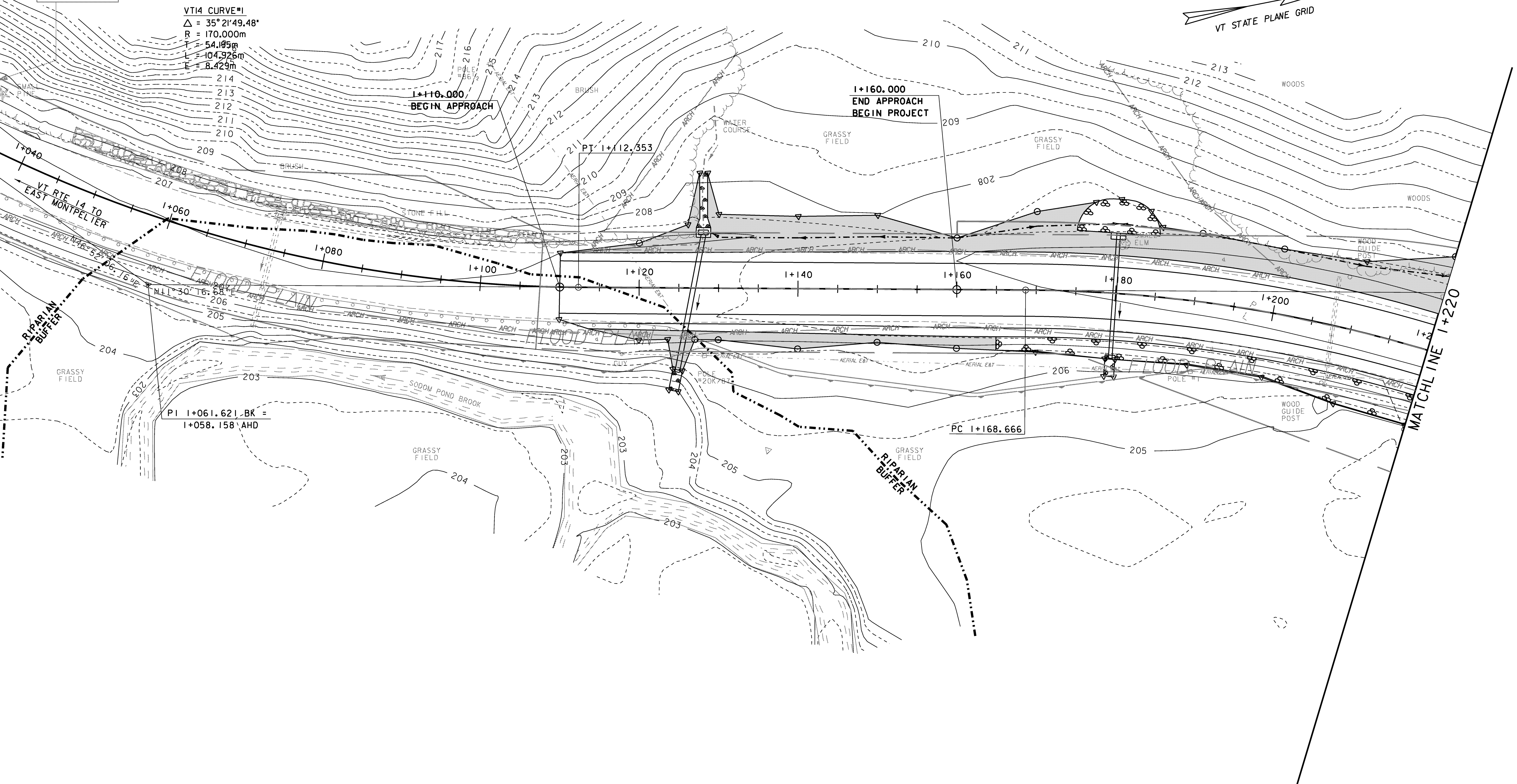

THE FINAL CONDITIONS SITE PLANS REFLECT FINAL GROUND CONTOURS. THE GRAY SHADED AREAS DEPICT DISTURBED AREAS WHERE SEEDING & MUCHING WILL HAVE BEEN APPLIED.



EPSC FINAL CONDITIONS SITE PLAN #1

PROJECT NAME: EAST MONTPELIER	PLOT DATE: 14-JUL-2009
PROJECT NUMBER: STP 037-2(9)	DRAWN BY: J. SALVATORI
FILE NAME: 78f200\str\srf200ecbdr.dgn	CHECKED BY: J. LACROIX
PROJECT LEADER: K. HIGGINS	SHEET 51 OF 67
DESIGNED BY: J. SALVATORI	
sf200epsc_fin1.i	