

SIGN LEGEND

R&S = REMOVE AND SALVAGE

SIGN POSTS
SQUARE STEEL
44 mm, 3.4 kg/m
W/ ANCHOR

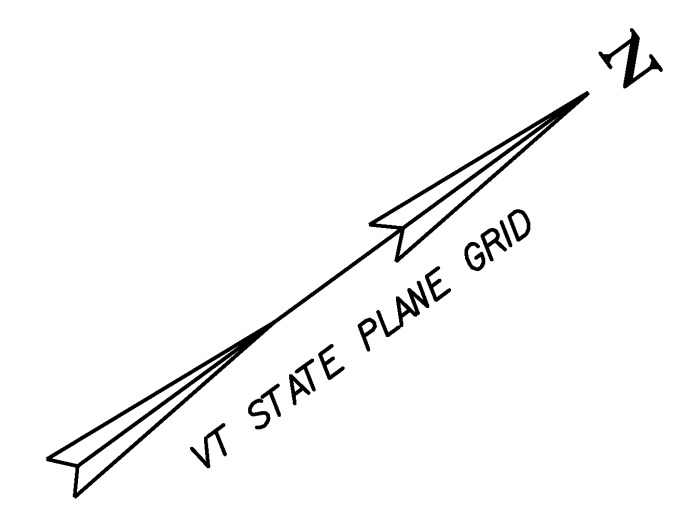

REMOVING & RESETTING PROPERTY MARKERS

PIN #1 - from I+269.96 to I+268.76 LT.
PIN #2 - from I+279.47 to I+279.73 RT.

STATION	I+268.76	I+279.73
OFFSET	3.93M LT.	11.6M RT.
NORTHING	197393.57	197383.59
EASTING	501628.44	501652.96

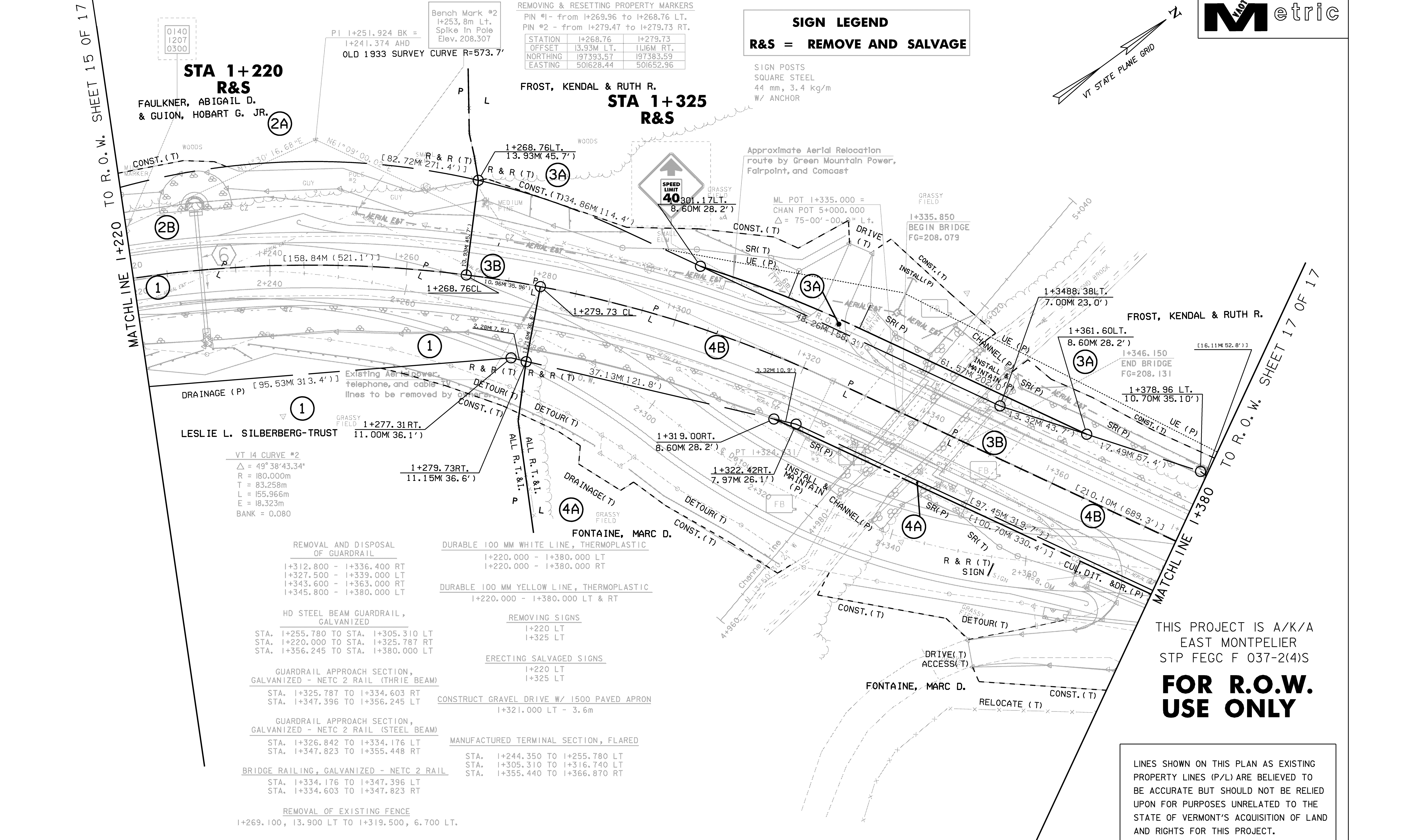

STA 1+220 R&S
FAULKNER, ABIGAIL D. & GUION, HOBART G. JR.

STA 1+325 R&S
FROST, KENDAL & RUTH R.

VT I4 CURVE #2
Δ = 49° 38' 43.34"
R = 180.000m
T = 83.258m
L = 155.966m
E = 18.323m
BANK = 0.080

REMOVAL AND DISPOSAL OF GUARDRAIL

I+312.800 - I+316.400 RT
I+327.500 - I+339.000 LT
I+343.600 - I+363.000 RT
I+345.800 - I+380.000 LT

HD STEEL BEAM GUARDRAIL, GALVANIZED

STA. I+255.780 TO STA. I+305.310 LT
STA. I+220.000 TO STA. I+325.787 RT
STA. I+356.245 TO STA. I+380.000 LT

GUARDRAIL APPROACH SECTION, GALVANIZED - NETC 2 RAIL (THRIE BEAM)

STA. I+325.787 TO I+334.603 RT
STA. I+347.396 TO I+356.245 LT

GUARDRAIL APPROACH SECTION, GALVANIZED - NETC 2 RAIL (STEEL BEAM)

STA. I+326.842 TO I+334.176 LT
STA. I+347.823 TO I+355.448 RT

BRIDGE RAILING, GALVANIZED - NETC 2 RAIL

STA. I+334.176 TO I+347.396 LT
STA. I+334.603 TO I+347.823 RT

REMOVAL OF EXISTING FENCE

I+269.100, 13.900 LT TO I+319.500, 6.700 LT.
--

DURABLE 100 MM WHITE LINE, THERMOPLASTIC

I+220.000 - I+380.000 LT
I+220.000 - I+380.000 RT

DURABLE 100 MM YELLOW LINE, THERMOPLASTIC

I+220.000 - I+380.000 LT & RT

REMOVING SIGNS

I+220 LT
I+325 LT

ERECTING SALVAGED SIGNS

I+220 LT
I+325 LT

CONSTRUCT GRAVEL DRIVE W/ 1500 PAVED APRON

I+321.000 LT - 3.6m

MANUFACTURED TERMINAL SECTION, FLARED

STA. I+244.350 TO I+255.780 LT
STA. I+305.310 TO I+316.740 LT
STA. I+355.440 TO I+366.870 RT

NOTE: THERE IS A SIGN PROJECT CURRENTLY UNDER CONSTRUCTION THAT MAY CHANGE THE TYPE/LOCATION OF SIGNS. EACH SIGN SHALL BE REMOVED, SALVAGED, AND ERECTED AS CLOSE TO ITS EXISTING LOCATION AS POSSIBLE.

6 STA I+230.0 LT. - RT.
NEW 450 x 18M OPTION PIPE W/ NEW CONCRETE HEADWALL @ INLET
NEW INLET DITCH W/ STONE FILL, TYPE I
NEW 1.0 X 2.0 STONE PAD @ OUTLET - STONE FILL, TYPE I

EROSION CONTROL DETAIL ON R.O.W. SHEET II OF 17



THIS PROJECT IS A/K/A EAST MONTPELIER STP FEGC F 037-2(4)S

FOR R.O.W. USE ONLY

LINES SHOWN ON THIS PLAN AS EXISTING PROPERTY LINES (P/L) ARE BELIEVED TO BE ACCURATE BUT SHOULD NOT BE RELIED UPON FOR PURPOSES UNRELATED TO THE STATE OF VERMONT'S ACQUISITION OF LAND AND RIGHTS FOR THIS PROJECT.

LAYOUT SHEET #2

PROJECT NAME: EAST MONTPELIER	PLOT DATE: 14-JUL-2009
PROJECT NUMBER: STP 037-2(9)	DRAWN BY: R. PELLETT
FILE NAME: 78f200\str\sf200bdr.dgn	CHECKED BY: J. LACROIX
PROJECT LEADER: K. HIGGINS	SHEET 42 OF 67
DESIGNED BY: J. LACROIX	
R.O.W. SHEET 16 OF 17	