

STA 1+445 LT
R&S

1+420,000
END PROJECT
BEGIN APPROACH

1+470,000
END APPROACH

Approximate Aerial Relocation
route by Green Mountain Power,
Fairpoint, and Comcast

TOP
208.670

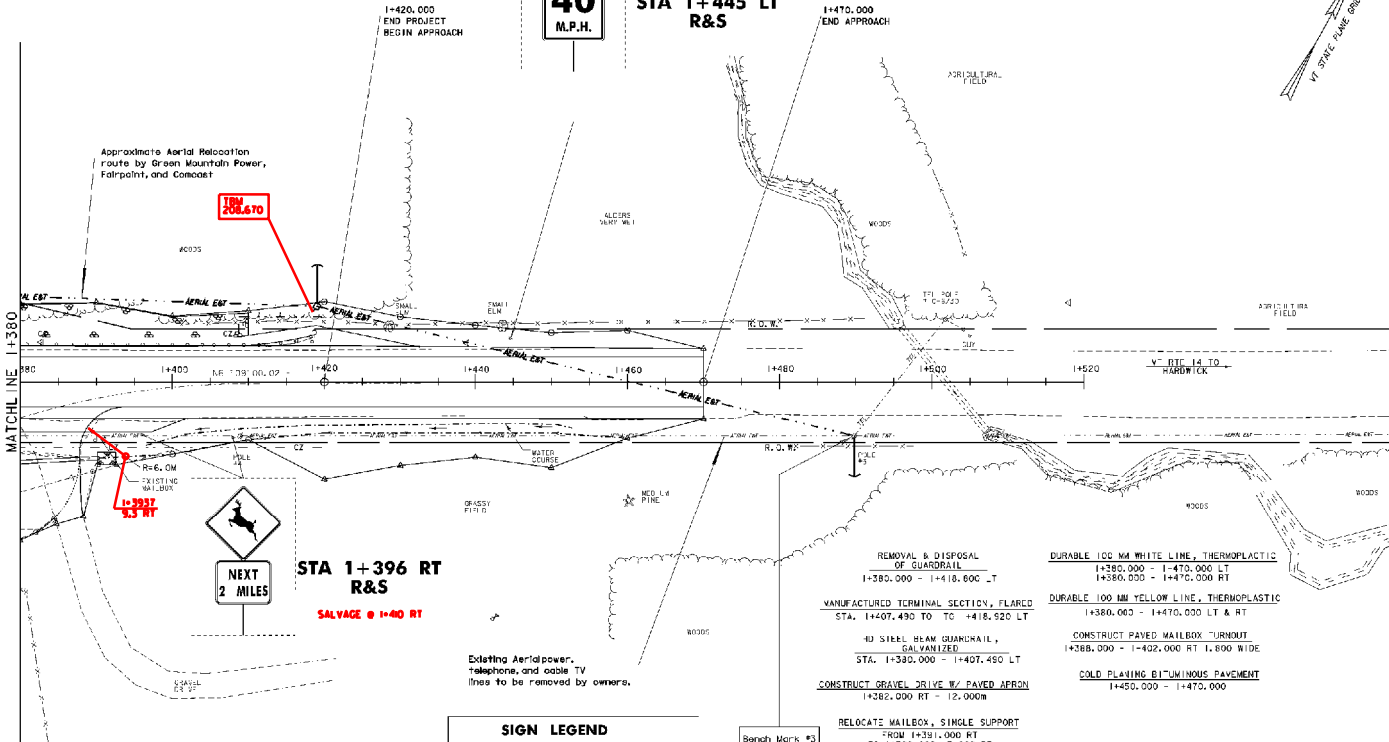

MATCHLINE 1+380

R=6.0M
EXISTING
1+3937
9.3 RT



STA 1+396 RT
R&S

SALVAGE @ 1+40 RT

Erecting Aerialpower,
Telephone, and cable TV
lines to be removed by owners.

- REMOVAL & DISPOSAL OF GUARDRAIL
1+380,000 - 1+418,600 LT
- MANUFACTURED TERMINAL SECTION, FLARED
STA. 1+407,490 TO TO 1+418,520 LT
- 40 STEEL BEAM GUARDRAIL, GALVANIZED
STA. 1+380,000 - 1+407,450 LT
- CONSTRUCT GRAVEL DRIVE BY PAVED APRON
1+382,000 RT - 12,000m
- RELOCATE MAILBOX, SINGLE SUPPORT
FROM 1+331,000 RT
TO 1+330,000 + 1,000 RT
- REMOVAL OF EXISTING FENCE
1+400,000 TO 1+470,000 LT
- REMOVING SIGNS
1+445 LT (2)
1+396 RT (2)
- ERECTING SALVAGED SIGNS
1+445 LT (2)
1+396 RT (2)
- DURABLE 100 MM WHITE LINE, THERMOPLASTIC
1+380,000 - 1+470,000 LT
1+380,000 - 1+470,000 RT
- DURABLE 100 MM YELLOW LINE, THERMOPLASTIC
1+380,000 - 1+470,000 LT & RT
1+388,000 - 1+402,000 RT 1,800 WIDE
- CONSTRUCT PAVED MAILBOX TURNOUT
1+388,000 - 1+402,000 RT 1,800 WIDE
- COLD PLACING BITUMINOUS PAVEMENT
1+450,000 - 1+470,000

SIGN LEGEND
R&S = REMOVE AND SALVAGE

SIGN POSTS
SQUARE STEEL
50 mm, 3.8 Kg/m
/ ANCHOR

Barack Mark #3
+450, Top L1,
Strike In Pole
Elev. 2+696
2+657

NOTE: THERE IS A SIGN PROJECT CURRENTLY UNDER CONSTRUCTION THAT MAY CHANGE THE TYPE/LOCATION OF SIGNS. EACH SIGN SHALL BE REMOVED, SALVAGED, AND ERECTED AS CLOSE TO ITS EXISTING LOCATION AS POSSIBLE.

LAYOUT SHEET #3

PROJECT NAME: EAST MONTEPELIER
PROJECT NUMBER: STP 037-2(9)

FILE NAME: 78F200W1+V8F200W8.dgn
PLOT DATE: 14-JUL-2009

PROJECT LEADER: K. HIGGINS
DRAWN BY: R. PELLETT

DESIGNED BY: J. LACROIX
CHECKED BY: J. LACROIX

SHEET 13 OF 97

