

LEGEND

- SIGN AND POSTS
- TYPE III BARRICADES
- TYPE III BARRICADES (MOD.)
- REFLECTORIZED DRUM
- TEMP. TRAFFIC BARRIER
- INDICATES TRAFFIC DIRECTION

- NOTES:
1. RESIDENT ENGINEER, COORDINATE THE SIGN LAYOUT WITH VTRANS TRAFFIC OPERATIONS
 2. SEE ITEM 641.10 "TRAFFIC CONTROL".
 3. SEE ITEM 528.11 "TWO-WAY TEMPORARY BRIDGE".
 4. SEE STD E-100 "CONSTRUCTION APPROACH SIGNS".
 5. SEE STD E-107 "DELINEATION, BARRICADES & DETOURS FOR CONSTRUCTION AREAS"

VT STATE PLANE GRID

PLACE ON
VT4A &
CASTLETON STATE HIGHWAY
(INTERSECTION AT
APPROX. ML 391+60)

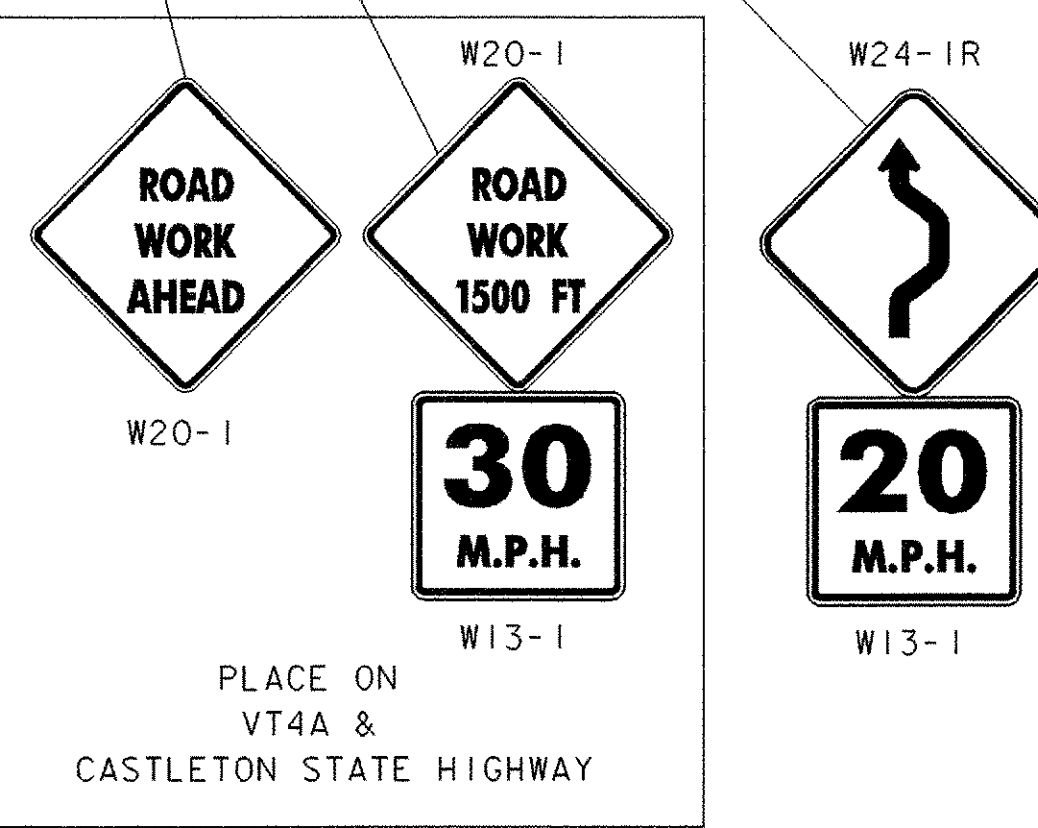
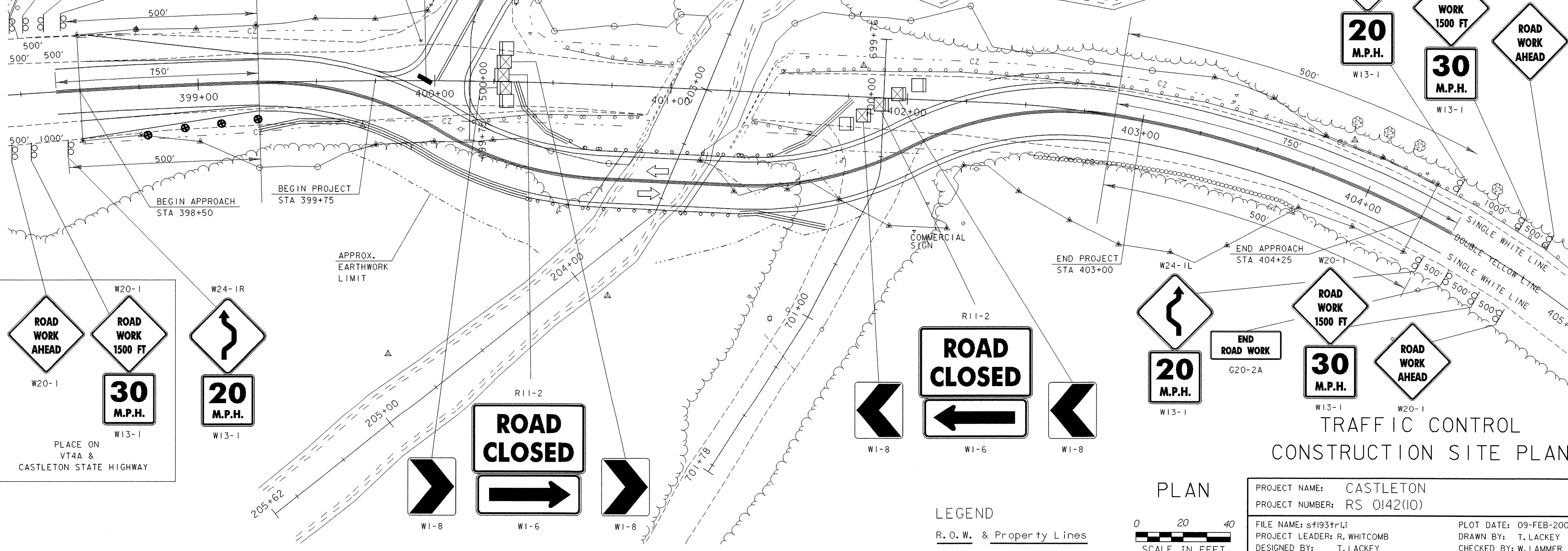
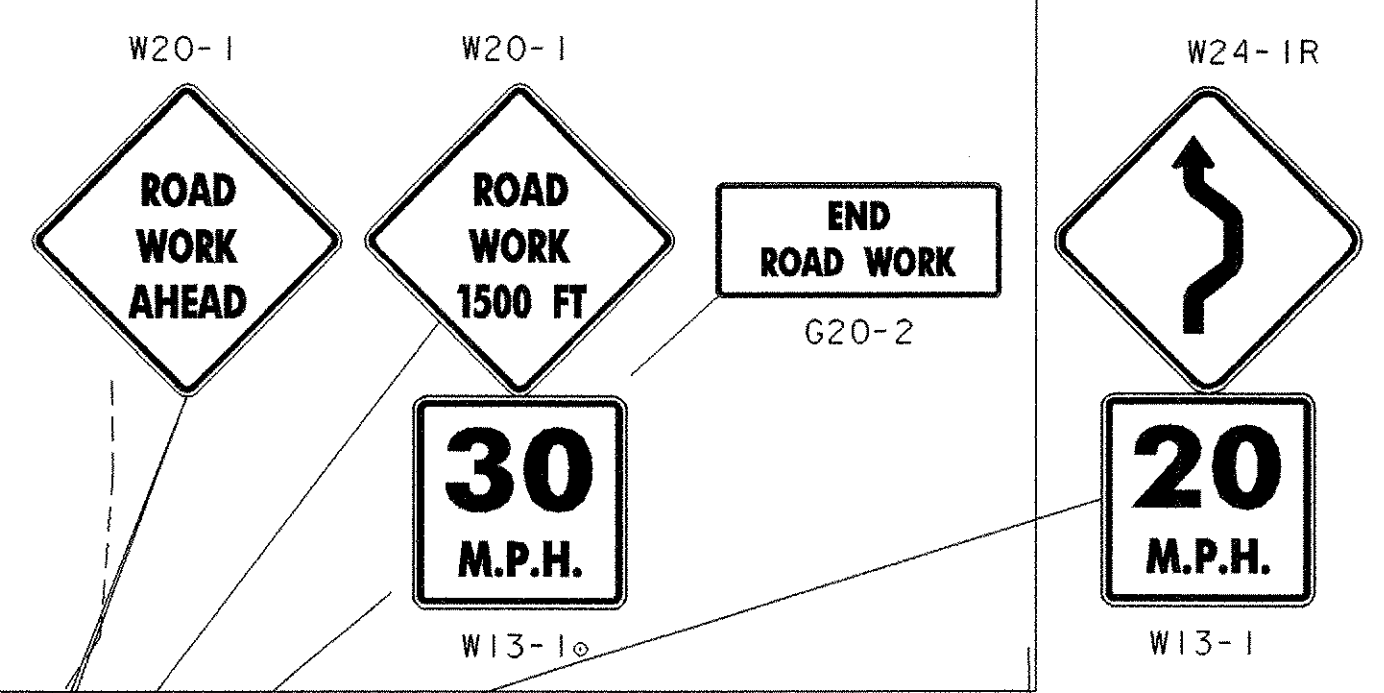

LEGEND

R.O.W. & Property Lines

PLAN

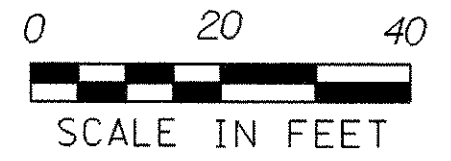

TRAFFIC CONTROL
CONSTRUCTION SITE PLAN

PROJECT NAME: CASTLETON	PLOT DATE: 09-FEB-2007
PROJECT NUMBER: RS 0142(10)	DRAWN BY: T. LACKEY
FILE NAME: sf193tr1.i	CHECKED BY: W. LAMMER
PROJECT LEADER: R. WHITCOMB	SHEET 34 OF 68
DESIGNED BY: T. LACKEY	
78f193/structures/sf193trf.dgn	