

CHANNEL BLOCK AT STA. 23+25

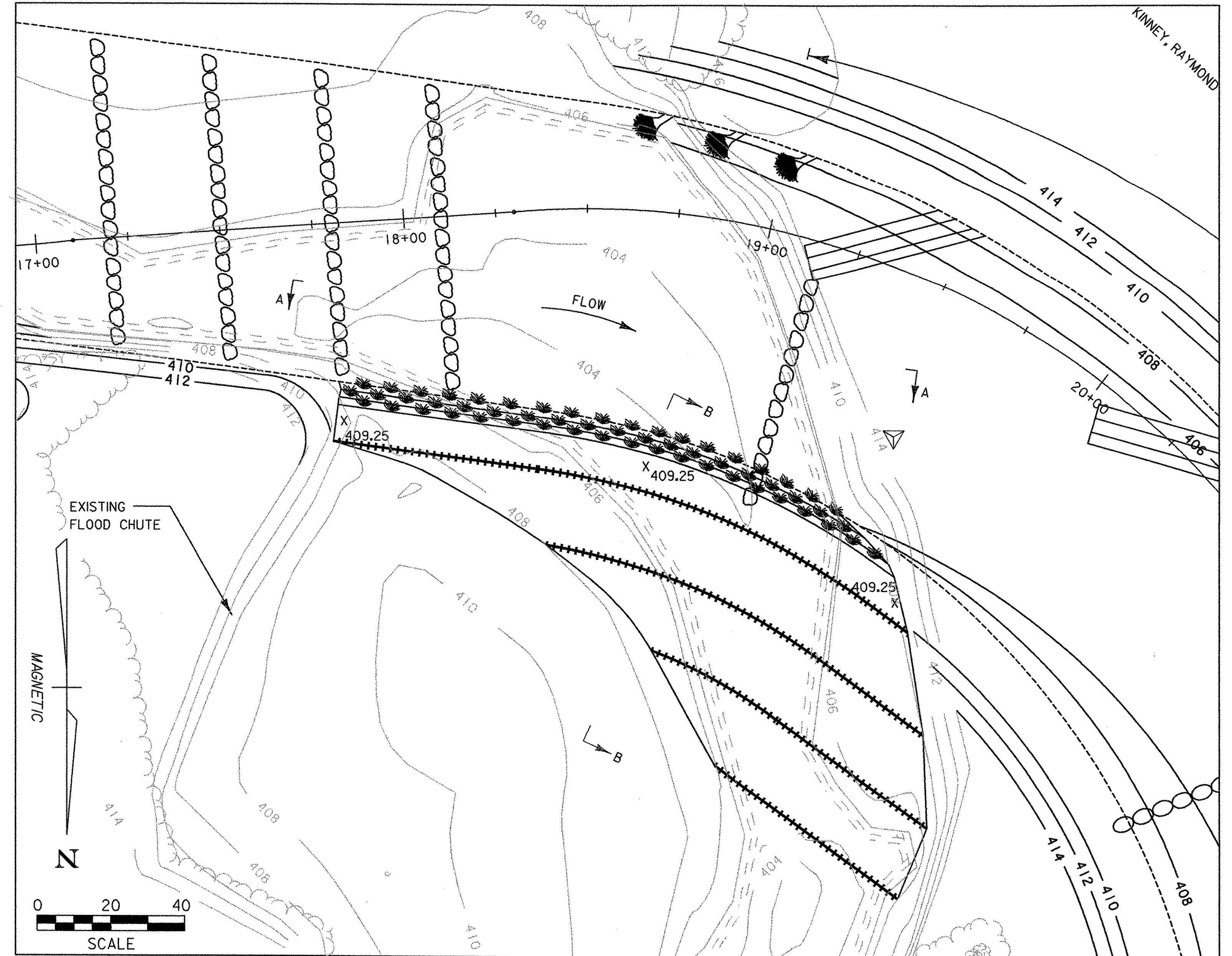

CHANNEL BLOCK AT STA. 18+50

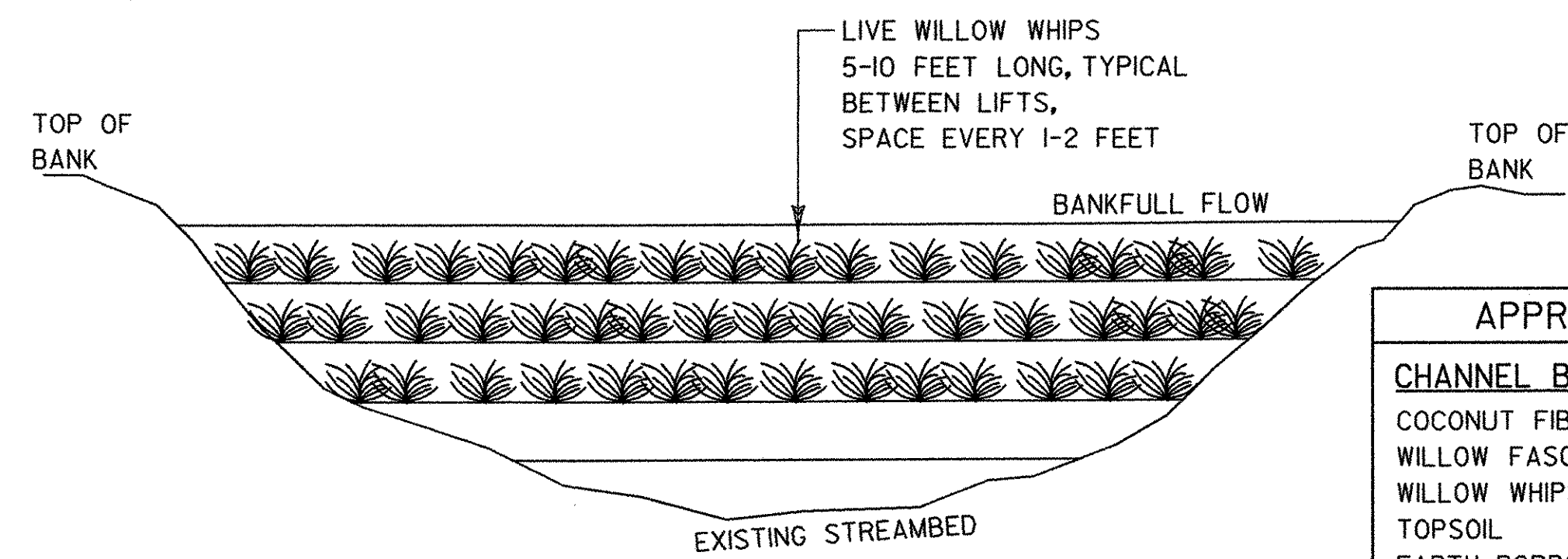

SECTION A-A

APPROXIMATE QUANTITIES	
CHANNEL BLOCK AT STA. 23+25	
COCONUT FIBER FABRIC	520 SY
WILLOW FASCINES	220 LF
WILLOW WHIPS	210 EA
TOPSOIL	40 CY
EARTH BORROW	450 CY
CHANNEL BLOCK AT STA. 18+50	
COCONUT FIBER FABRIC	1190 SY
WILLOW FASCINES	430 LF
WILLOW WHIPS	480 EA
TOPSOIL	82 CY
EARTH BORROW	920 CY

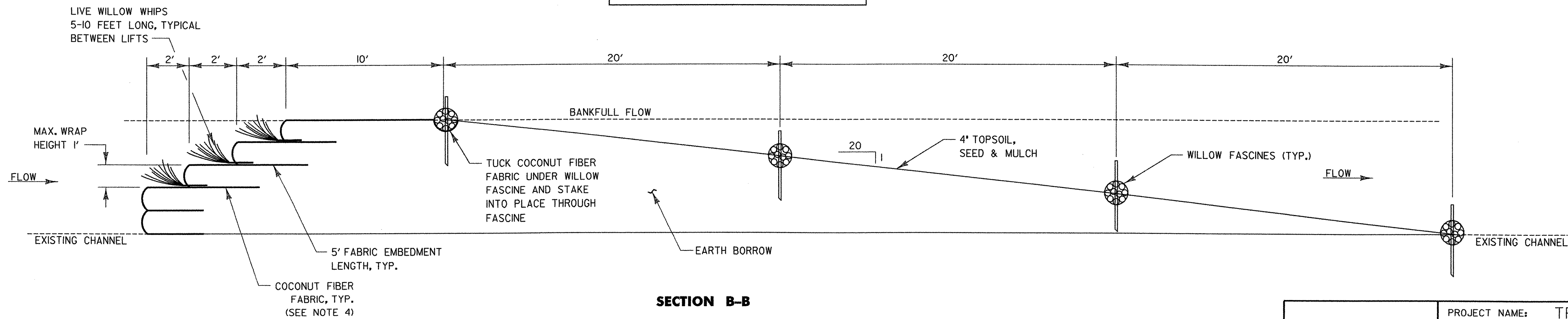

SECTION B-B

CHANNEL BLOCK
N.T.S.

- NOTES:
1. FOR BANKFULL WIDTH AND OTHER DESIGN CRITERIA, SEE TITLE SHEET.
 2. FOR DESIGN BANKFULL ELEVATIONS SEE, PROFILE SHEETS.
 3. FOR LOCATIONS OF STRUCTURES, SEE PLAN SHEETS.
 4. COCONUT FIBER FABRIC SHALL BE ROLANKA BIO D-MAT 90, OR APPROVED EQUAL.



PROJECT NAME: TROUT RIVER RESTORATION
 PROJECT NUMBER: BRF-RS 0283(7)
 FILE NAME: zo2837ch1bk.dgn
 PROJECT LEADER: GAE
 DESIGNED BY: SAR
 MISC. DETAIL SHEET 5

PLOT DATE: 06/06/2003
 DRAWN BY: MBL
 CHECKED BY: WCH
 SHEET 121 OF 140