

STATE OF VERMONT AGENCY OF TRANSPORTATION

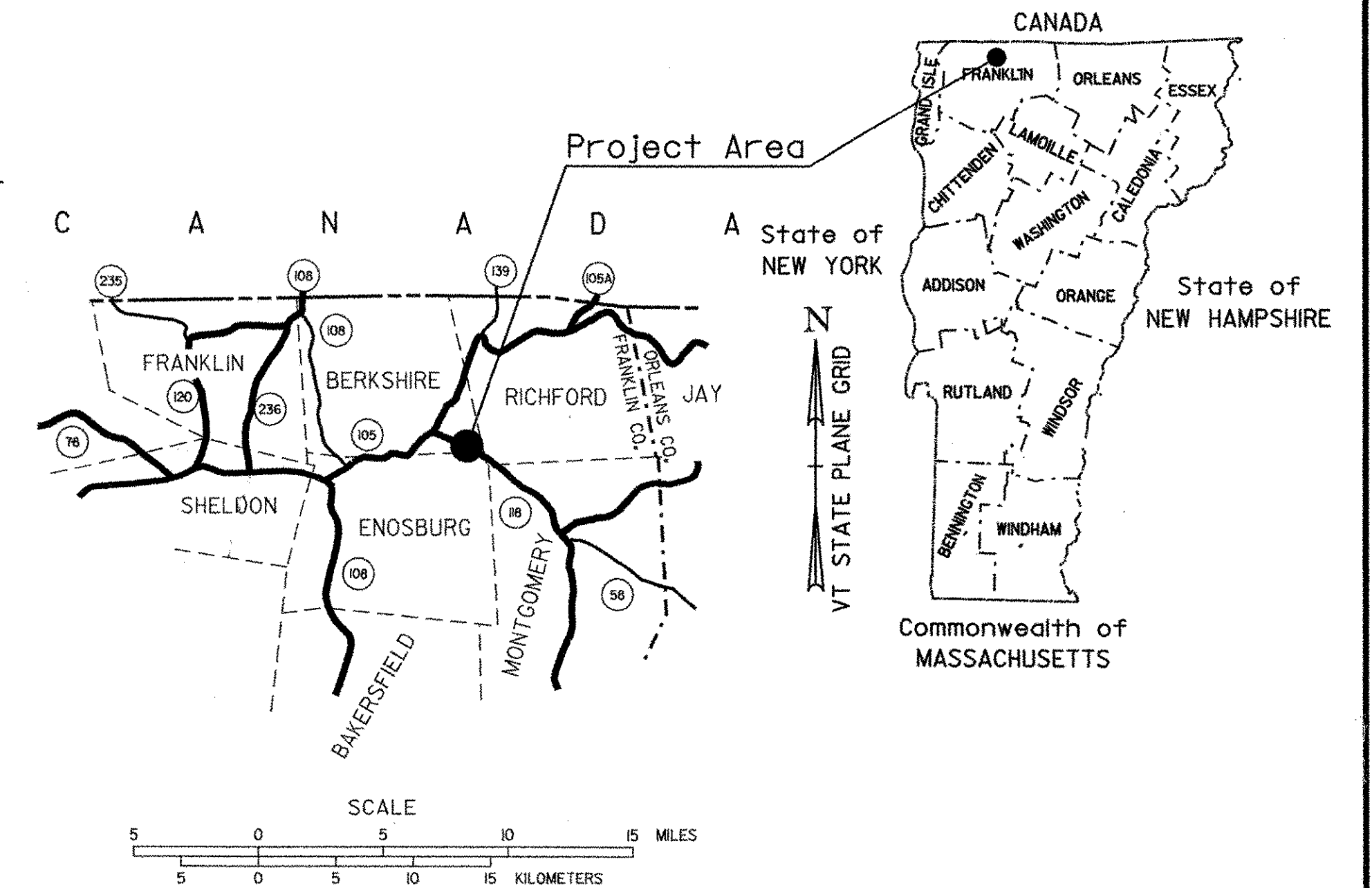

PROPOSED IMPROVEMENT TOWN OF BERKSHIRE COUNTY OF FRANKLIN VERMONT ROUTE 118 (F.A.S.)



INDEX OF SHEETS

1. MASTER TITLE SHEET
2. INDEX OF SHEETS

BEGINNING AT A POINT APPROXIMATELY 1142.90 METERS WEST OF THE ENOSBURG-BERKSHIRE TOWN LINE AND EXTENDING EASTERLY 397.47 METERS

WORK TO BE PERFORMED UNDER THIS PROJECT INCLUDES REPLACEMENT OF BRIDGE # 26 OVER THE TROUT RIVER AND NECESSARY ROADWAY APPROACHES INCLUDING A NEW INTERSECTION FOR ACCESS TO T.H. #42

LENGTH OF STRUCTURE 45.40 METERS
LENGTH OF ROADWAY 352.07 METERS
LENGTH OF PROJECT 397.47 METERS

BEGINNING AT A POINT APPROXIMATELY 350 FEET DOWNSTREAM OF EXISTING BRIDGE #26 AND EXTENDING UPSTREAM 3190 FEET.

WORK TO BE PERFORMED UNDER THE RIVER RESTORATION PORTION OF THIS PROJECT INCLUDES STABILIZATION OF THE TROUT RIVER AND ESTABLISHMENT OF A RIPARIAN BUFFER ZONE.

LENGTH OF RIVER RESTORATION PROJECT 3190 FEET

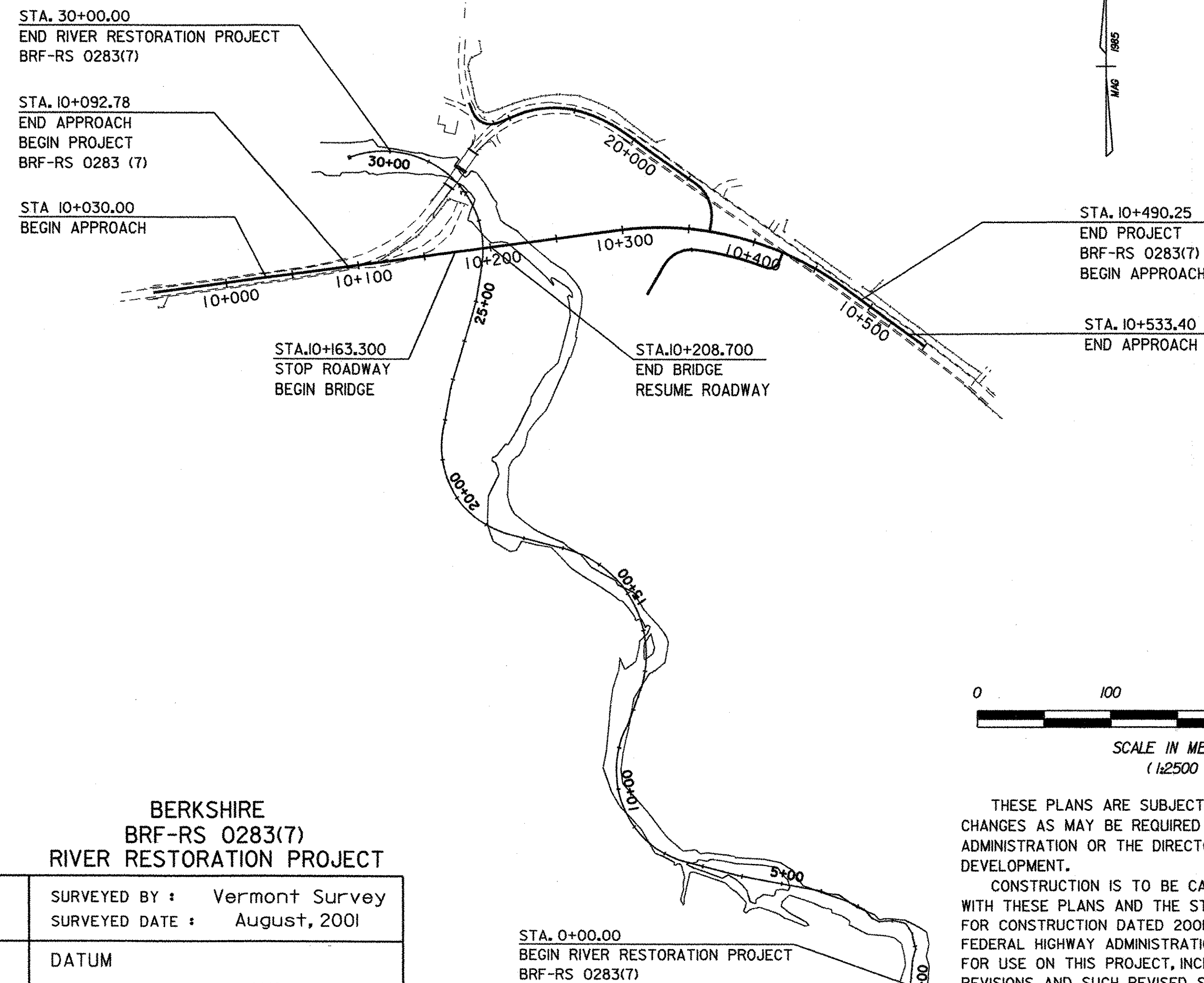

TRAFFIC DATA	
1997 ADT = 1760	2017 ADT = 2390
DHV = 245	DHV = 335
ADTT = 130	ADTT = 150
% T = 5	% T = 5
% D = 56 V = 80 km/h	
1997-2017(20YR) 18 K ESAL = 1,759,000	
FUNCTIONAL CLASSIFICATION : MAJOR COLLECTOR	

RECORD PLANS	
CONTRACTOR:	A.L. STONGE CONTRACTOR, INC. - MONTGOMERY, VT
RESIDENT ENGINEER:	RAY HAYES
CONSTRUCTION BEGAN:	MAY 3, 2004
CONSTRUCTION COMPLETE:	NOVEMBER 2, 2005
RECORD PLANS BY:	RAY HAYES & N. GARBACIK

I HEREBY CERTIFY THAT ALL THE CONSTRUCTION REQUIRED BY THIS SET OF DRAWINGS HAS BEEN ACCOMPLISHED AS INDICATED HEREIN.
BY *Raymond W. Hayes* RESIDENT ENGINEER
DATE 03-08-07

NOTE: Any further information concerning final quantities, amounts or other details relative to this project may be found at Central Files in the electronic archives.



UNLESS NOTED OTHERWISE
STATIONS ARE IN KILOMETERS
ELEVATIONS ARE IN METERS
DIMENSIONS ARE IN MILLIMETERS

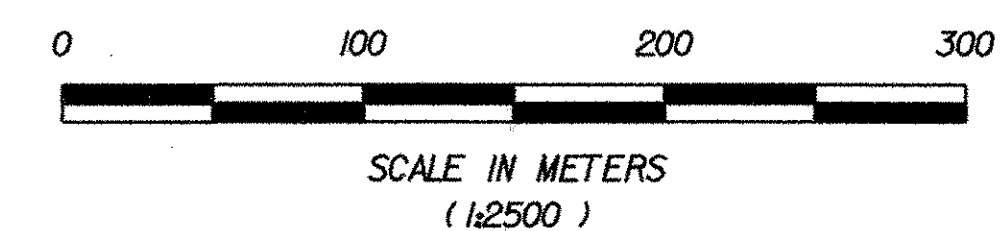

THESE PLANS ARE SUBJECT TO SUCH ENGINEERING CHANGES AS MAY BE REQUIRED BY THE FEDERAL HIGHWAY ADMINISTRATION OR THE DIRECTOR OF PROGRAM DEVELOPMENT.

CONSTRUCTION IS TO BE CARRIED ON IN ACCORDANCE WITH THESE PLANS AND THE STANDARD SPECIFICATIONS FOR CONSTRUCTION DATED 2001, AS APPROVED BY THE FEDERAL HIGHWAY ADMINISTRATION ON JANUARY 4, 2001 FOR USE ON THIS PROJECT, INCLUDING ALL SUBSEQUENT REVISIONS AND SUCH REVISED SPECIFICATIONS AND SPECIAL PROVISIONS AS ARE INCORPORATED IN THESE PLANS.

CONVENTIONAL SYMBOLS	
COUNTY LINE	
TOWN LINE	
LIMITS OF ACCESS	
POINT OF ACCESS	
FENCE LINE	
STONE WALL	
TRAVELED WAY	
GUARD RAIL	
RAILROAD	
SURVEY LINE	
CULVERT	
POWER POLE	
TELEPHONE POLE	
TREES	
CONTROL OF ACCESS	
PROPERTY LINE	
R.O.W. TAKING LINE	
SLOPE RIGHTS	
TOP OF CUT	
TOE OF SLOPE	

BERKSHIRE BRF-RS 0283(7) BRIDGE PROJECT		BERKSHIRE BRF-RS 0283(7) RIVER RESTORATION PROJECT	
SURVEYED BY :	R. Hayes	SURVEYED BY :	Vermont Survey
SURVEYED DATE :	1985	SURVEYED DATE :	August, 2001
DATUM		DATUM	
VERTICAL	NGVD 1929	VERTICAL	NAVD 88
HORIZONTAL	N/A	HORIZONTAL	NAD83 (1992)

DIRECTOR OF PROGRAM DEVELOPMENT	
APPROVED <i>[Signature]</i>	DATE 9/18/03
PROJECT MANAGER :	
PROJECT NAME :	BERKSHIRE
PROJECT NUMBER :	BRF-RS 0283(7)
SHEET 1 OF 140 SHEETS	