

PIER HEAD

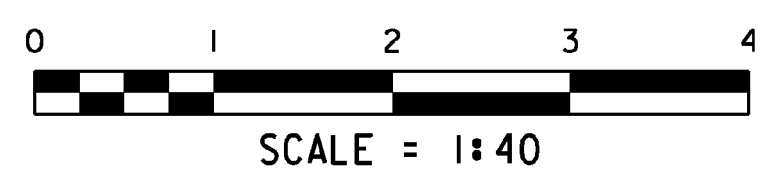

PIER #1 SEAT ELEVATIONS CHANGED VIA W.O. #35

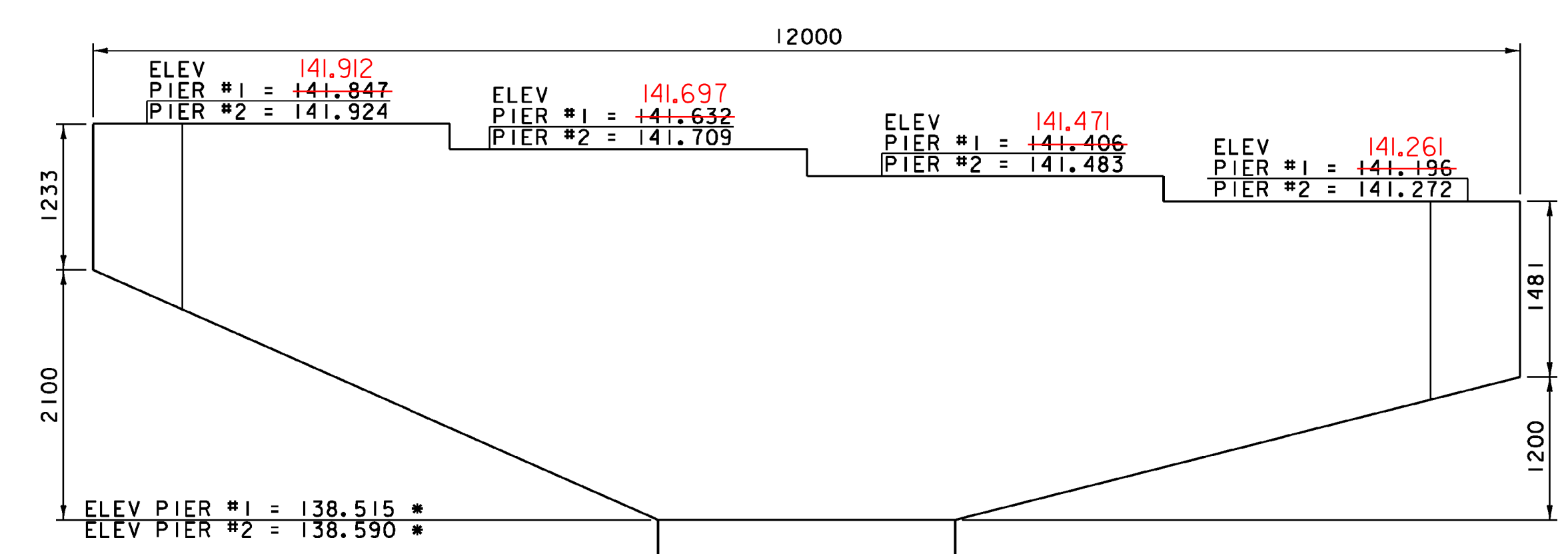

PIER ELEVATION

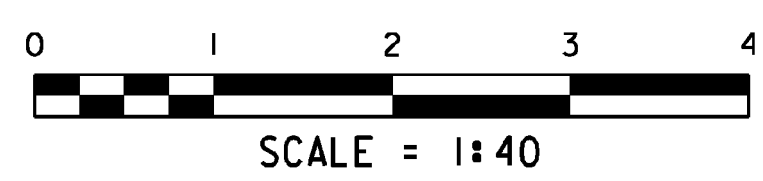

* ALL CONCRETE ABOVE THIS ELEVATION WILL BE CONCRETE, HIGH PERFORMANCE CLASS A

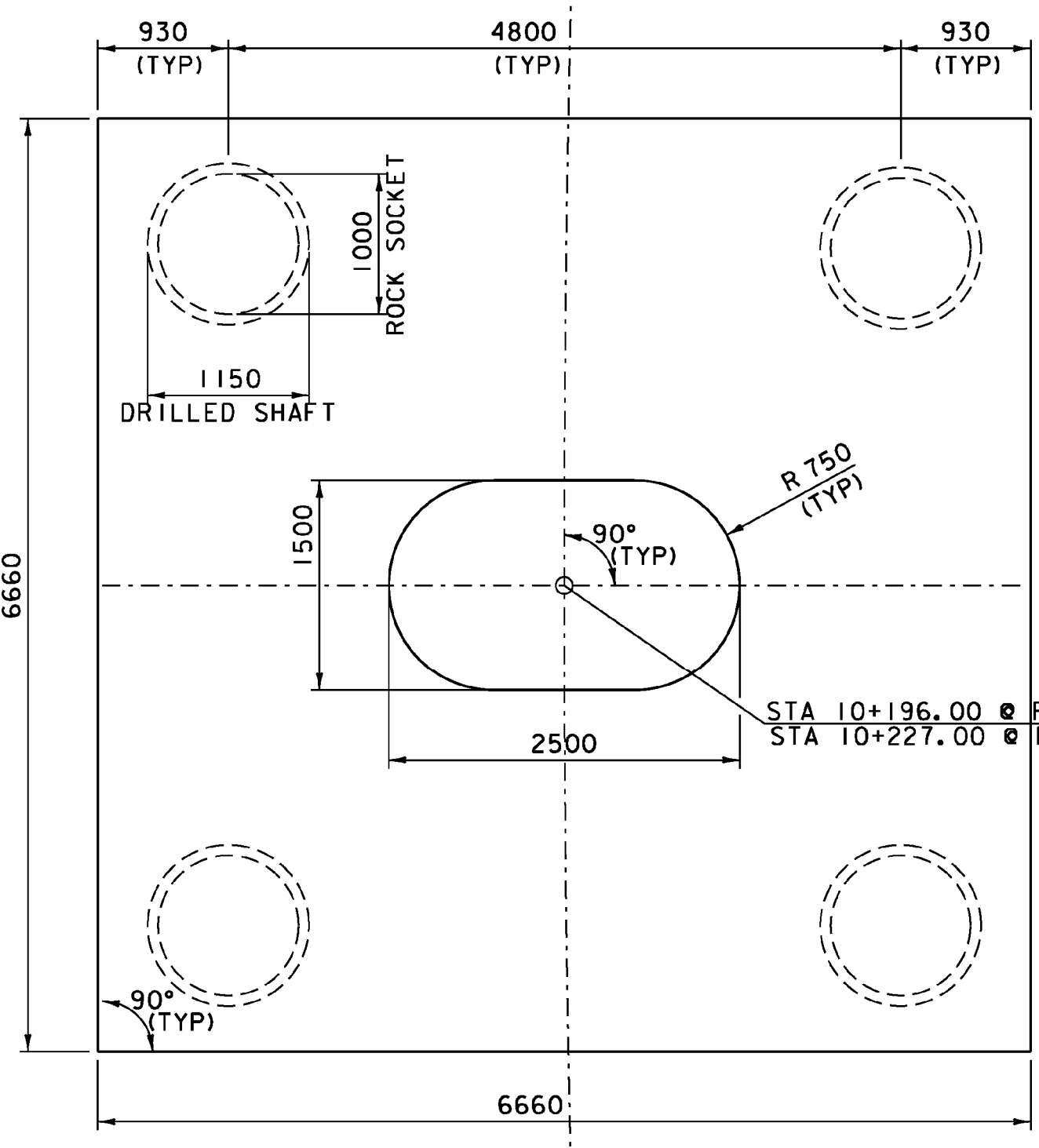
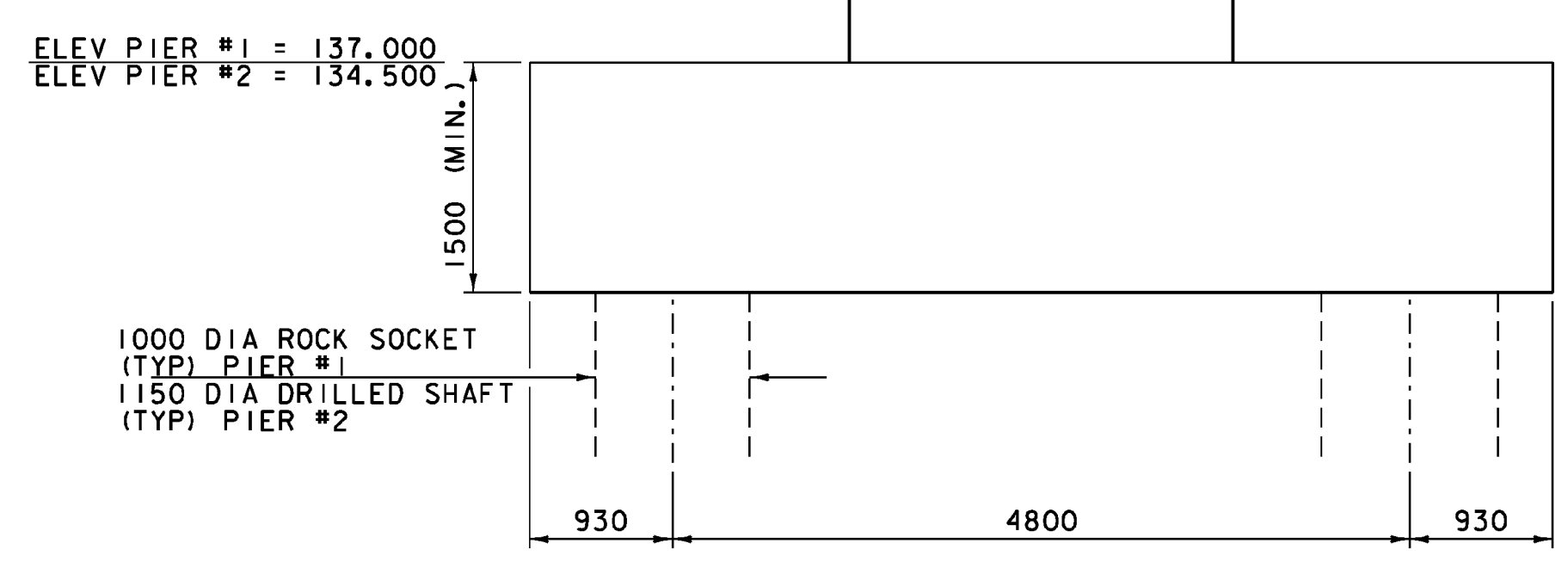

PIER FOOTING

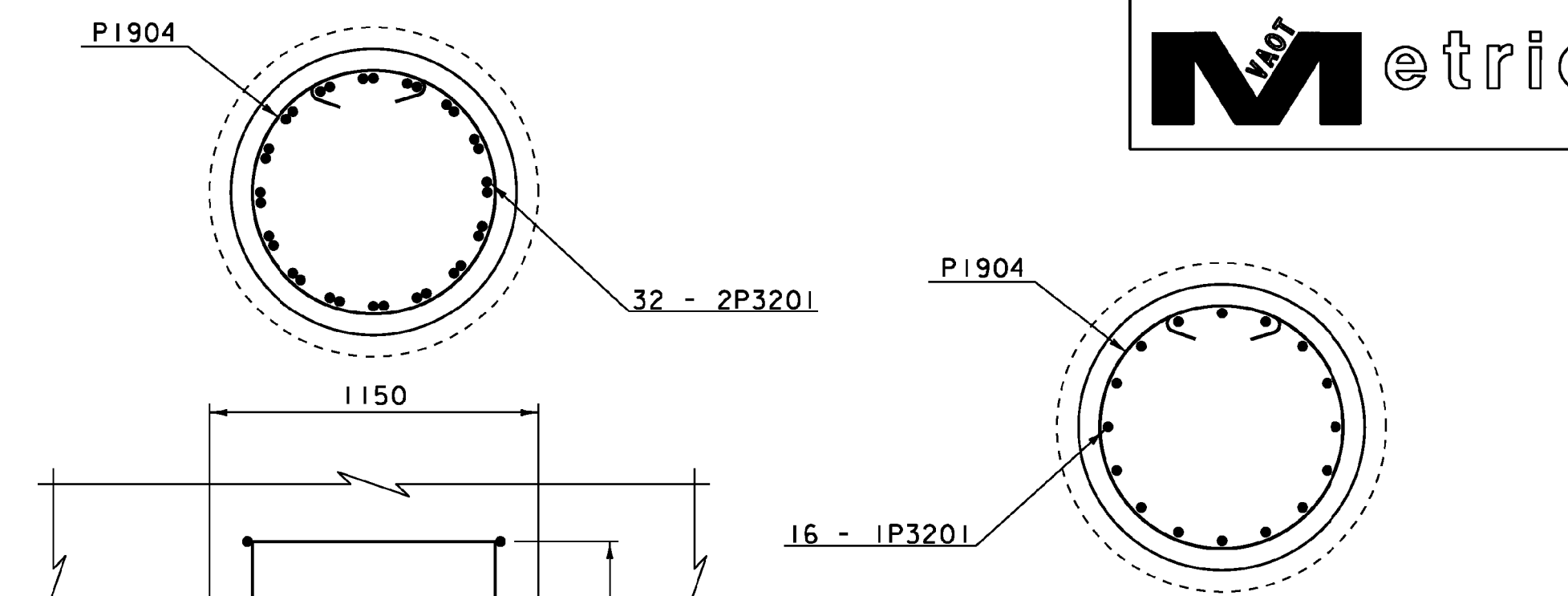
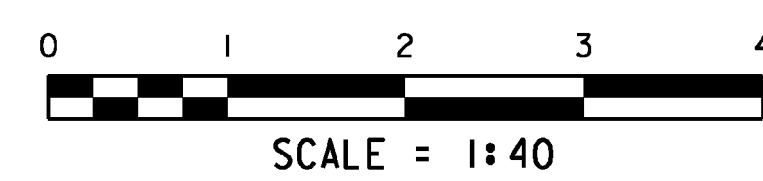

PIER #1 SHAFT REINFORCING

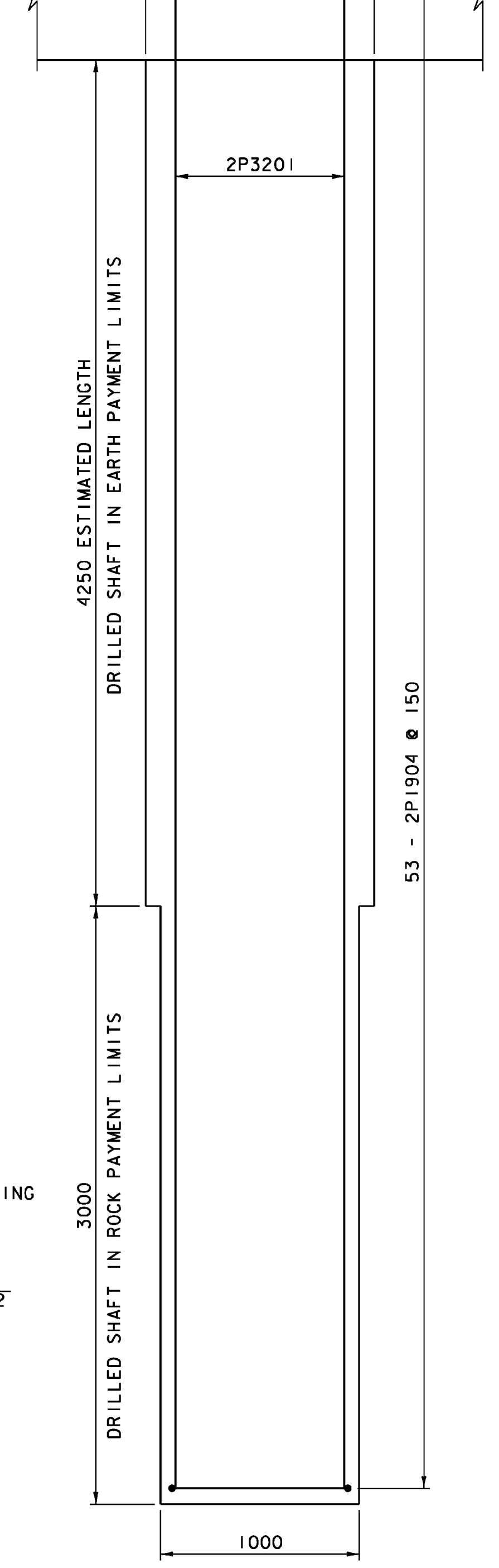

PIER #2 SHAFT REINFORCING

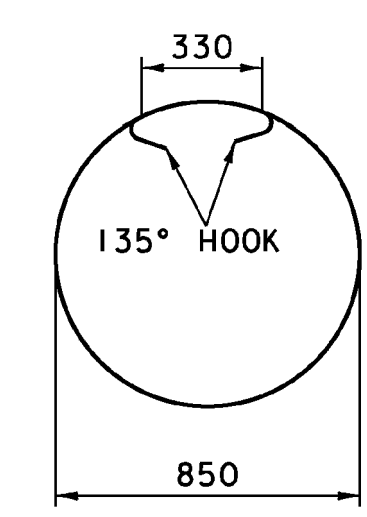
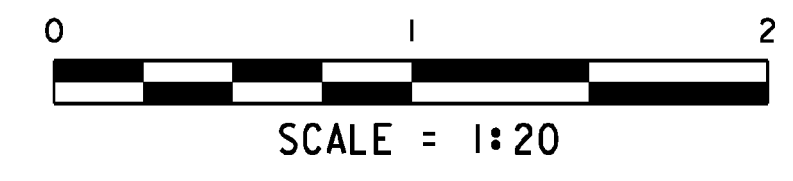

PIER #1 SHAFT REINFORCING P1904 - TYPE T3

NOTE:
 NF = NEAR FACE
 FF = FAR FACE
 EF = EACH FACE
 ▲ = CUT TO FIT IN FIELD
 80 CLEAR, UNLESS OTHERWISE SPECIFIED ON THE PLANS.
 660 BAR LAP UNLESS OTHERWISE SPECIFIED ON THE PLANS.

PROJECT NAME:	CAMBRIDGE		
PROJECT NUMBER:	BRF 027-1 (4)		
FILE NAME:	78f163subs+.dgn	PLOT DATE:	05-JUN-2012
PROJECT LEADER:	M. EVANS-MONGEON	DRAWN BY:	R. PELLET
DESIGNED BY:	T. FILLBACH	CHECKED BY:	T. FILLBACH
PIER FOOTING & SHAFTS			SHEET 178 OF 214