

STATE OF VERMONT AGENCY OF TRANSPORTATION

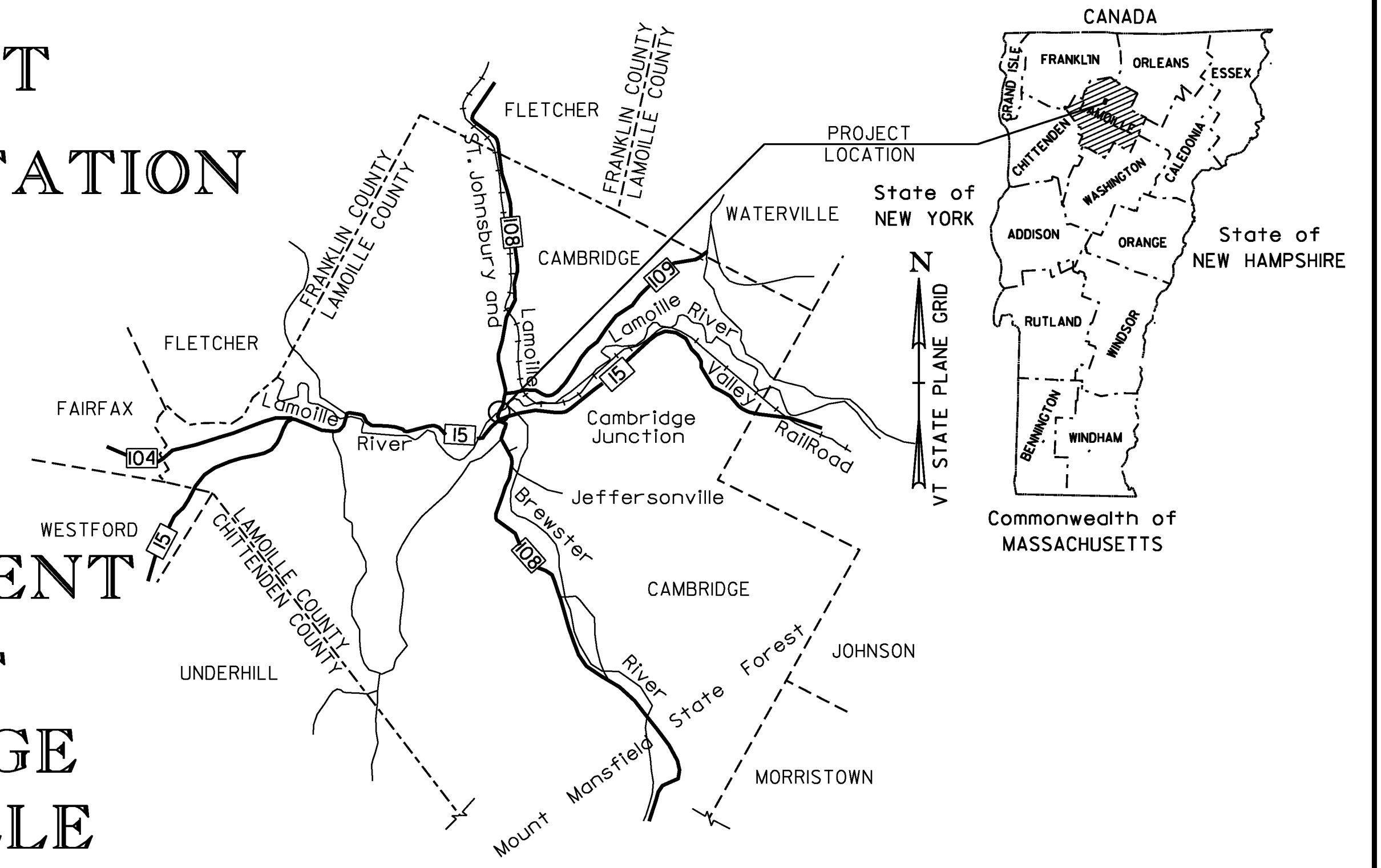

PROPOSED IMPROVEMENT BRIDGE PROJECT TOWN OF CAMBRIDGE COUNTY OF LAMOILLE VT ROUTE 108, BRIDGE #21 MAJOR COLLECTOR



TRAFFIC DATA	
VT ROUTE 108	
2012 AADT= 1800	2032 AADT= 1900
	2032 DHV= 240
	2032 %T= 3.2
	2032 %D= 56
2012 ADTT= 75	2032 ADTT= 130
FUNCTIONAL CLASS - MINOR ARTERIAL	
2012 - 2032 ESAL'S =	512,000
2012 - 2052 ESAL'S =	1,244,000
POSTED SPEED = 80 KMH	

PROJECT BR 027-1(4)

BEGINNING AT A POINT, IN THE TOWN OF CAMBRIDGE, ON VT ROUTE 108, APPROXIMATELY 82.794 M NORTHERLY OF THE VT ROUTE 15 AND VT ROUTE 108 INTERSECTION AND EXTENDING NORTHERLY FOR A DISTANCE OF APPROXIMATELY 367.206 M.

LENGTH OF ROADWAY = 289.156 m
LENGTH OF BRIDGE = 78.040 m
LENGTH OF PROJECT = 367.206 m

WORK TO BE PERFORMED UNDER THIS PROJECT INCLUDES REMOVAL OF EXISTING BRIDGE NO. 21 AND CONSTRUCTION OF A NEW BRIDGE AND APPROACHES ON AN IMPROVED HORIZONTAL ALIGNMENT, CONSTRUCTION OF VT ROUTE 108, SAND BORROW, SUBBASE, PAVEMENT, DRAINAGE, SIGNS AND OTHER HIGHWAY RELATED ITEMS.

BITUMINOUS CONCRETE PAVEMENT SUPERPAVE MIXTURE DESIGN CRITERIA	
DESIGN LANE/LIFE ESALS (20 YEARS)	512,000
DESIGN NUMBER OF GYRATIONS	65

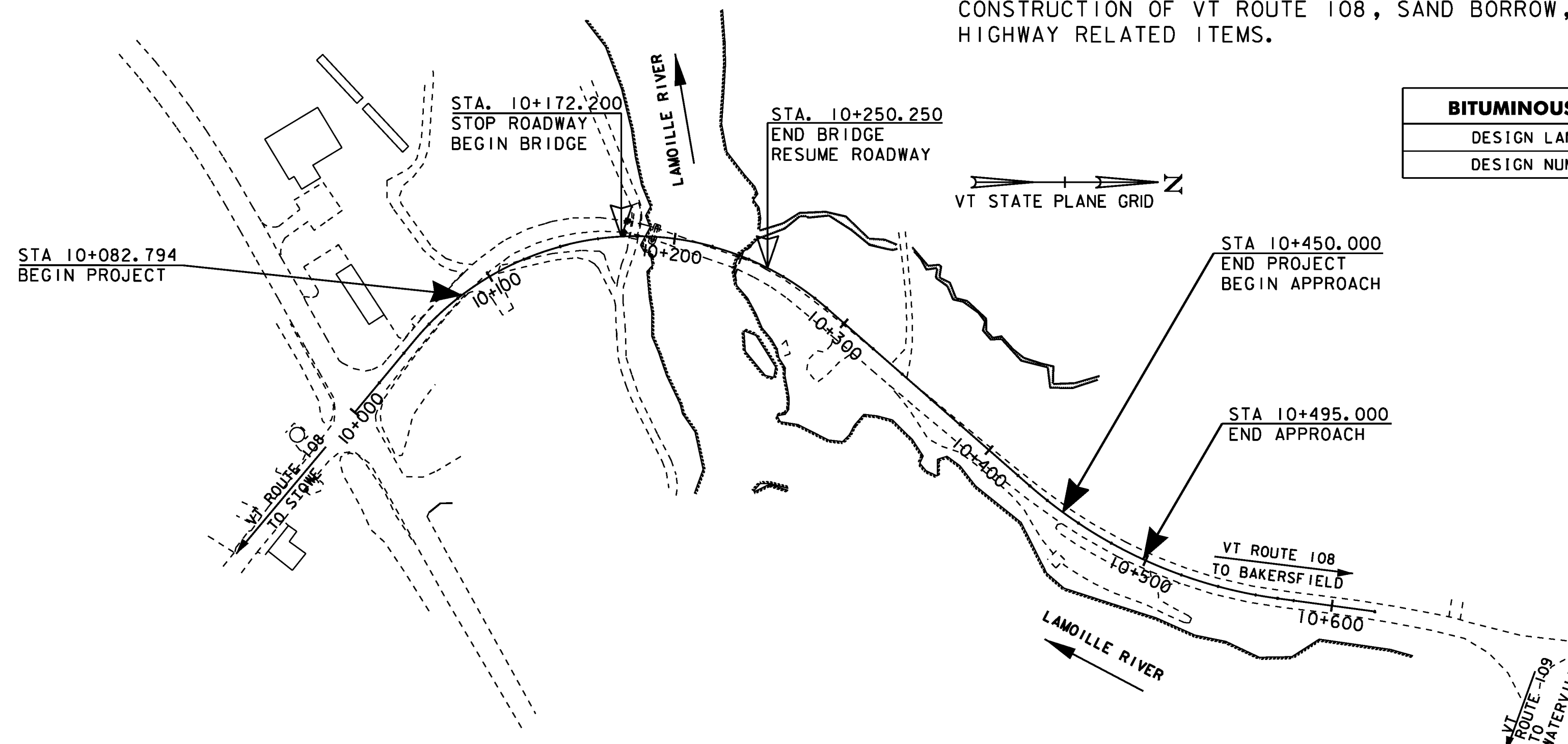

QUALITY ASSURANCE PROGRAM: LEVEL 2

CONVENTIONAL SYMBOLS

COUNTY LINE	
TOWN LINE	
LIMITS OF ACCESS	
POINT OF ACCESS	
FENCE LINE	
STONE WALL	
TRAVELED WAY	
GUARD RAIL	
RAILROAD	
SURVEY LINE	
CULVERT	
POWER POLE	
TELEPHONE POLE	
TREES	
CONTROL OF ACCESS	
PROPERTY LINE	
R.O.W. TAKING LINE	
SLOPE RIGHTS	
TOP OF CUT	
TOE OF SLOPE	

SURVEYED BY : CLD/VTRANS
SURVEYED DATE : 12/1998/2010

DATUM

VERTICAL NAVD 88
HORIZONTAL NAD 83/96

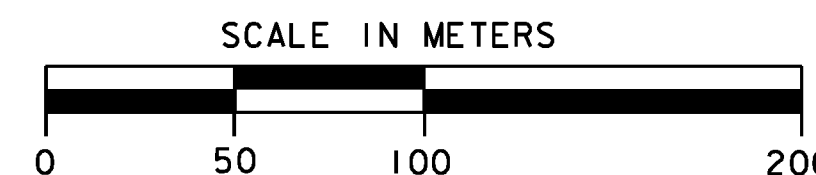

THESE PLANS ARE SUBJECT TO SUCH ENGINEERING CHANGES AS MAY BE REQUIRED BY THE FEDERAL HIGHWAY ADMINISTRATION OR THE DIRECTOR OF PROGRAM DEVELOPMENT.
CONSTRUCTION IS TO BE CARRIED ON IN ACCORDANCE WITH THESE PLANS AND THE STANDARD SPECIFICATIONS FOR CONSTRUCTION DATED 2011, AS APPROVED BY THE FEDERAL HIGHWAY ADMINISTRATION ON JULY 20, 2011 FOR USE ON THIS PROJECT, INCLUDING ALL SUBSEQUENT REVISIONS AND SUCH REVISED SPECIFICATIONS AND SPECIAL PROVISIONS AS ARE INCORPORATED IN THESE PLANS.



UNLESS NOTED OTHERWISE
STATIONS ARE IN KILOMETERS
ELEVATIONS ARE IN METERS
DIMENSIONS ARE IN MILLIMETERS

PROJECT MANAGER : M. EVANS-MONGEON

PROJECT NAME : CAMBRIDGE
PROJECT NUMBER : BR 027-1 (4)

SHEET 125 OF 214 SHEETS