

TRAFFIC CONTROL GENERAL NOTES:

1. THE TRAFFIC CONTROL PHASE V PLAN IS SUGGESTED FOR CONSTRUCTION PURPOSES. THE CONTRACTOR SHALL HAVE THE OPTION OF SUBMITTING A SEPARATE TRAFFIC CONTROL PLAN TO THE RESIDENT ENGINEER FOR REVIEW AND APPROVAL.
2. SEE SHEET 72 FOR ADDITIONAL GENERAL NOTES.

POTENTIAL CONSTRUCTION ACTIVITIES ASSOCIATED WITH TRAFFIC CONTROL, PHASE V

1. PRIOR TO THE COMMENCEMENT OF ANY WORK OR THE PLACEMENT OF EQUIPMENT ON THE ROADWAY, THE CONTRACTOR SHALL PROVIDE ADVANCED WARNING SIGNAGE IN ACCORDANCE WITH THE CONSTRUCTION SIGNING APPROACH PLAN AND THE LATEST EDITION OF THE M.U.T.C.D.
2. INSTALL AND MAINTAIN EROSION PREVENTION AND SEDIMENT CONTROL (EPSC) MEASURES IN ACCORDANCE WITH THE EPSC PLANS AND DETAILS.
3. CONSTRUCT SOUTHERN HALF OF ROUNDABOUT AND CONCRETE TRUCK APRON.
CONSTRUCT SPLITTER ISLANDS AND COMPLETE ANY REMAINING PROPOSED CURBING.
4. COMPLETE ALL FINAL GRADING, DRAINAGE, LIGHTING AND INITIAL LANDSCAPE PLANTINGS WITHIN THE PROJECT LIMITS IN ACCORDANCE WITH THE PLANS.
5. INSTALLATION OF TEMPORARY PAVEMENT MARKINGS ON THE GRAVEL WORKING SURFACE WILL BE ALLOWED AND PAID FOR UNDER CONTRACT ITEM 641.10 - TRAFFIC CONTROL. ALL OTHER TRAFFIC CONTROL DEVICES SHALL REMAIN IN PLACE AS PER ACCEPTED TRAFFIC CONTROL PLAN.
6. COMPLETE ALL PAVING OPERATIONS OF ALL TRAVELED PORTIONS OF THE PROJECT.
7. INSTALL PERMANENT SIGNING AND RECESSED AND NON-RECESSED DURABLE PAVEMENT MARKINGS IN ACCORDANCE WITH THE SIGNING AND PAVEMENT MARKING PLANS.

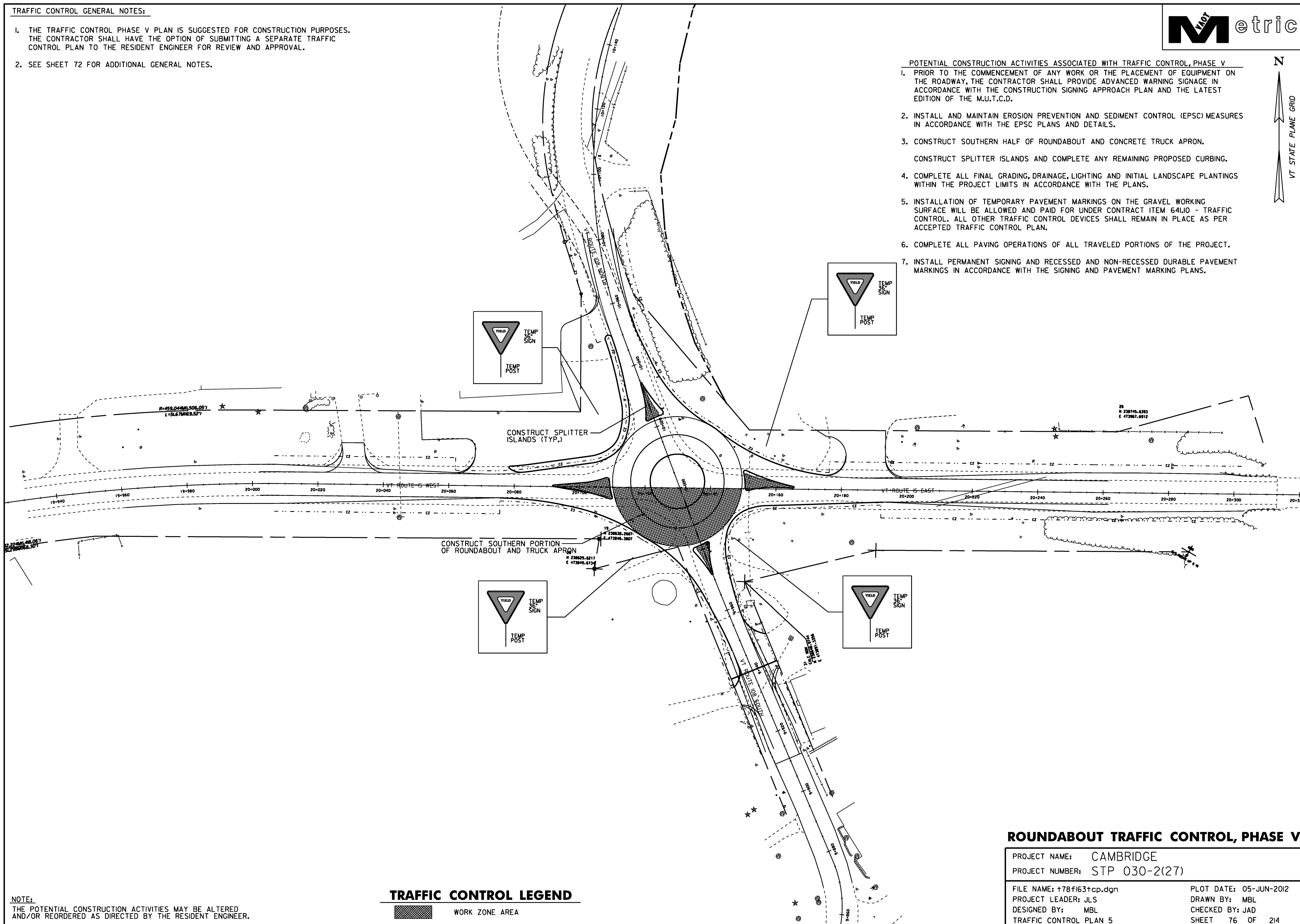
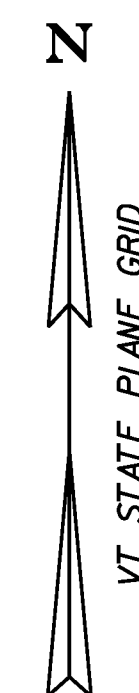

NOTE:
THE POTENTIAL CONSTRUCTION ACTIVITIES MAY BE ALTERED AND/OR REORDERED AS DIRECTED BY THE RESIDENT ENGINEER.

TRAFFIC CONTROL LEGEND

WORK ZONE AREA

ROUNDABOUT TRAFFIC CONTROL, PHASE V

PROJECT NAME:	CAMBRIDGE	PLOT DATE:	05-JUN-2012
PROJECT NUMBER:	STP 030-2(27)	DRAWN BY:	MBL
FILE NAME:	+78f163+cp.dgn	CHECKED BY:	JAD
PROJECT LEADER:	JLS	TRAFFIC CONTROL PLAN 5	SHEET 76 OF 214
DESIGNED BY:	MBL		