

TRAFFIC CONTROL GENERAL NOTES:

1. THE TRAFFIC CONTROL PHASE IV PLAN IS SUGGESTED FOR CONSTRUCTION PURPOSES. THE CONTRACTOR SHALL HAVE THE OPTION OF SUBMITTING A SEPARATE TRAFFIC CONTROL PLAN TO THE RESIDENT ENGINEER FOR REVIEW AND APPROVAL.
2. SEE SHEET 72 FOR ADDITIONAL GENERAL NOTES

POTENTIAL CONSTRUCTION ACTIVITIES ASSOCIATED WITH TRAFFIC CONTROL, PHASE IV

1. PRIOR TO THE COMMENCEMENT OF ANY WORK OR THE PLACEMENT OF EQUIPMENT ON THE ROADWAY, THE CONTRACTOR SHALL PROVIDE ADVANCED WARNING SIGNAGE IN ACCORDANCE WITH THE CONSTRUCTION SIGNING APPROACH PLAN AND THE LATEST EDITION OF THE M.U.T.C.D.
2. INSTALL AND MAINTAIN EROSION PREVENTION AND SEDIMENT CONTROL (EPSC) MEASURES IN ACCORDANCE WITH THE EPSC PLANS AND DETAILS.
3. COMPLETE CONSTRUCTION OF VT ROUTE 15 WEST AND VT ROUTE 108 SOUTH AND NORTH APPROACHES AS DETAILED ON THE PLAN.
4. CONSTRUCT NORTHERN HALF OF ROUNDABOUT AND CONCRETE TRUCK APRON.
5. DURING THIS PHASE, IN WORK ZONE AREAS WHERE TRAFFIC IS PRESENT, THE CONTRACTOR MAY TEMPORARILY REDUCE THE TRAVEL WAY TO ONE (1) 3.6m LANE DURING CONSTRUCTION AND BE UNDER FLAGGER'S CONTROL AT ALL TIMES TO ALLOW FOR COMPLETION OF WORK. ALL TRAVEL WAYS SHALL BE RESTORED TO TWO-WAY TRAFFIC PRIOR TO THE END OF THE CONSTRUCTION DAY.
6. INSTALLATION OF TEMPORARY PAVEMENT MARKINGS ON THE GRAVEL WORKING SURFACE WILL BE ALLOWED AND PAID FOR UNDER CONTRACT ITEM 6410 - TRAFFIC CONTROL. ALL OTHER TRAFFIC CONTROL DEVICES SHALL REMAIN IN PLACE AS PER ACCEPTED TRAFFIC CONTROL PLAN.

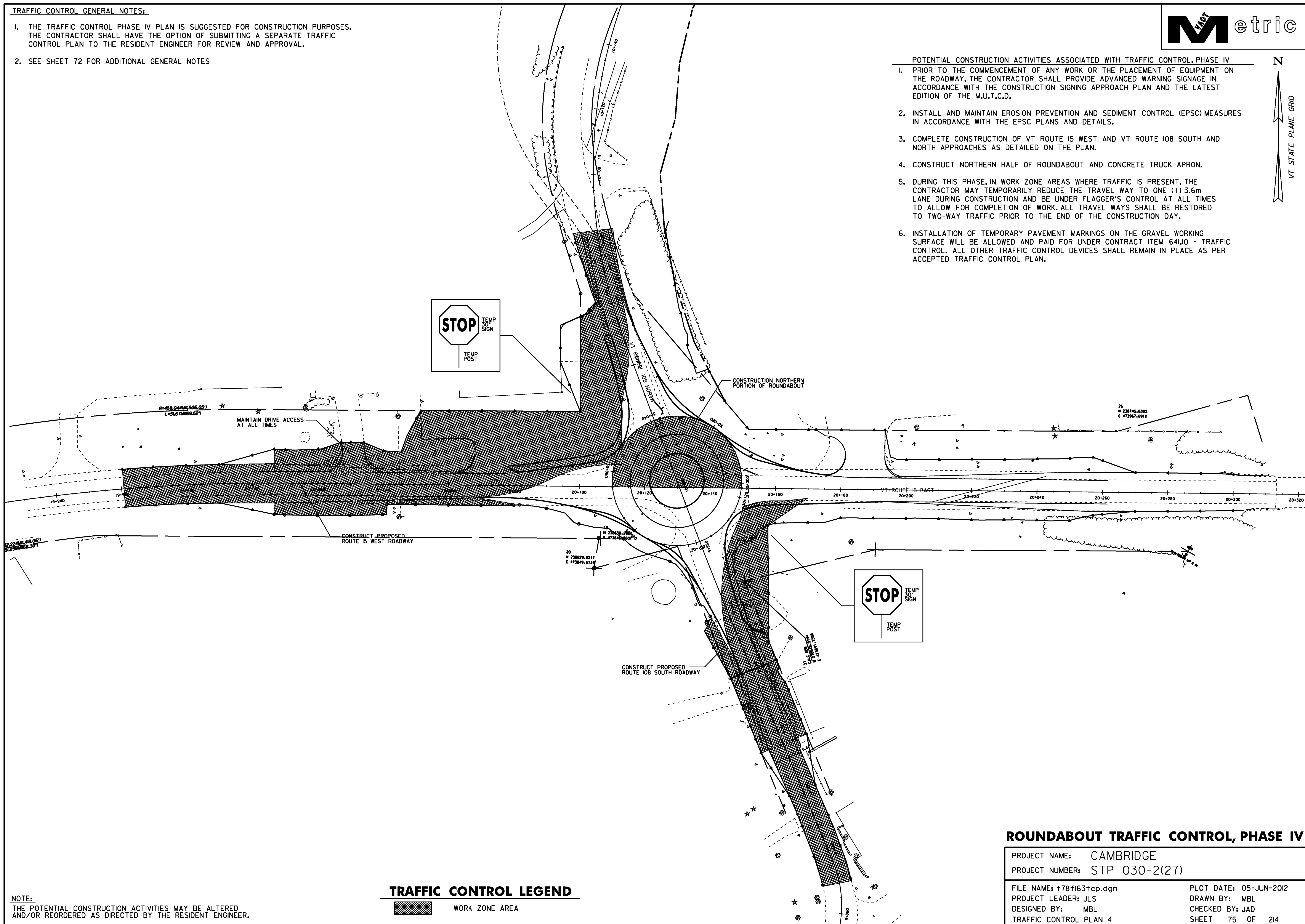
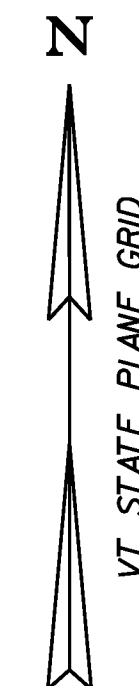

NOTE:
THE POTENTIAL CONSTRUCTION ACTIVITIES MAY BE ALTERED AND/OR REORDERED AS DIRECTED BY THE RESIDENT ENGINEER.

TRAFFIC CONTROL LEGEND

WORK ZONE AREA

ROUNDABOUT TRAFFIC CONTROL, PHASE IV

PROJECT NAME: CAMBRIDGE	PLOT DATE: 05-JUN-2012
PROJECT NUMBER: STP 030-2(27)	DRAWN BY: MBL
FILE NAME: +78f163+cp.dgn	CHECKED BY: JAD
PROJECT LEADER: JLS	SHEET 75 OF 214
DESIGNED BY: MBL	
TRAFFIC CONTROL PLAN 4	