

TRAFFIC CONTROL GENERAL NOTES:

1. THE TRAFFIC CONTROL PHASE III PLAN IS SUGGESTED FOR CONSTRUCTION PURPOSES. THE CONTRACTOR SHALL HAVE THE OPTION OF SUBMITTING A SEPARATE TRAFFIC CONTROL PLAN TO THE RESIDENT ENGINEER FOR REVIEW AND APPROVAL.
2. SEE SHEET 72 FOR ADDITIONAL GENERAL NOTES

POTENTIAL CONSTRUCTION ACTIVITIES ASSOCIATED WITH TRAFFIC CONTROL, PHASE III

1. PRIOR TO THE COMMENCEMENT OF ANY WORK OR THE PLACEMENT OF EQUIPMENT ON THE ROADWAY, THE CONTRACTOR SHALL PROVIDE ADVANCED WARNING SIGNAGE IN ACCORDANCE WITH THE CONSTRUCTION SIGNING APPROACH PLAN AND THE LATEST EDITION OF THE M.U.T.C.D.
2. INSTALL AND MAINTAIN EROSION PREVENTION AND SEDIMENT CONTROL (EPSC) MEASURES IN ACCORDANCE WITH THE EPSC PLANS AND DETAILS.
3. CONSTRUCT TEMPORARY VT ROUTE 108 NORTH ROADWAY.
4. REMOVE TEMPORARY ROADWAY WIDENING AREAS FROM PHASE I. THIS REMOVAL SHALL BE PAID FOR UNDER CONTRACT ITEM 900.645 - SPECIAL PROVISION (TEMPORARY ROADWAY WIDENING)(PHASE I).
5. CONSTRUCT PROPOSED VT ROUTE 108 NORTH ROADWAY AND STORMWATER CHANNEL AS DETAILED IN THE PLAN.
6. INSTALLATION OF TEMPORARY PAVEMENT MARKINGS ON THE GRAVEL WORKING SURFACE WILL BE ALLOWED AND PAID FOR UNDER CONTRACT ITEM 641.10 - TRAFFIC CONTROL. ALL OTHER TRAFFIC CONTROL DEVICES SHALL REMAIN IN PLACE AS PER ACCEPTED TRAFFIC CONTROL PLAN.
7. THE CONTRACTOR SHALL CONTACT THE OPERATOR OF THE BUSINESS AT LEAST TWO WEEKS IN ADVANCE OF CLOSING OFF AND CONSTRUCTING THE TEMPORARY ROADWAY FOR ROUTE 108 NORTH.

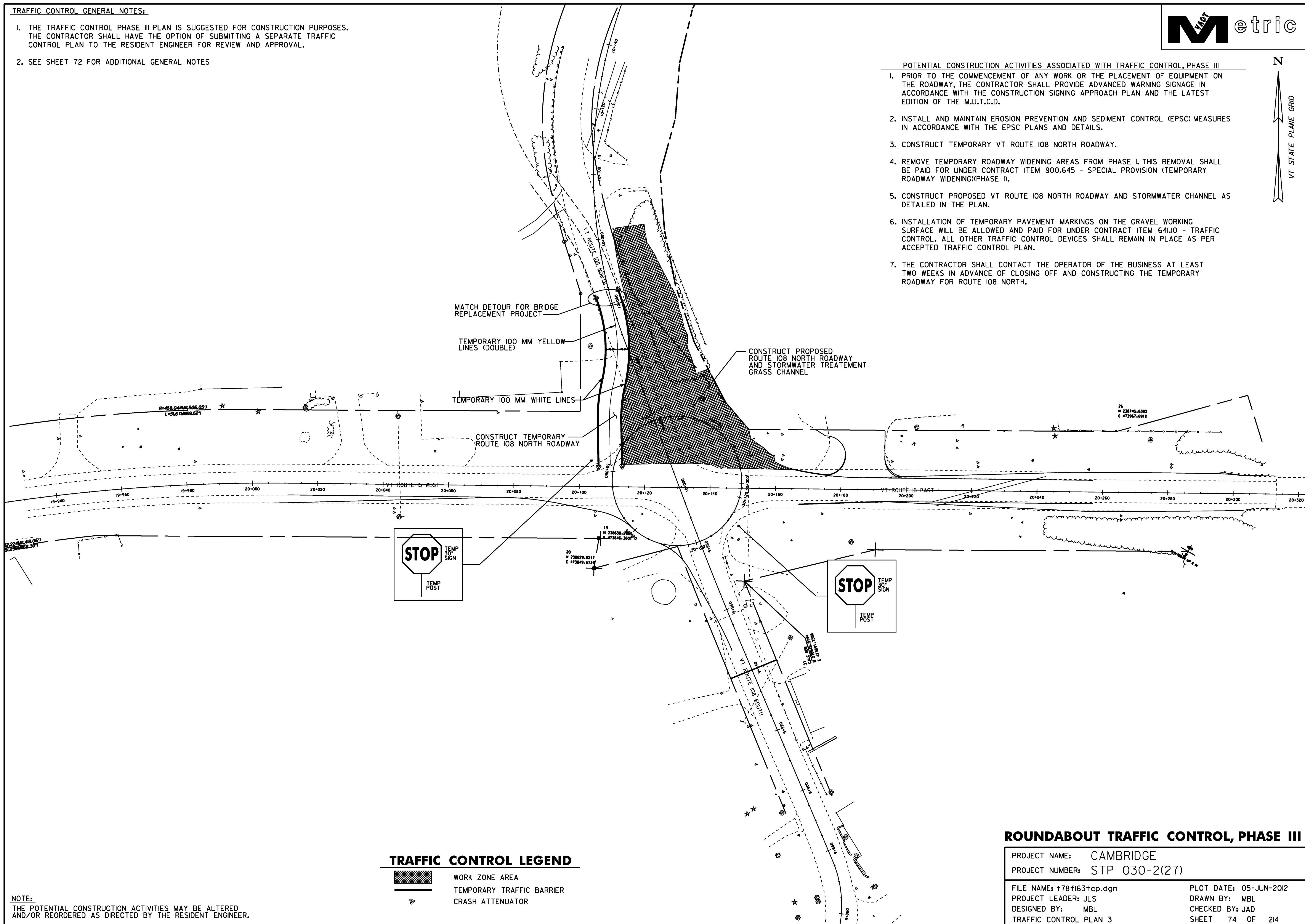

TRAFFIC CONTROL LEGEND

- WORK ZONE AREA
- TEMPORARY TRAFFIC BARRIER
- CRASH ATTENUATOR

NOTE:
THE POTENTIAL CONSTRUCTION ACTIVITIES MAY BE ALTERED AND/OR REORDERED AS DIRECTED BY THE RESIDENT ENGINEER.

ROUNDABOUT TRAFFIC CONTROL, PHASE III

PROJECT NAME: CAMBRIDGE	PLOT DATE: 05-JUN-2012
PROJECT NUMBER: STP 030-2(27)	DRAWN BY: MBL
FILE NAME: +78f163+cp.dgn	CHECKED BY: JAD
PROJECT LEADER: JLS	SHEET 74 OF 214
DESIGNED BY: MBL	
TRAFFIC CONTROL PLAN 3	