

- ONE ~ END POST ~ 16EP1W**
(LOOKING SOUTH @ LO WEST)
 - ONE ~ END POST ~ 16EP1E**
(LOOKING NORTH @ LO EAST)
 - ONE ~ END POST ~ 16EP2W**
(LOOKING SOUTH @ L10 WEST)
 - ONE ~ END POST ~ 16EP2E**
(LOOKING NORTH @ L10 EAST)
- ALIKE EXCEPT FOR MARK

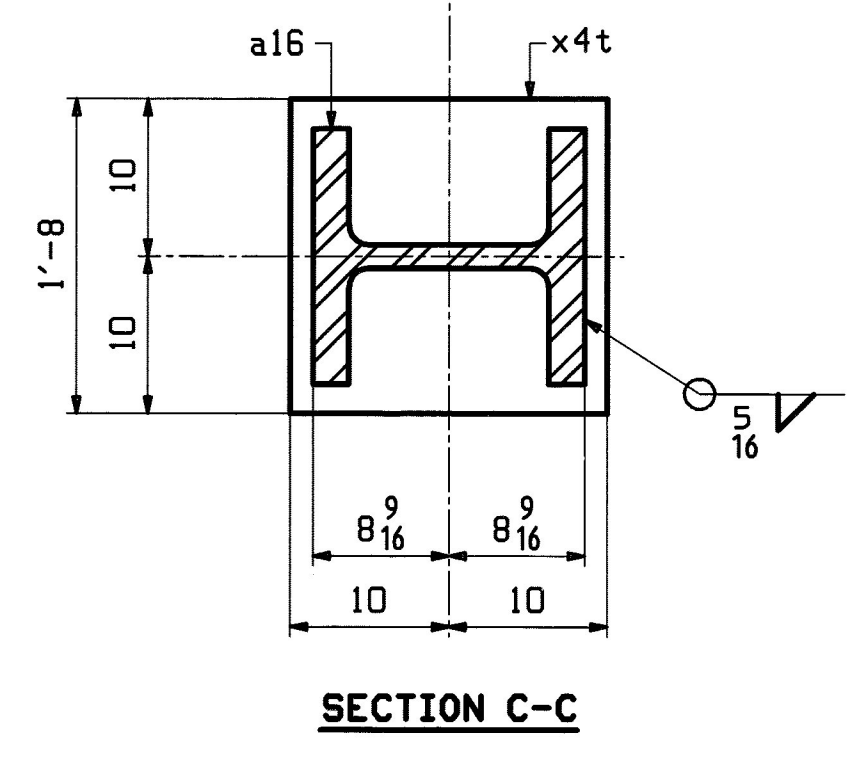

ABM INFO		SHIP		BILL OF MATERIAL				JOB NO.	DRAWING NO.	REV.
								498	16	
PAGE	LINE	MARK	QTY	MARK	MATERIAL	LENGTH		REMARKS	WT	PROCUREMENT NOTES
						FT	INCHES			
		16EP1W	1		END POST					
1	U		1	a16	W 14x311	4	8 1/2			
1	V		1	x4t	PL 1/2x20	1	8			1634
		16EP1E	1		END POST					1634
1	U		1	a16	W 14x311	4	8 1/2			
1	V		1	x4t	PL 1/2x20	1	8			
		16EP2W	1		END POST					1634
1	U		1	a16	W 14x311	4	8 1/2			
1	V		1	x4t	PL 1/2x20	1	8			
		16EP2E	1		END POST					1634
1	U		1	a16	W 14x311	4	8 1/2			
1	V		1	x4t	PL 1/2x20	1	8			

Vermont Agency of Transportation
RECEIVED
 CK'D BY M.C.L. OK'D BY S.S.S.
 January 10 2012
 RESUBMIT APPROVED ✓
 BY J. LACROIX DATE 01-12-2012

REV. DATE	REMARKS	DWN	CHK	APVL	SHOP
MATERIAL:	SURFACE PREP. & PAINT:	HOLES:		SHOP BOLTS:	
M270-50 (UN)	HOT-DIP GALV.	15/16 (UN)		7/8 (UN)	
DESCRIPTION: END POSTS @ LO & L10					
CASCO BAY STEEL STRUCTURES, INC. 1 WALLACE AVE. PHONE (207) 780-6722 SOUTH PORTLAND, ME 04106 FAX. (207) 780-6726					
STRUCTURE: VT RTE 107 OVER WHITE RIVER				DRAWN:	DATE:
				EEO	10/11
				CHKD:	DATE:
				PCP	10/14
LOCATION: BETHEL, VT.		JOB NO.		DWG NO.	
PROJ NO. BRF 022-1(14)		498		16	
CUSTOMER: BECK & BELLUCCI				REV. 1	