

FIELD BOLT LIST		A325 Type 1 GALV. BOLTS										FIELD BOLT SUMMARY
LINE	NO. OF BOLTS	BOLT DIA.	BOLT LEN.	# OF CONN.	GROUP	THICKNESS OF PCL. CONNECTED	WASHER CODES	FIELD BOLT SUMMARY				REMARKS
								NO. OF BOLTS	BOLT DIA.	BOLT LEN.	ACTUAL COUNT	
419												PORTAL STRUT
420	80	7/8	2 1/2	5	16	1	L1	198	7/8	2	192	End Guss ~ Conn L
421	64	7/8	4	8	8	2	L1	100	7/8	2 1/4	96	End Guss ~ Fill ~ Strut
422	56	7/8	4	14	4	2 1/4	L1	296	7/8	3 3/4	298	Portal Guss ~ Fill ~ Strut
423												
424												END PORTAL
425	24	5/8	3 1/2	6	4	2 1/4	L1					TopCornerGuss-Fill-Port Diag
426	24	5/8	2 1/4	6	4	1	L1					TopCornerGuss-Fill-Port Diag
427	48	5/8	3 1/2	6	8	2 1/4	L1					Top Part Guss-Fill-Port Diag
428	48	5/8	2 1/4	6	8	1	L1					Top Part Guss-Fill-Port Diag
429	24	5/8	3 1/2	6	4	2 1/4	L1					TopPartGuss-Fill-Long. Strut
430	24	5/8	2 1/4	6	4	1	L1					TopPartGuss-Fill-Long. Strut
431	48	5/8	2	4	12	1 1/2	L1					Ctr Guss ~ Long Portal Diag
432	144	5/8	2	6	24	1 1/2	L1					Ctr Guss ~ Short Portal Diag
433	48	5/8	3 1/2	6	8	2 1/4	L1					BtmCornerGuss-Fill-Port Diag
434	86	5/8	3 1/2	6	16	2 1/4	L1					Btm Part Guss-Fill-Port Diag
435	48	5/8	3 1/2	6	8	2 1/4	L1					BtmPartGuss-Fill-Long. Strut
436												

WASHER CODES
 L1: 1 Flat, 1 Load Ind.
 LIM: # head, hard ws., # nut

LINE	NO. OF BOLTS	BOLT DIA.	TYPE	BOLT LEN.	ACTUAL COUNT	REMARKS
1	198	7/8	A325 Type 1	2	192	RCT (MECH. GALV.)
2	100	7/8		2 1/4	96	RCT (MECH. GALV.)
3	296	7/8	A325 Type 1	3 3/4	298	RCT (MECH. GALV.)
4						
5	594		Hard Flat Washers	For 7/8" BOLT		F436, RCT (MECH. GALV.)
6	594		Load Ind. Washers	For 7/8" BOLT		F959, RCT (MECH. GALV.)
7						
8						
9	3613	7/8	A325 Type 1	2 1/2	3540	RCT (MECH. GALV.)
10	1361	7/8		2 3/4	1332	RCT (MECH. GALV.)
11	1406	7/8		3	1376	RCT (MECH. GALV.)
12	247	7/8		3 1/4	240	RCT (MECH. GALV.)
13	3406	7/8		3 1/2	3337	RCT (MECH. GALV.)
14	3749	7/8		3 3/4	3674	RCT (MECH. GALV.)
15	1552	7/8		4	1520	RCT (MECH. GALV.)
16	353	7/8		4 1/4	344	RCT (MECH. GALV.)
17	2564	7/8		4 1/2	2512	RCT (MECH. GALV.)
18	133	7/8		5	128	RCT (MECH. GALV.)
19	35	7/8	A325 Type 1	5 1/2	32	RCT (MECH. GALV.)
20						
21	18494		Hard Flat Washers	For 7/8" BOLT		F436, RCT (MECH. GALV.)
22	18419		Load Ind. Washers	For 7/8" BOLT		F959, RCT (MECH. GALV.)
23						
24						
25	332	1	A325 Type 1	3 1/2	324	RCT (MECH. GALV.)
26	332	1		4	324	RCT (MECH. GALV.)
27	75	1		5	72	RCT (MECH. GALV.)
28	149	1	A325 Type 1	6	144	RCT (MECH. GALV.)
29						
30	1037		Hard Flat Washers	For 1" BOLT		F436, RCT (MECH. GALV.)
31	889		Load Ind. Washers	For 1" BOLT		F959, RCT (MECH. GALV.)
32						
33						
34						

Vermont Agency of Transportation
RECEIVED

CK'D BY M.C.L. OK'D BY S.S.S.

March 9 2012

RESUBMIT APPROVED AS NOTED ✓
 BY J. LACROIX DATE 01-12-2012

- NOTES:
 1. REFER TO SHEET GNI FOR GENERAL NOTES.
 2. WORK THIS SHEET WITH SHEETS E5 & E6.

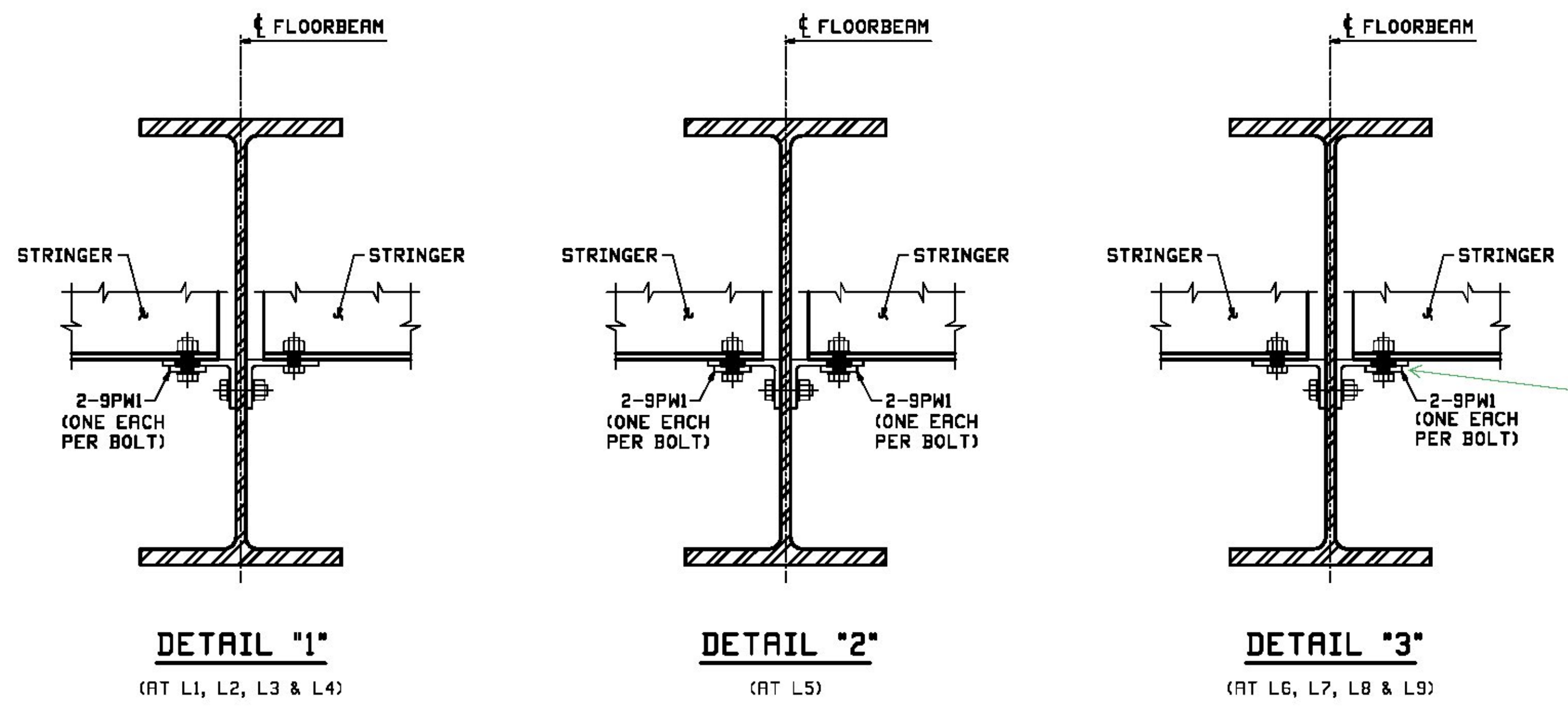

Washer should be under turned element (typical).

REV.	DATE	REMARKS	DWN	CHK	APVL	SHOP
0						
MATERIAL:		SURFACE PREP. & PAINT:	HOLES:		SHOP BOLTS:	
DESCRIPTION: FIELD BOLTS						
CASCO BAY STEEL STRUCTURES, INC. 1 WALLACE AVE. PHONE (207) 780-6722 SOUTH PORTLAND, ME 04106 FAX. (207) 780-6726						
STRUCTURE: VT RTE 107 OVER WHITE RIVER				DATE:	EEO 02/16	
				CHKD:	TJB 02/20	
LOCATION: BETHEL, VT.				JOB NO.	498	
PROJ NO. BRP 022-1(14)				DWG NO.	E7	
CUSTOMER: BECK & BELLUCCI				REV.	△	