

COST OF FURNISHING AND PLACING 2" REINFORCED EXPANSION MATERIAL TO BE INCLUDED IN UNIT PRICE BID FOR CLASS A (1-2-4) CONCRETE.

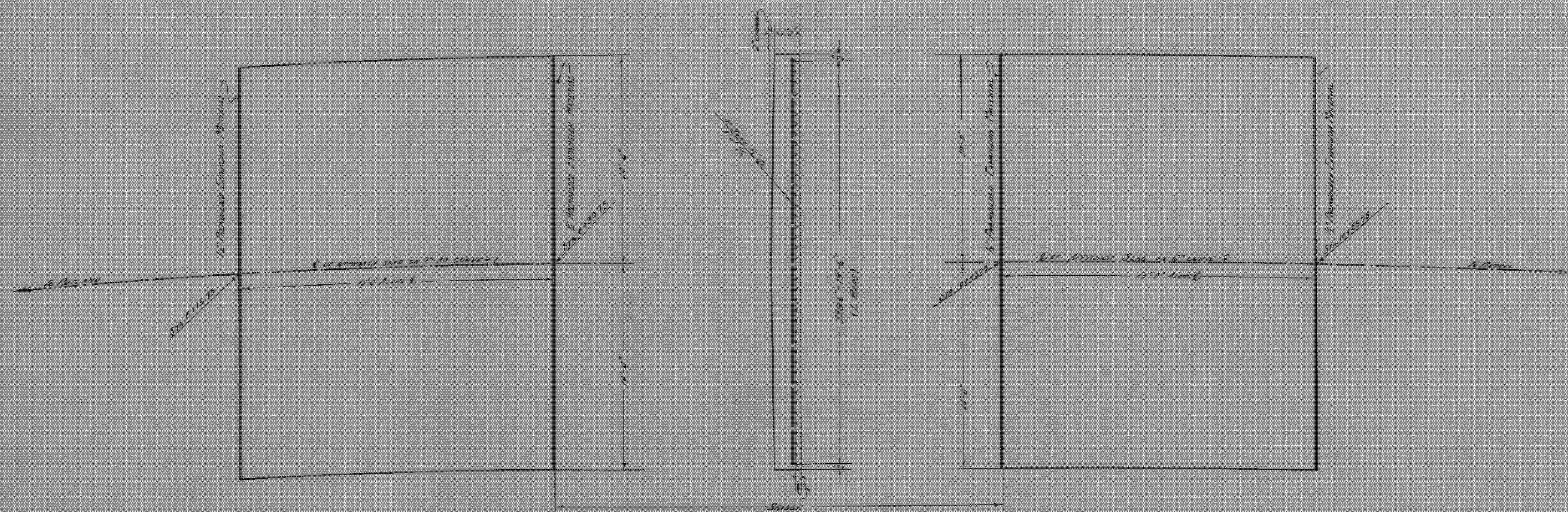

ENGINEER IN FIELD SHALL PROVIDE FOR WIDENING AND BANDING AT STATION 7+42.75 AND STATION 10+38.25 TO MEET REQUIREMENTS ROAD BANDING CONSTRUCTION. SECTION SHOWN IS AT STATION 6+30.18 OR STATION 10+93.65.

CONCRETE IN APPROACH SLABS TO BE CLASS A (1-2-4).

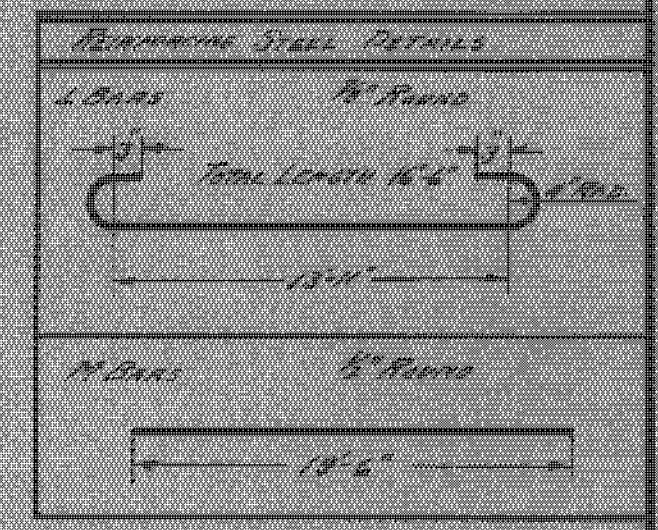
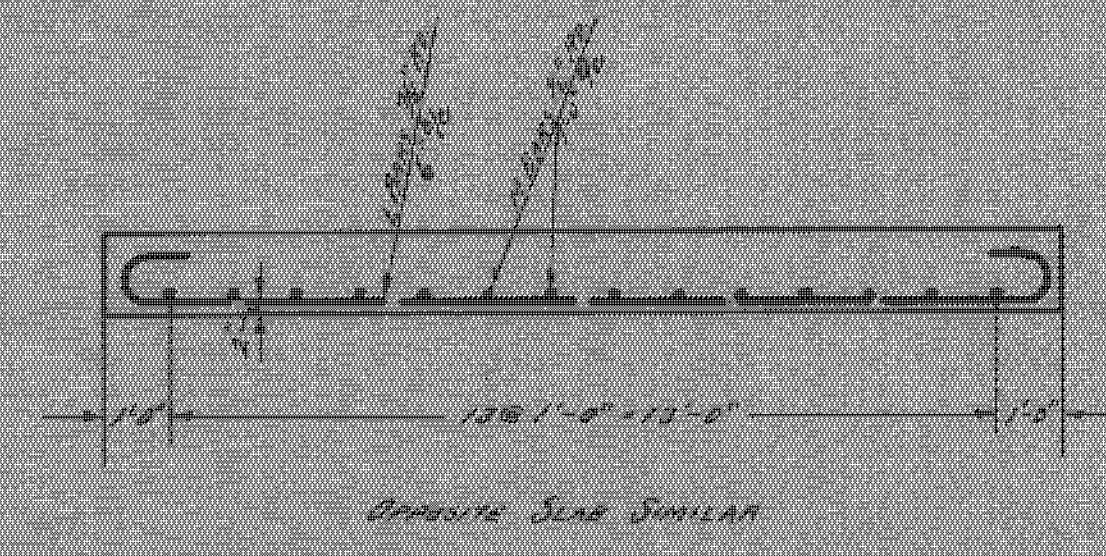

ALL STEEL TO BE OBTAINED FROM REINFORCING STEEL TO CONFORM TO STANDARDS SPECIFICATIONS FOR BILLET STEEL CONCRETE REINFORCEMENT BARS, STRUCTURAL OR INTERMEDIATE GRADE, OF THE AMERICAN SOCIETY FOR TESTING MATERIALS, SERIAL DESIGNATION A15-11.

**APPROACH SLAB DETAILS
 BRIDGE OVER WHITE RIVER
 BETHEL, VT.**

APPROACH SLABS
 ESTIMATED QUANTITIES
 CLASS A (1-2-4) CONCRETE 30 Cu.Yds.
 REINFORCING STEEL 3089 LBS.

Drawn by: TOWNES
 Designed by: REIDMAN
 Traced by: BARNETT
 Checked by: W.D. MONTGOMERY 6-13-28
 Series: F No. 101 C File: 5-23-28
 Sheet: 15 of 18 Sheets