

WINGWALL No. 3 ELEVATION

Scale $\frac{3}{8}'' = 1'-0''$

- ▲ Cut to Fit In Field
- Bend to Fit In Field

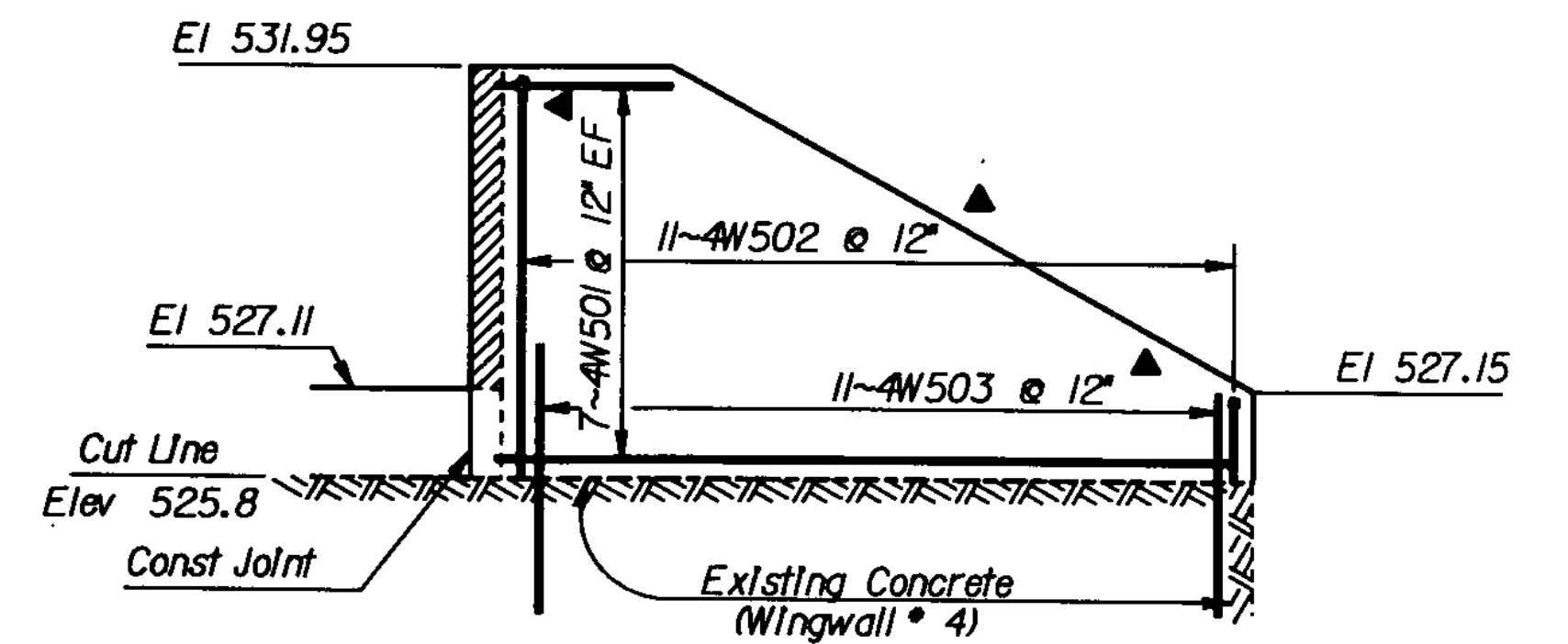

WINGWALL No. 4 ELEVATION

Scale $\frac{3}{8}'' = 1'-0''$

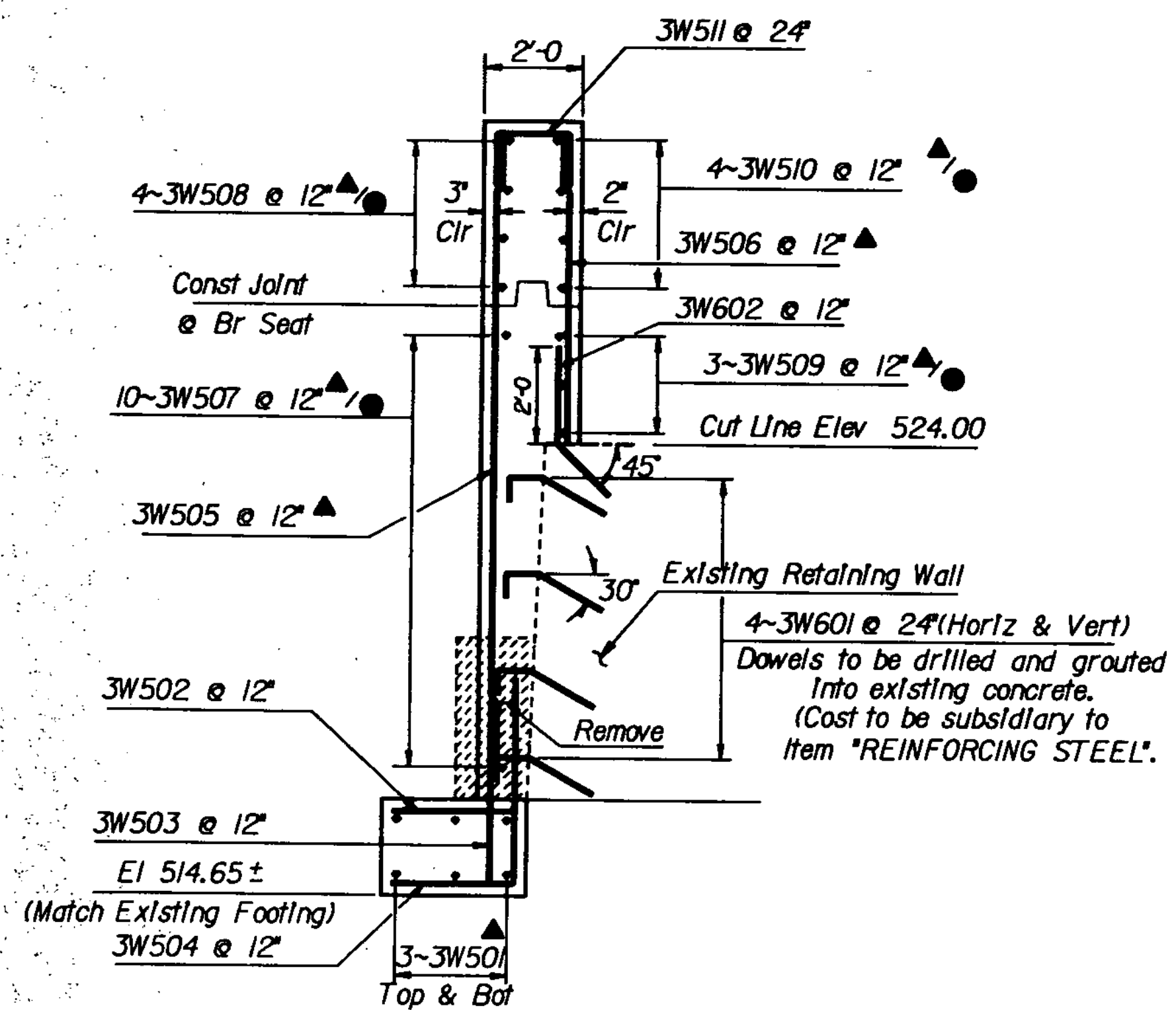

WINGWALL No. 3 TYPICAL SECTION

Scale $\frac{3}{8}'' = 1'-0''$

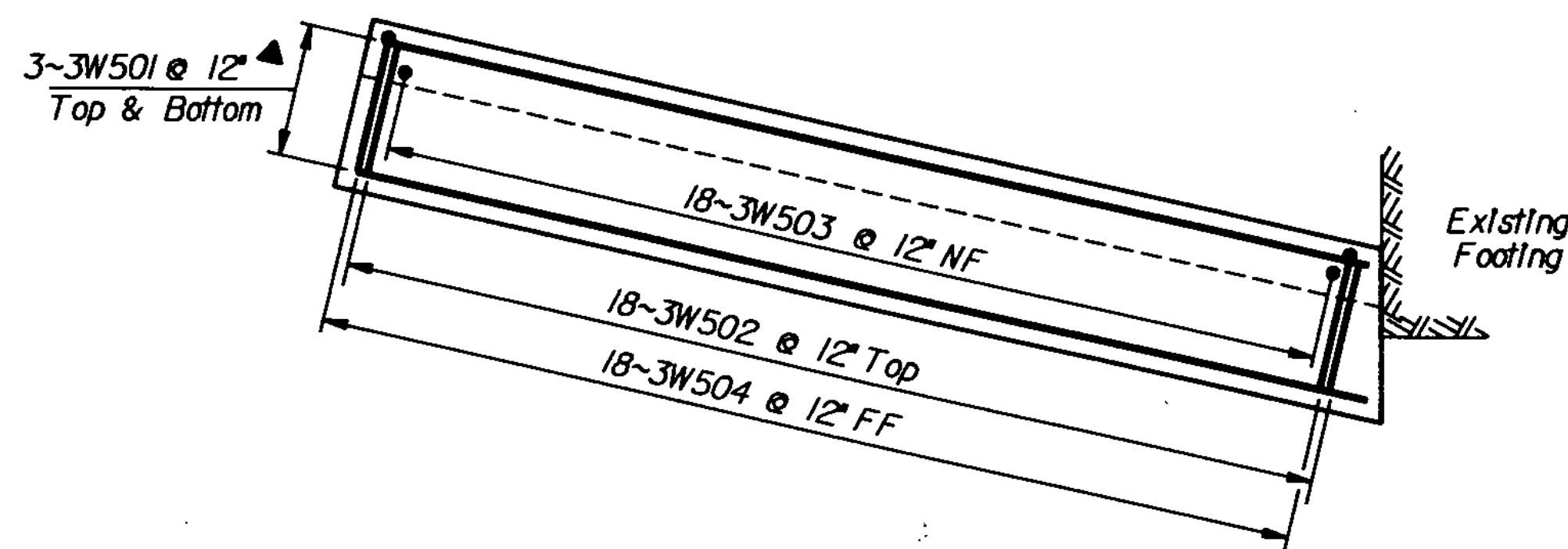

WINGWALL No. 3 FOOTING REINFORCING PLAN

Scale $\frac{3}{8}'' = 1'-0''$

STATE OF VERMONT AGENCY OF TRANSPORTATION			
Town of	MONTGOMERY	Bridge No.	15
Highway No.	Vt Rte 118	Log Sta.	296 + 30
		Surv. Sta.	Rev 55 + 62.85
Vt Rte 118 over the Trout River			
Wingwall No 3 & 4 Details			
Designed By	K. R. Sikora	Drawn By	E. Blodgett
Checked By	K. R. Sikora	Date	8/84
		Bridge Design Supervisor	F.W. Bolcum Date 12/84
PROJECT	MONTGOMERY	PROJECT NO.	BHS 0283(6)S
L&C. Info.	QSA: (30, 23) 78E151A82.DGN		
Bridge Sheet No.	Sheet 16 of 46		