

**WINGWALL No. 2 ELEVATION**

Scale 1/2" = 1'-0"

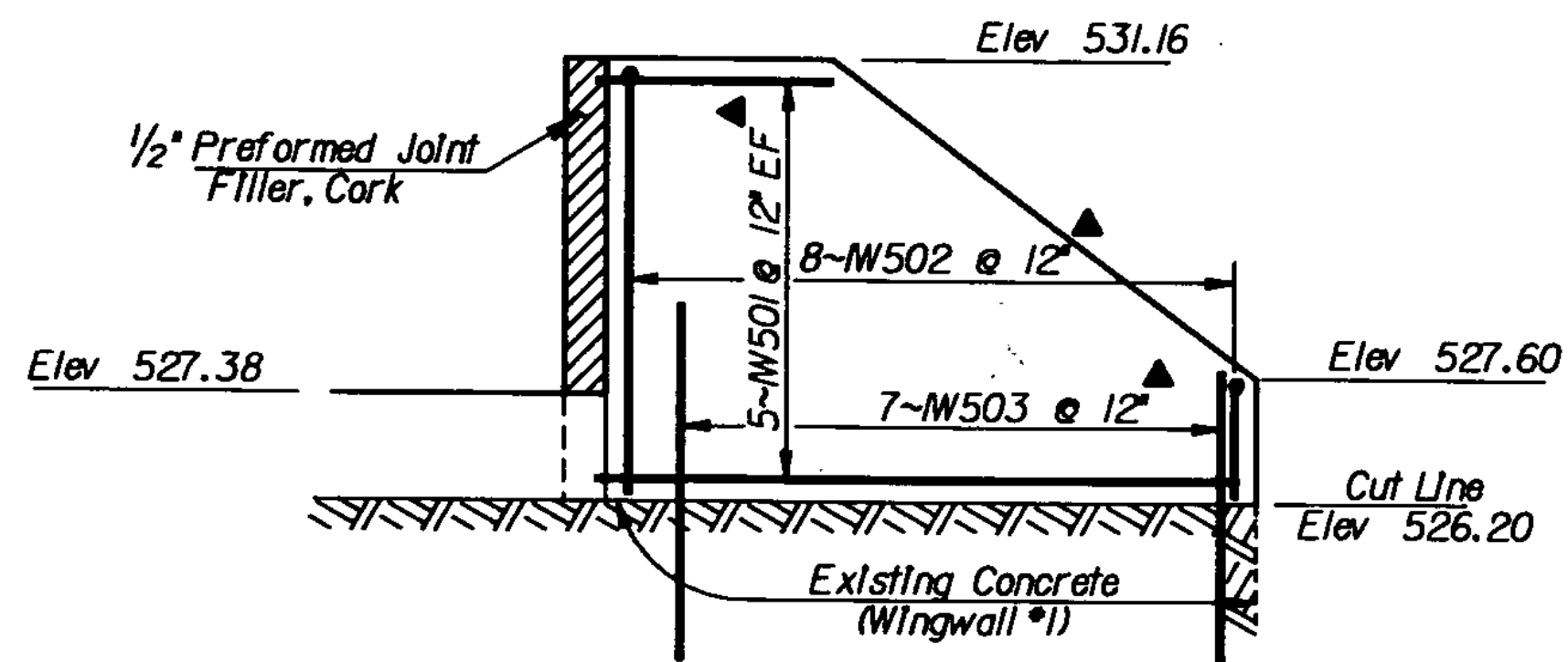

**WINGWALL No. 1 ELEVATION**

Scale 1/2" = 1'-0"

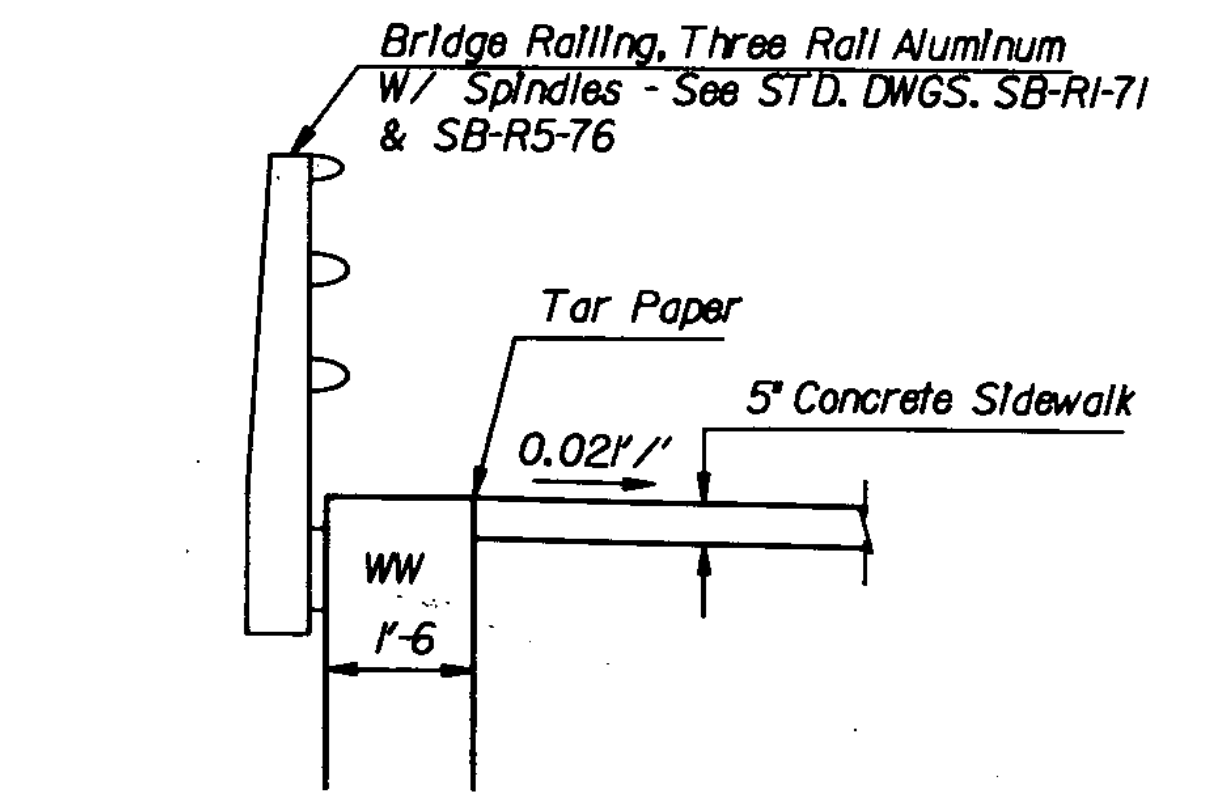

**TYPICAL @ TOP OF WINGWALL # 2**

Scale 1/2" = 1'-0"

▲ Indicates Cut to Fit in Field

FF - Far Face  
NF - Near Face  
EF - Each Face

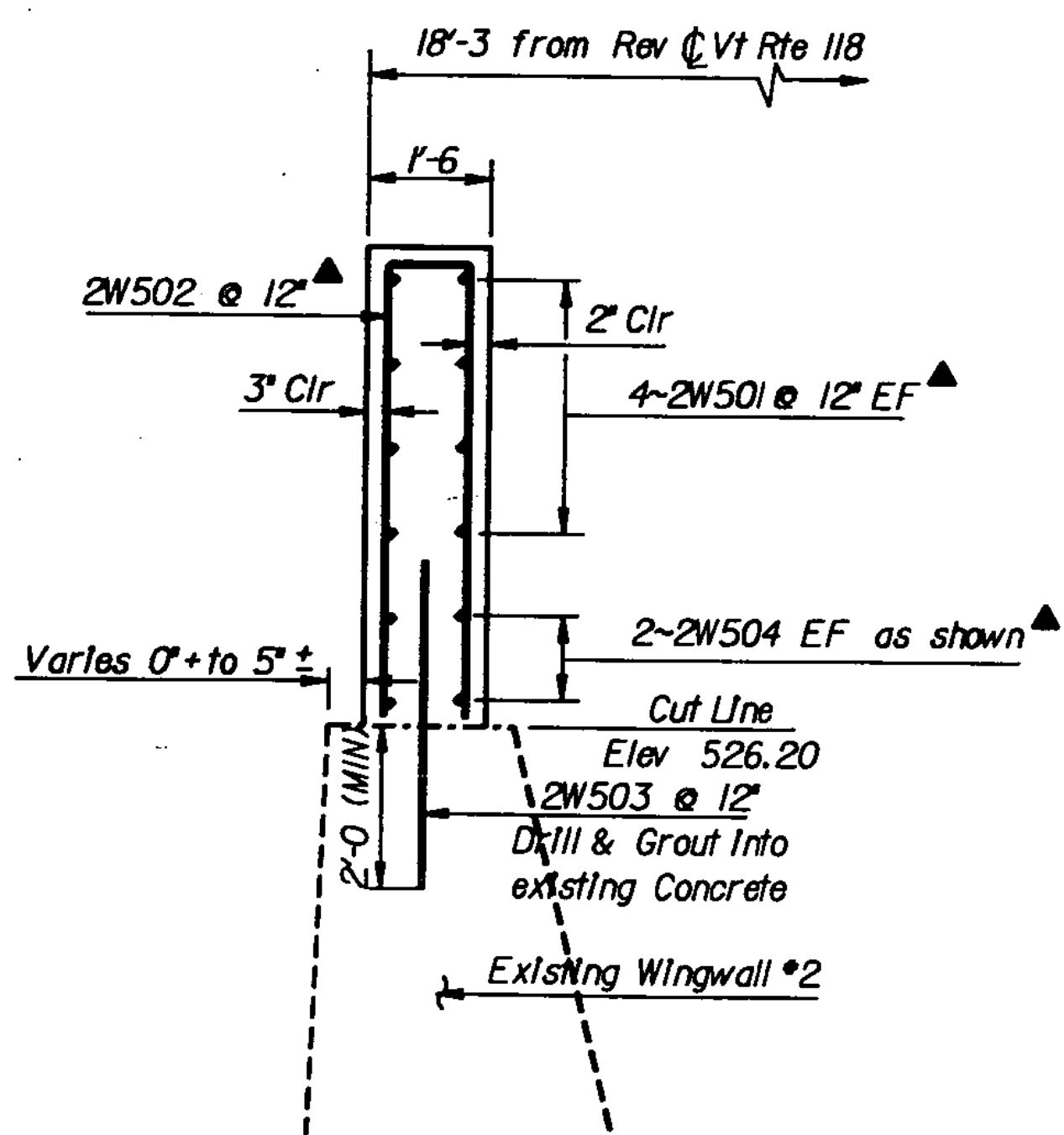

**WINGWALL No 2 TYPICAL SECTION**

Scale 1/2" = 1'-0"

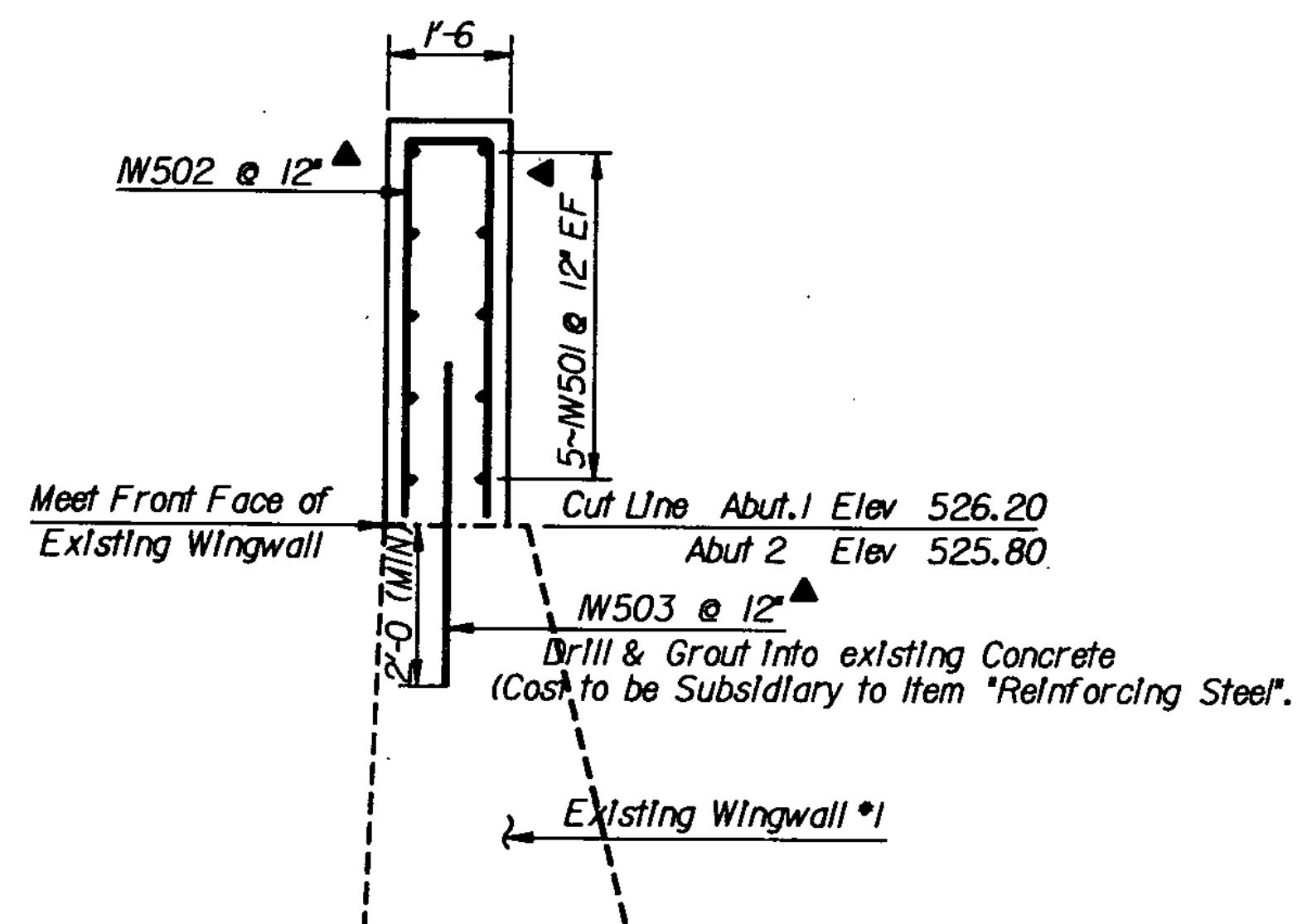

**WINGWALL No 1 TYPICAL SECTION**

(WINGWALL No 4 SIMILAR)

Scale 1/2" = 1'-0"

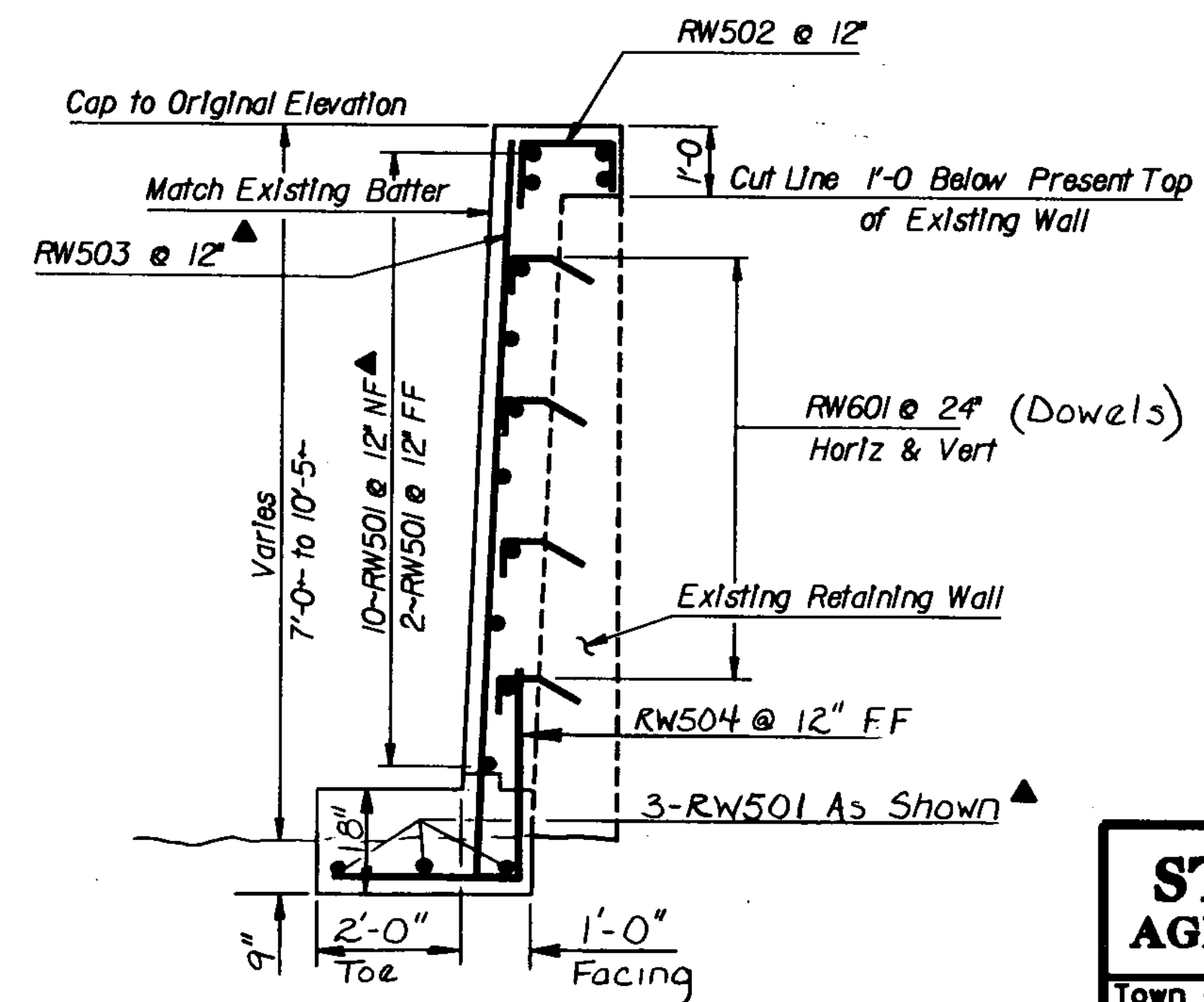

**TYPICAL SECTION - RETAINING WALL @ WINGWALL No. 1**

Scale 1/2" = 1'-0"

**STATE OF VERMONT  
AGENCY OF TRANSPORTATION**

Town Of <b>MONTGOMERY</b>	Bridge No. <b>15</b>
Highway No. <b>Vt Rte 118</b>	Log Sta. <b>296 + 30</b>
	Surv. Sta. <b>REV 55 + 62.85</b>
<b>Vt Rte 118 over the Trout River</b>	

Wingwall No. 1 & 2 Details

Designed By <b>R. Sikora</b>	Drawn By <b>E. Blodgett</b>
Checked By <b>R. Sikora</b>	Date <b>8/84</b>
	Bridge Design Supervisor <b>F.V. Bolcum</b> Date <b>12/84</b>

PROJECT <b>MONTGOMERY</b>	PROJECT NO. <b>BHS 02831615</b>
---------------------------	---------------------------------

L&C. Info. <b>QSA# 3023178E151ABLDGN</b>	
Bridge Sheet No.	Sheet <b>15</b> of <b>46</b>