

FINAL SURVEY	SURVEYED	DATE
PLOTTED	BY	
NO. BOOK		
AREAS CHECKED		
NO.		

ORIGINAL SURVEY	SURVEYED	DATE
PLOTTED	BY	
NO. BOOK		
AREAS CHECKED		
NO.		

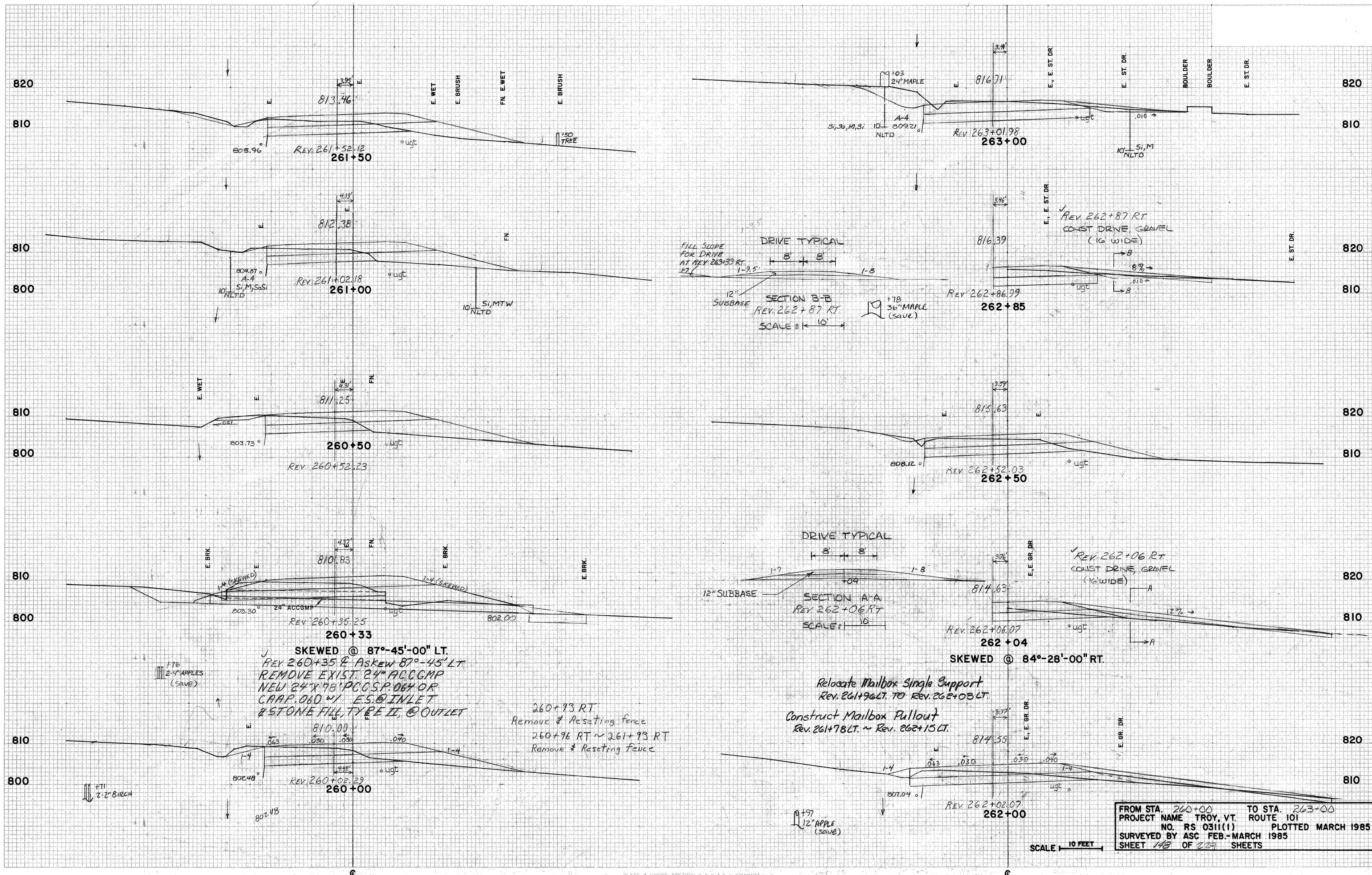

SKEWED @ 87°-45'-00" LT
 REV 260+35 & ASKEW 87°-45' LT
 REMOVE EXIST. 24" ACCGMP
 NEW 24" X 78" PCGSP 064 OR
 CARP. 060 w/ ES @ INLET
 & STONE FILL, TYPE II, @ OUTLET

260+93 RT
 Remove & Resetting fence
 260+96 RT ~ 261+93 RT
 Remove & Resetting fence

Relocate Mailbox Single Support
 Rev. 261+96 LT. TO REV. 262+03 LT.
 Construct Mailbox Pullout
 Rev. 261+78 LT. ~ Rev. 262+15 LT.

FROM STA. 260+00 TO STA. 263+00
 PROJECT NAME TROY, VT. ROUTE 101
 NO. RS 0311(1) PLOTTED MARCH 1985
 SURVEYED BY ASC FEB.-MARCH 1985
 SHEET 148 OF 209 SHEETS

SCALE 1" = 10 FEET