

TEMPORARY 4" REFLECTORIZED YELLOW
(DOUBLE SOLID LINE)
172+00 - 188+00 ±

TEMPORARY 4" REFLECTORIZED WHITE LINES
(FINAL COURSE ONLY) EDGE LINES
172+00 - 188+00 12' LT. & RT.

REMOVING SIGNS
182+09 RT. (2)

TOTAL THIS SHEET 2

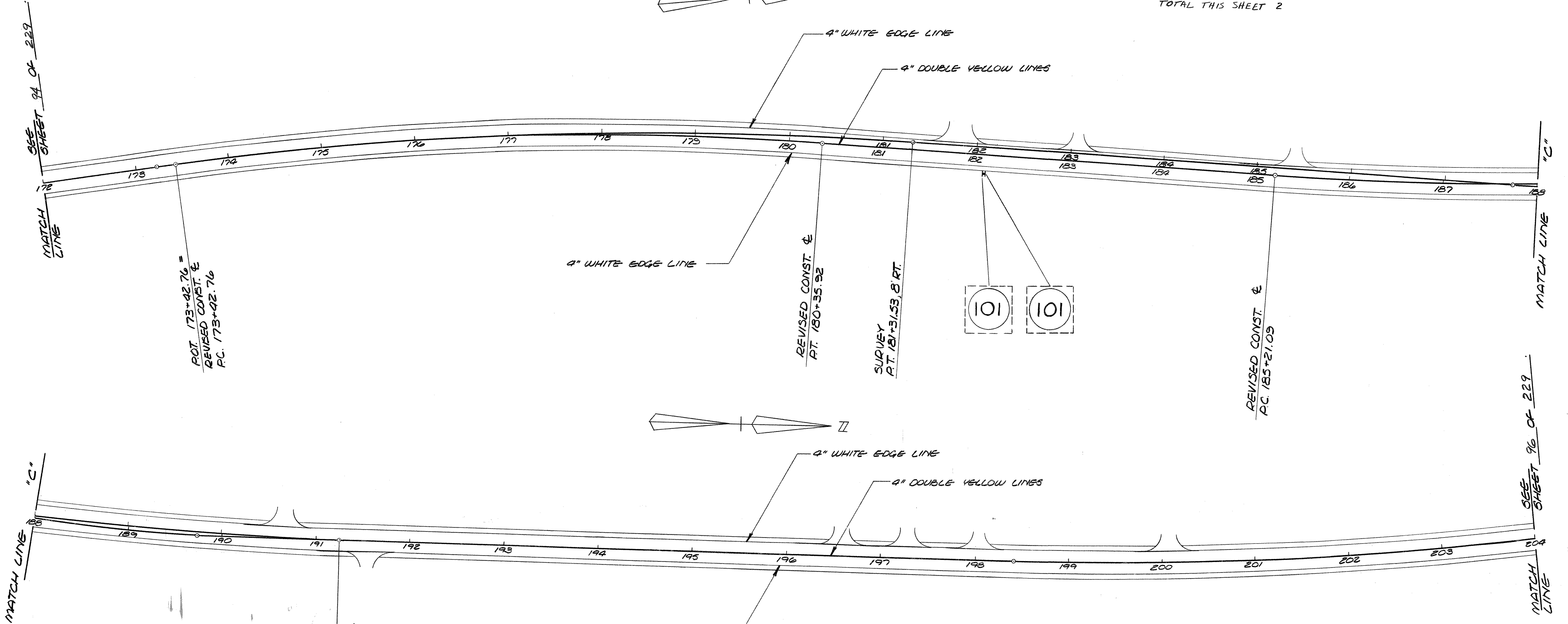
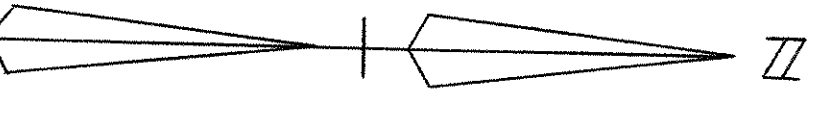
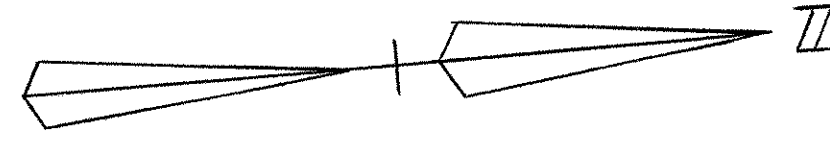

ROT. 173+02.76 =
REVISED CONST. &
P.C. 173+02.76

REVISED CONST. &
P.T. 180+35.92

SURVEY
P.T. 181+31.53, 8 RT.

REVISED CONST. &
P.C. 185+21.05

REVISED CONST. &
P.T. 191+24.62 =
P.O.T. 191+25.23, SURVEY
EQUATION = -0.61'

TEMPORARY 4" REFLECTORIZED YELLOW
(DOUBLE SOLID LINE)
188+00 - 204+00 ±

TEMPORARY 4" REFLECTORIZED WHITE LINES
(FINAL COURSE ONLY) EDGE LINES
188+00 - 204+00 12' LT. & RT.

NOTE: REMOVE ALL EXISTING SIGNS UNLESS OTHERWISE NOTED
TYPE "A" SIGN REMOVAL
CENTERLINE MARKINGS (DOUBLE YELLOW LINE) SHALL BE
APPLIED USING TEMPORARY MARKINGS ON EACH
PAVEMENT COURSE. QUANTITIES REFLECT THREE APPLICATIONS.

SCALE: 1" = 50 FEET

SIGN LOCATION AND
PAVE. MARKING SHEET

SURVEYED BY	DATE
DRAWN BY <u>LL/GAS</u>	DATE <u>08-85</u>
TRACED BY <u>TUB/PAM</u>	DATE <u>08-85</u>
TOWN <u>TROY, VERMONT</u>	
ROUTE <u>101</u>	
PROJ. RS NO. <u>0311(1)</u>	
SHEET <u>95</u> OF <u>229</u>	