

PLAN  
SCALE: 1" = 50'

**BENCHMARKS**  
 BM14 - IRON ANGLE MARKER IN TOP OF CONC. NEAR 15' x 8" ELM - ELEV. 841.37  
 BM15 - S.I.T. 2" PINE, EAST SIDE OF RTE 101 - ELEV. 827.29  
 NOTE: BENCHMARKS ARE PROVIDED FROM THE STATE OF VERMONT PLANS FOR ROUTE 101, TOWN OF VERMONT (PROJ. #0311(1))

138+85 RT.  
 CHANGE ELEVATION OF MANHOLE AND EXISTING VENT PIPE AS DIRECTED BY OWNER.  
 THIS WORK TO BE PAID FOR UNDER ITEM 604.40 - CHANGING ELEVATIONS OF DROP INLETS, CATCH BASINS, OR MANHOLES

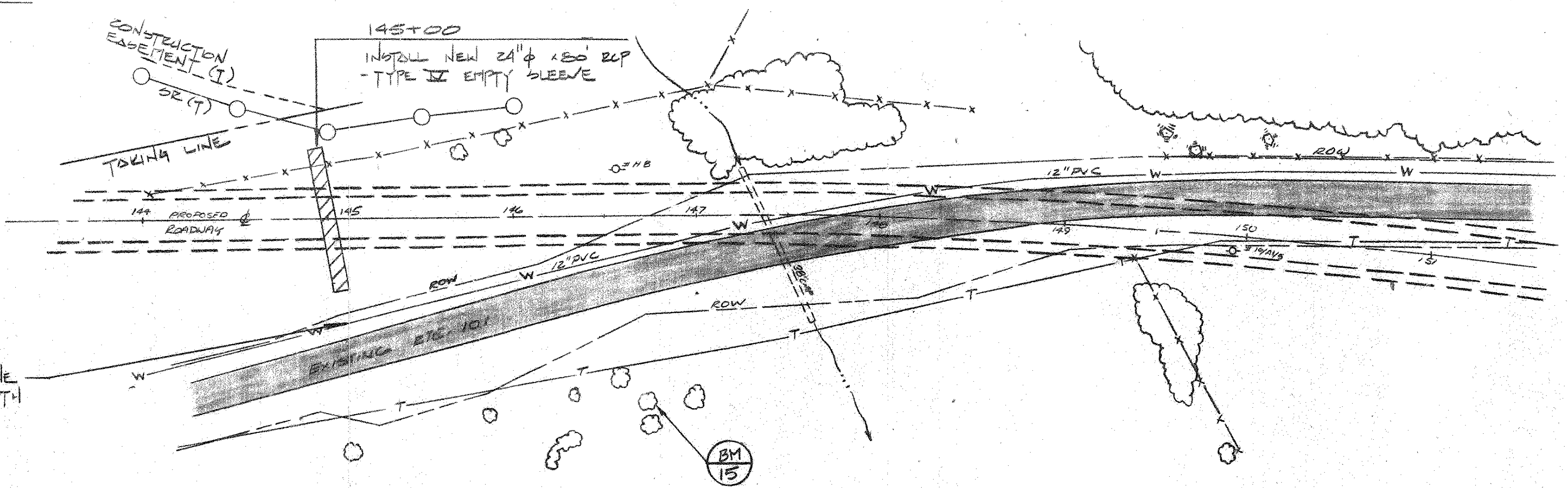

PLAN  
SCALE: 1" = 50'

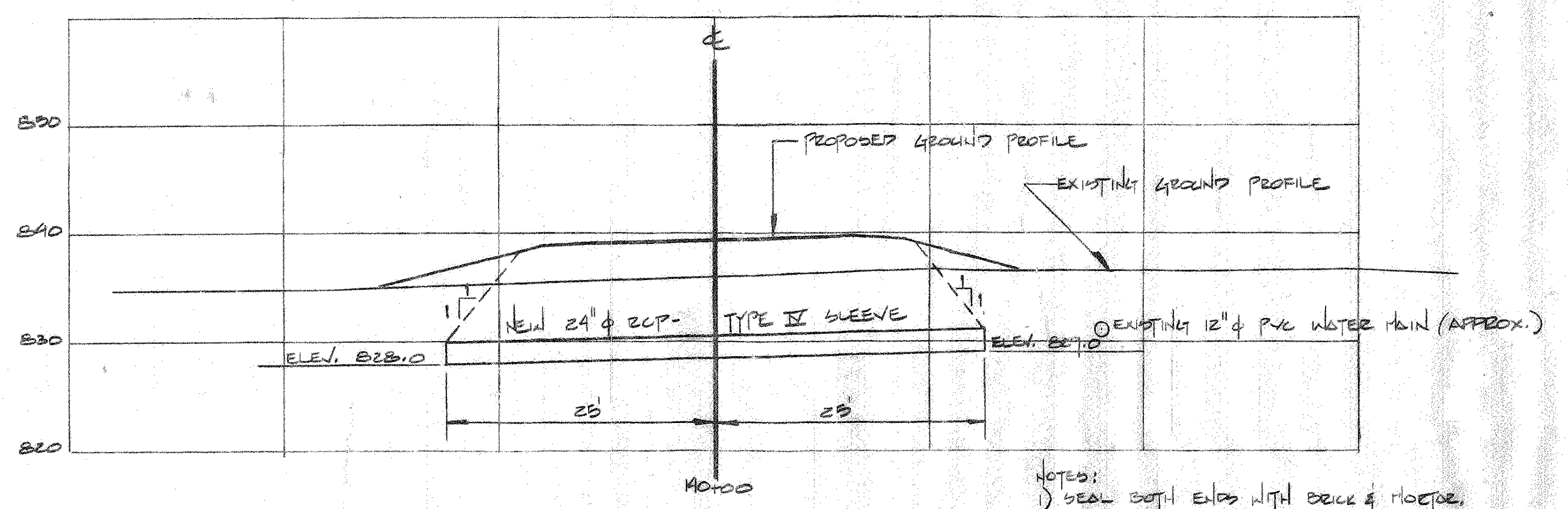

SECTION  
SCALE: 1" = 10' HOR.  
1" = 10' VERT.

NOTES:  
 1) SEAL BOTH ENDS WITH BRICK & MORTAR.  
 2) PROVIDE A DEEP HOLE AT THE LOW END OF THE SLEEVE.

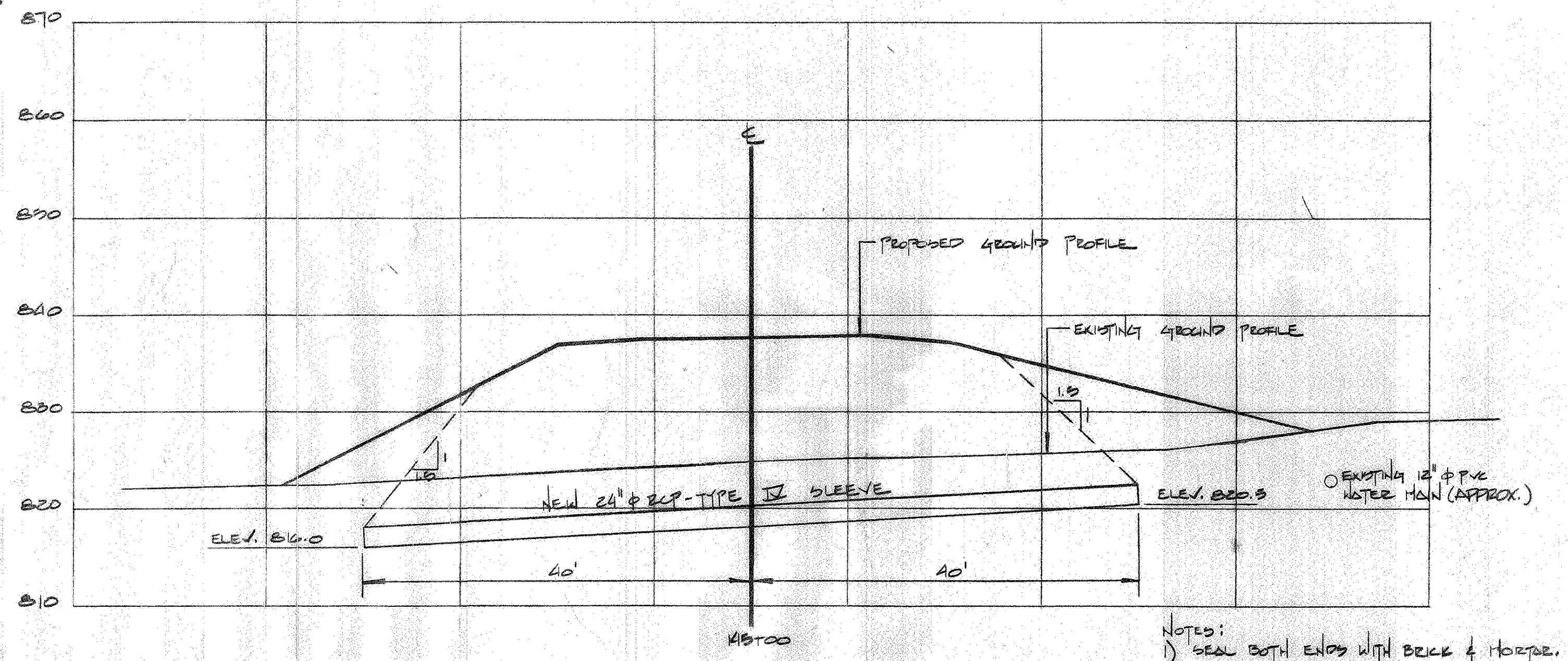

SECTION  
SCALE: 1" = 10' HOR.  
1" = 10' VERT.

NOTES:  
 1) SEAL BOTH ENDS WITH BRICK & MORTAR.  
 2) PROVIDE A DEEP HOLE AT THE LOW END OF THE SLEEVE.

	24 Milliken Place P.O. Box 784 Winooski, VT 05415-0784 (802) 878-7733 (802) 878-1742 (fax)	Phillip J. Lombardi Public Consulting Geologist Geom Associates Landscape Engineering	PLAN & CROSS SECTIONS NEW WATER MAIN SLEEVES ROADWAY STATIONS 140+00 & 145+00	DESIGNED WEE	PROJECT NO. 8836
			WATER MAIN RELOCATIONS TOWN OF TROY, VERMONT	DRAWN STS	DRAWING NO. 4
DATE FIELD 1990			CHECKED BCW	SHEET 4 OF 5	