

LATERAL BRACING LAYOUTS @ 16" BTM FLANGE

(PANEL G1-G2 SHOWN)
(PANEL G4-G5 SIMILAR)

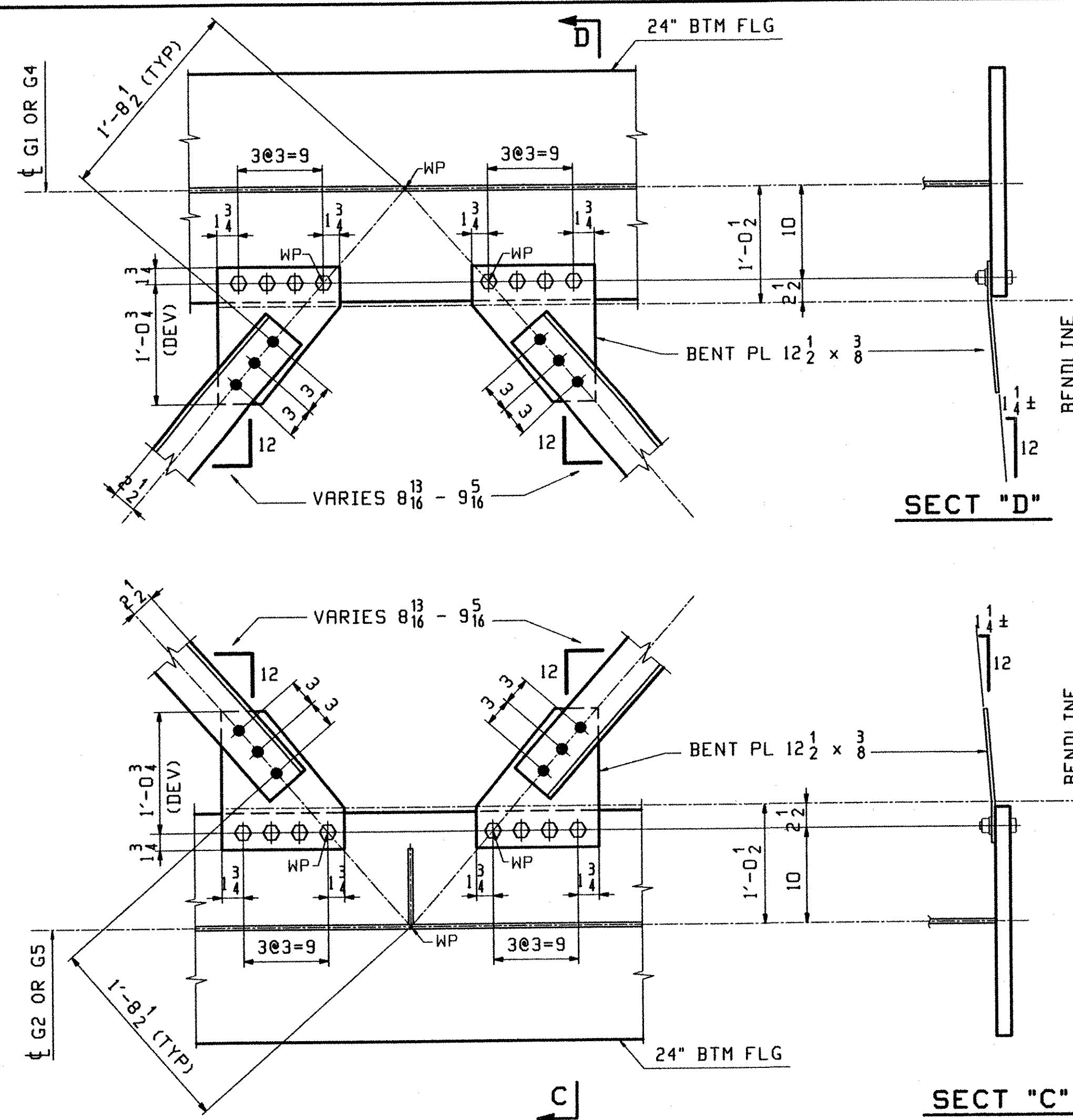

LATERAL BRACING LAYOUTS @ 24" BTM FLANGE

(PANEL G1-G2 SHOWN)
(PANEL G4-G5 SIMILAR)

**** NOTE ****
THE PURPOSE OF THIS DRAWING IS TO COORDINATE GEOMETRIC CONTROL INFORMATION AND CONNECTION SPACING. THIS DWG IS SUBMITTED FOR INFORMATION ONLY & IS NOT INTENDED FOR SHOP FABRICATION. DETAIL DWGS WILL SHOW ALL WELDING AND DIMENSIONS REQ'D FOR FABRICATION.

- NOTES:
- EDGE DISTANCES SHALL BE 1 1/4" (UN).
 - SEE DESIGN SHEET BR317 INFORMATION NOT SHOWN.

OUT FOR APPROVAL	9902									
OUT FOR APPROVAL										
ISSUED TO SHOP										
FIELD & OFFICE										

REV.	REMARKS	DATE	DWN	CHK	APP	Q.A.	NO.	DIA.	LGTH	TYPE	WASHER
MATERIAL:	ELECTRODES:	HOLES:	SHOP BOLTS:								
M270-50W		15/16" (UN)	7/8" A325-3								

SURFACE PREP. & PAINT:
-STEEL WITHIN 10'-0" ENDS OF GIRDERS SHALL BE PAINTED (SEE GNI)
-ALL OTHER STEEL SHALL BE BLAST CLEANED AND LEFT UNPAINTED.

DESCRIPTION:	LATERAL BRACING LAYOUTS	DRAWN BY	DATE
JOB:	VT RTE 9 OVER THE DEERFIELD RIVER	WL	07/17
	BRIDGE NO. 25A	CHKD BY	
	SEARSBURG, VERMONT	DO	08/03
	CONTRACTOR: J.A. McDONALD	APPROV BY	
		SUPERVISOR	H. J. GATTI
PROJ NO.	PROJ. NHF 010-1(18)	Q.A.	

CUSTOMER:	VERMONT AGENCY OF TRANSPORTATION	JOB NO.	DRG. NO.
		166	TD3
		REV.	△

RECEIVED
SEP 09 2002
BY RW DATE 9-27-02