

ABUT # 2

ABUT # 2

BRIDGE 24 SEABURG - WILMINGTON
SECTION 114-F010-1118
SCALE: 1:5 XBR24-1

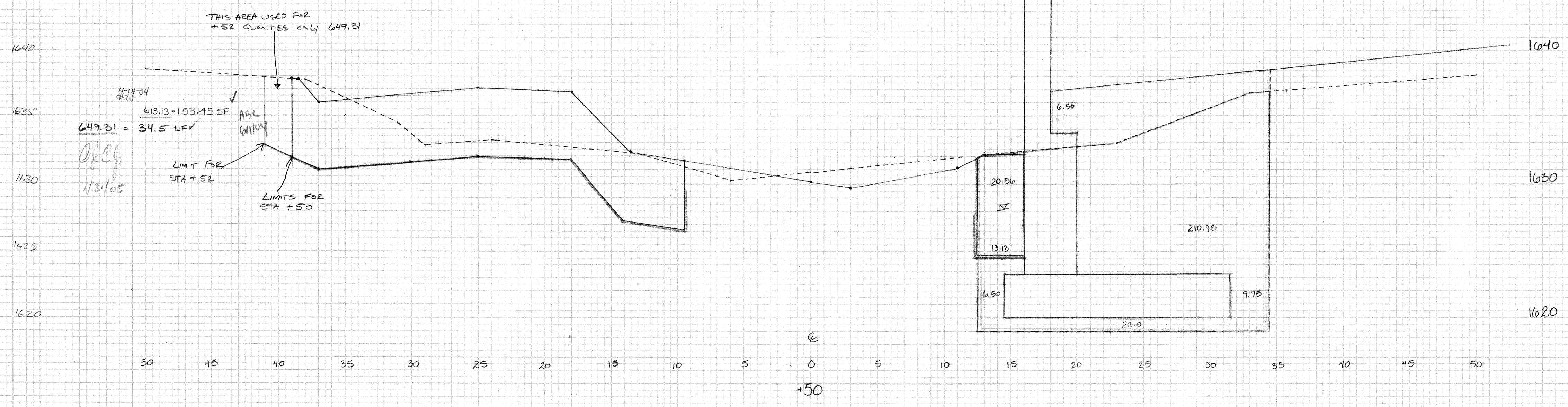

$204.30 \cdot 18.13 \cdot 6.50 = 246.86 \text{ sq. ft. } \frac{1}{15} = 16.46$
 $208.30 \cdot 141.75 \cdot 158.00 \cdot 26.55 = 326.30 \text{ sq. ft.}$
 $613.13 \cdot 22.0 = 13489.06 \text{ sq. ft.}$
 $4-14-04$
 $13.13 \cdot 22.0 = 288.86 \text{ sq. ft.}$
 $12-7-04$
649.31 BUTT = 6.5 LF

PER PLAN AND R.E. NO. 4'-0"
 BELOW BIT. CONC., JUST GO
 4'-9 3/4" FROM F.G. FOR
 SF PER R.E. AS WELL

36.5 LF BUTT 649.31 +S2 ABUT #1
 11/3/05

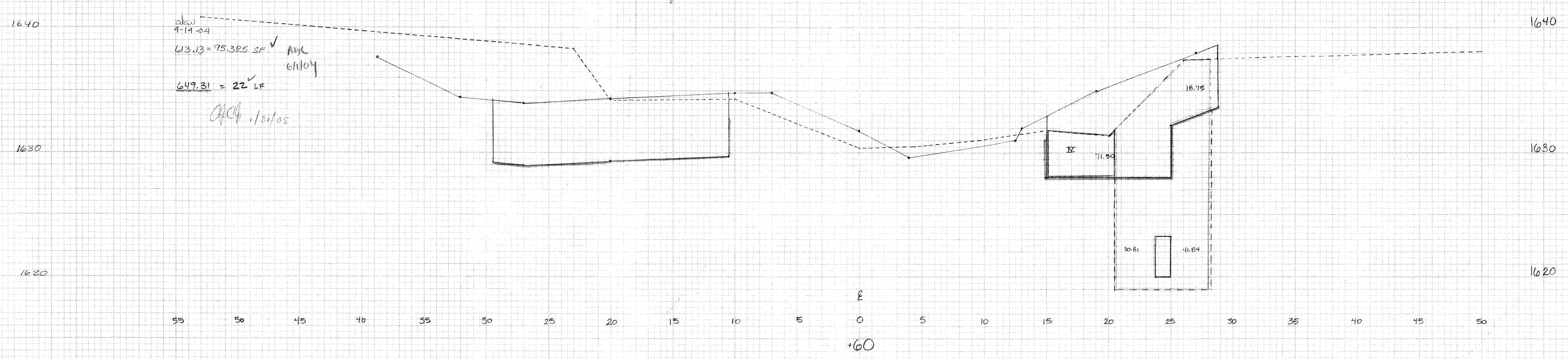

$4-14-04$
 $204.30 \cdot 30.81 \cdot 41.84 = 2646.88 \text{ sq. ft.}$
 $208.30 \cdot 86.08 \cdot 41.74 = 748.82 \text{ sq. ft.}$
 $613.13 \cdot 11.50 \cdot 18.75 = 90.25 \text{ sq. ft.}$
 $11-14-04$
649.31 = 21 LF

ALL CONCRETE EXCAVATION TO BE PAID AS
 EARTH, PER AGREEMENT WITH THE PRIME.

+67
268.0 649.31

+67
BUTT 649.31
SAME AS +60 = 21 LF

11/3/05

ORIGINAL SURVEY
 DATE: _____
 BY: _____
 CHECKED: _____
 DATE: _____
 BY: _____

ORIGINAL SURVEY
 DATE: _____
 BY: _____
 CHECKED: _____
 DATE: _____
 BY: _____