

DATE	
BY	
FINAL SURVEY	SURVEYED
NOTE BOOK	PLOTTED
NO.	TEMPLATE
	AREAS CHECKED

DATE	
BY	
ORIGINAL SURVEY	SURVEYED
NOTE BOOK	PLOTTED
NO.	TEMPLATE
	AREAS CHECKED

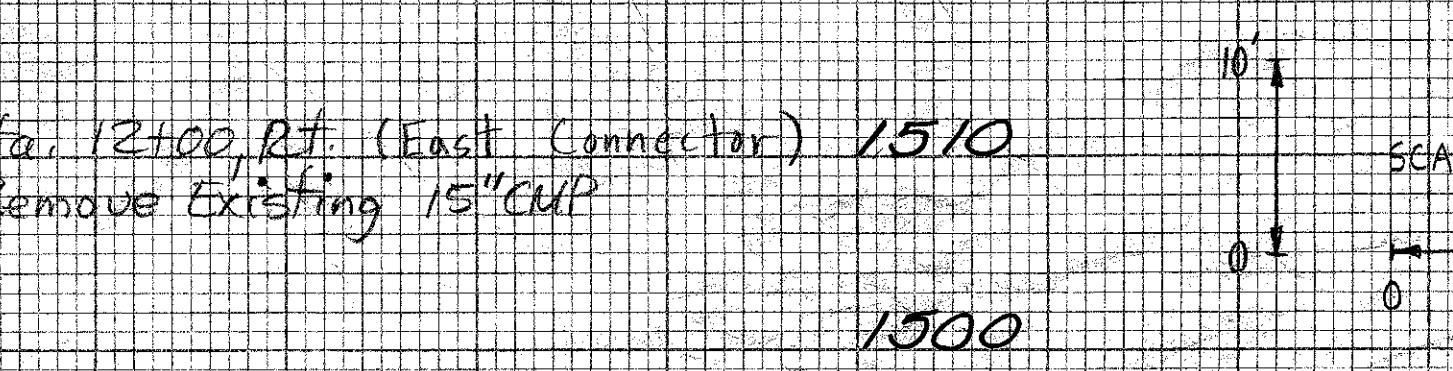
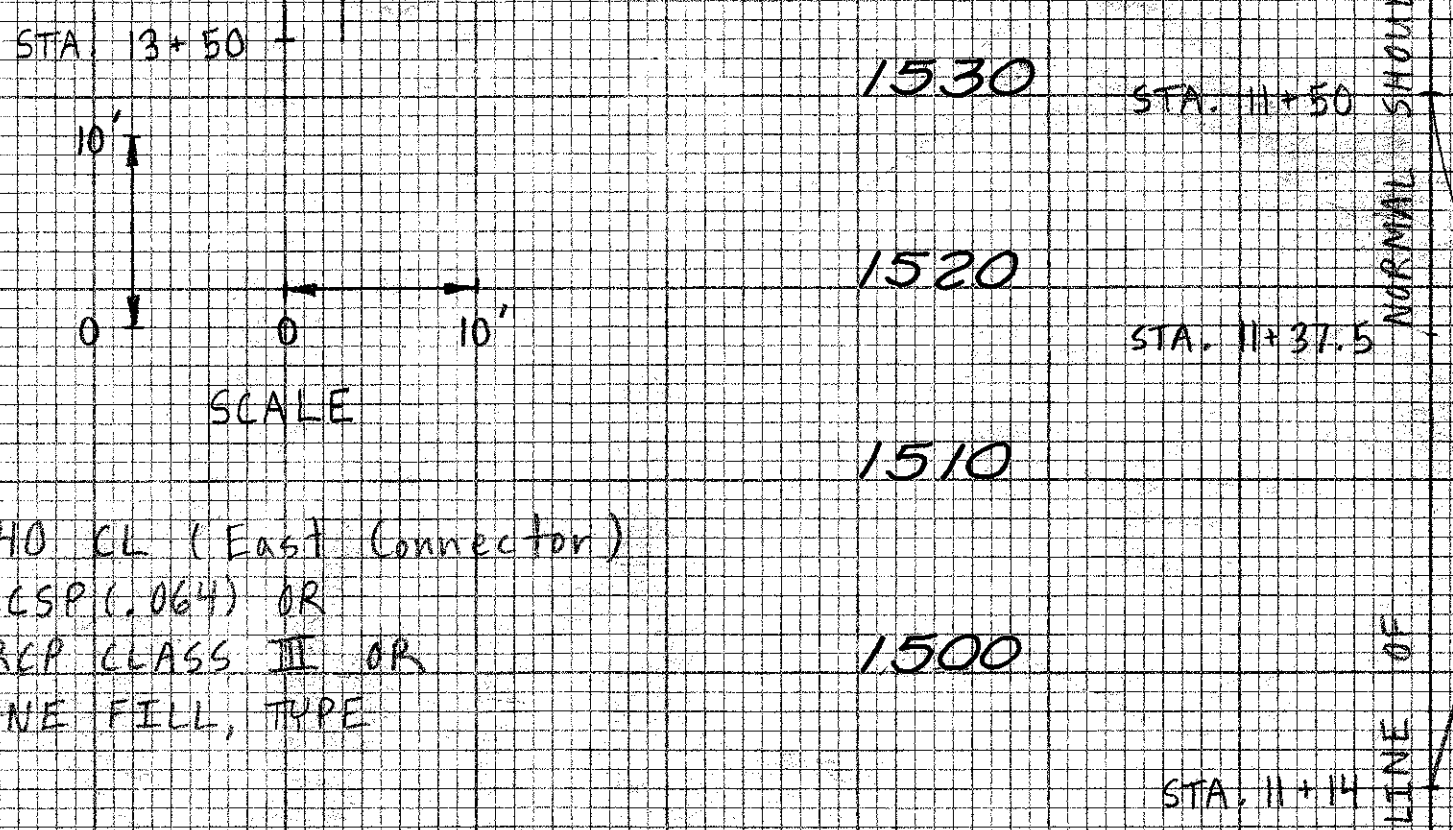
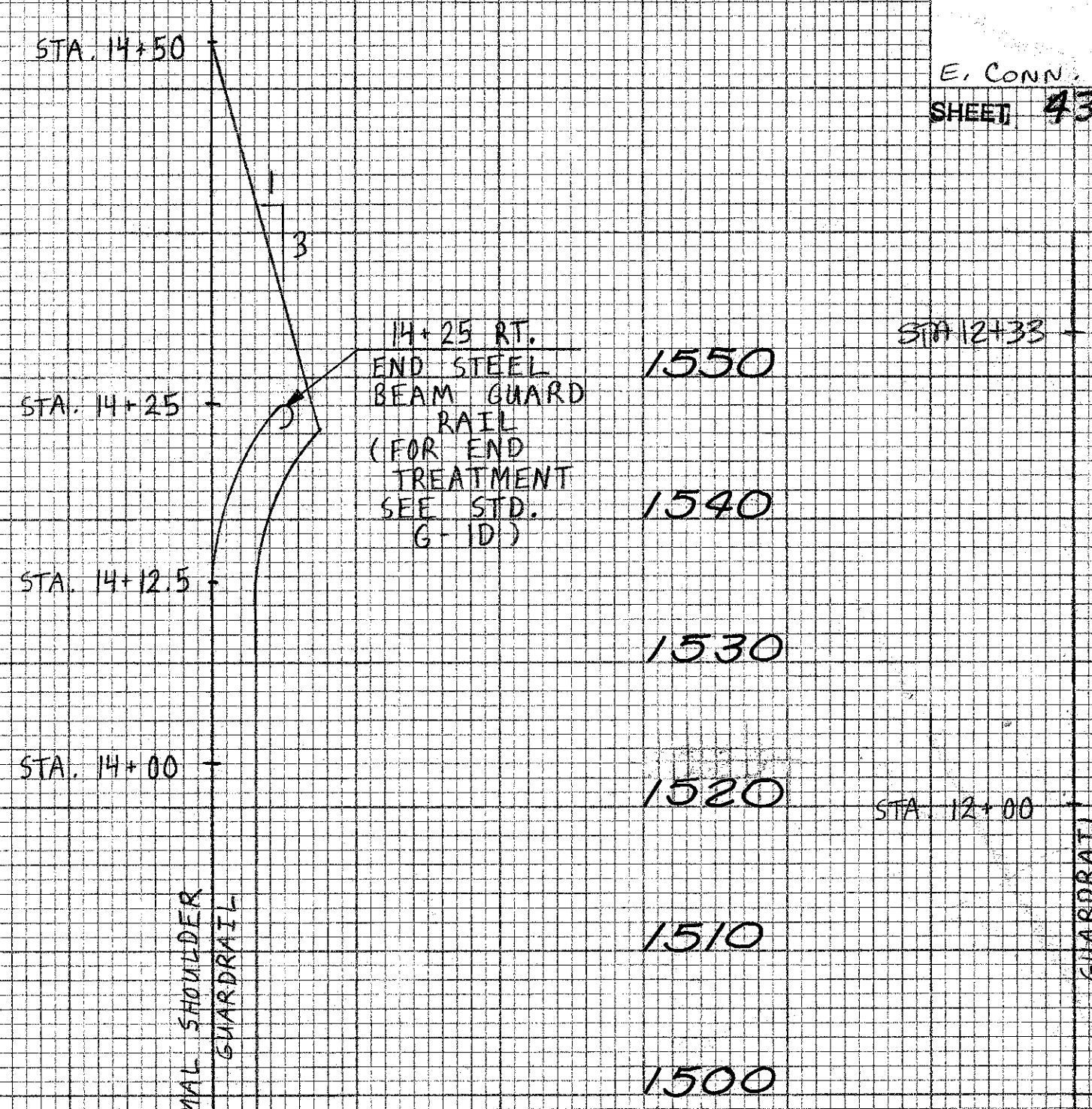
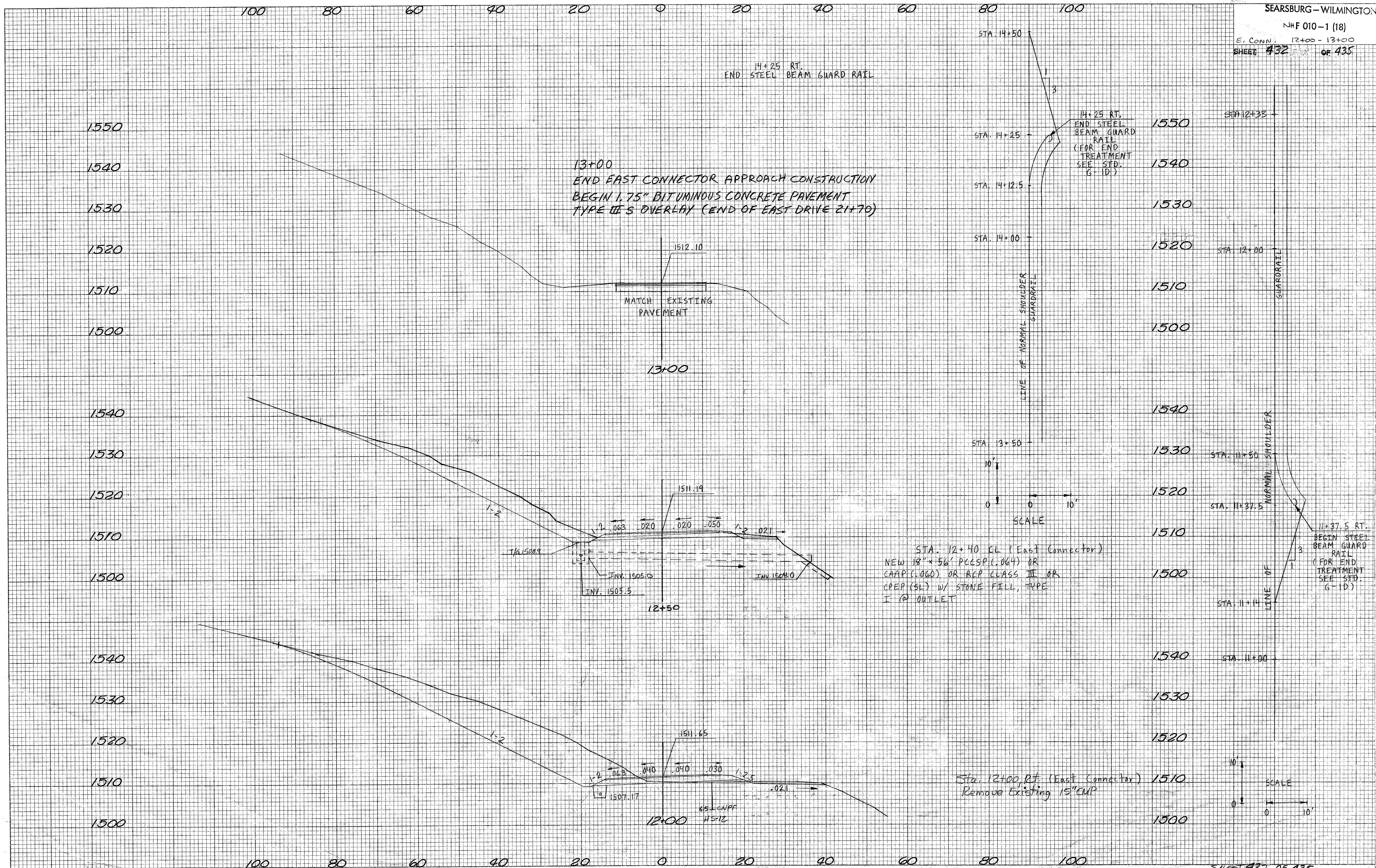

13+00
 END EAST CONNECTOR APPROACH CONSTRUCTION
 BEGIN 1.75" BITUMINOUS CONCRETE PAVEMENT
 TYPE III'S OVERLAY (END OF EAST DRIVE 21+70)

14+25 RT.
 END STEEL BEAM GUARD RAIL
 (FOR END TREATMENT SEE STD. G-1D)

11+37.5 RT.
 BEGIN STEEL BEAM GUARD RAIL
 (FOR END TREATMENT SEE STD. G-1D)

STA. 12+40 CL (East Connector)
 NEW 18" x 56' PCCSP (.064) OR
 CAAP (.060) OR RCP CLASS III OR
 CPEP (SL) W/ STONE FILL, TYPE
 I @ OUTLET

Sta. 12+00 RT (East Connector)
 Remove Existing 15" CUP

MATCH EXISTING PAVEMENT

LINE OF NORMAL SHOULDER GUARDRAIL

LINE OF NORMAL SHOULDER

65' L. GNPF 14-12