

DATE: 29 JAN 04
SCALE: 1" = 20'

1530
1520
1530
1520
1530
1520
1530
1520
1530
1520

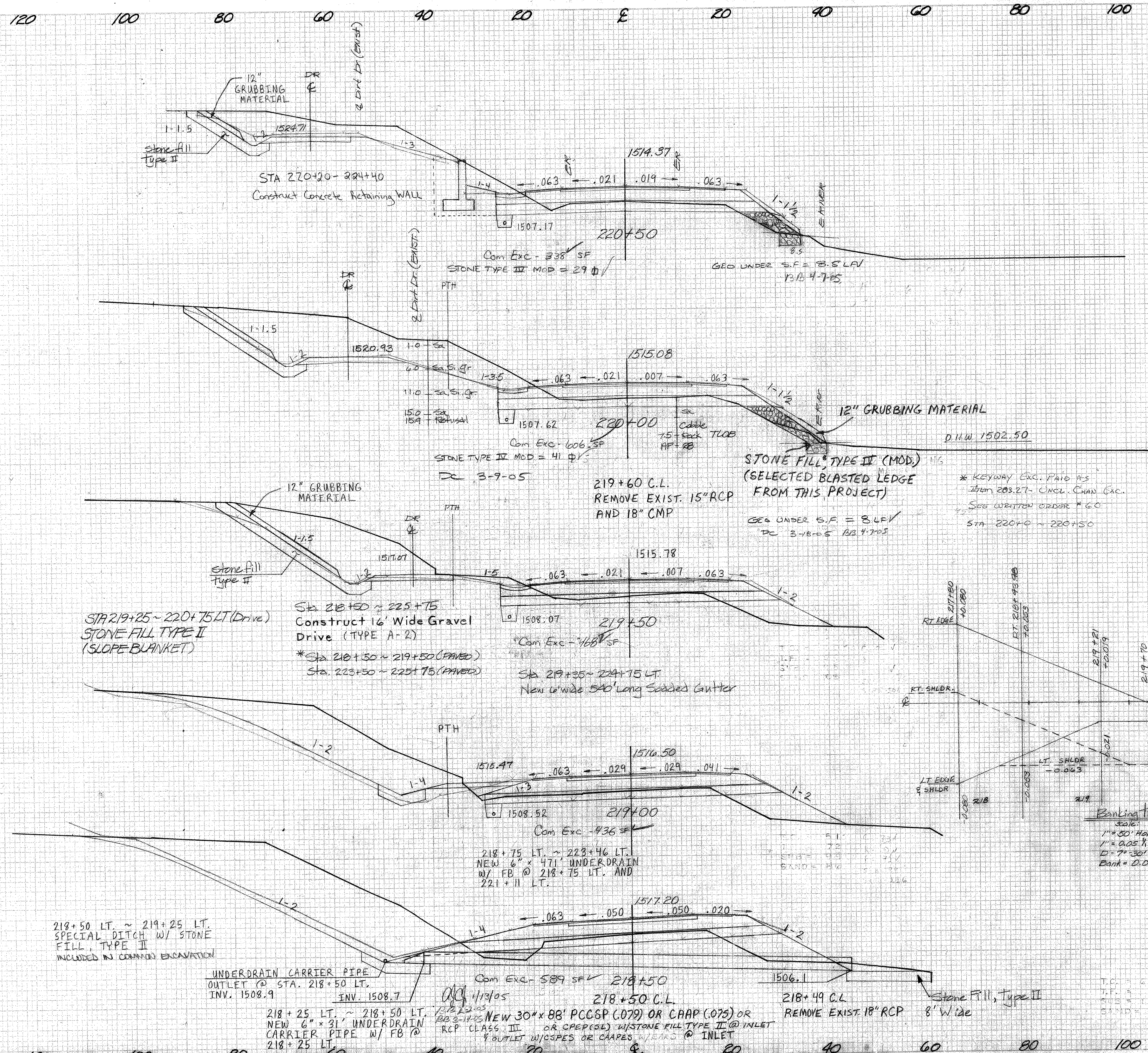

* KEYWAY EXC. PAID AS
ITEM 203.27 - UNCL. CHAN EXC.
SEE WRITTEN ORDER # 60
STA 220+0 ~ 220+50

Banking transition
SCALE:
1" = 50' Horiz.
1" = 0.05' Vert.
D = 70' 30" LT.
Bank = D.000' / FT

T.C. = 4.7
T.F. = 3.0
S.B. = 1.0
SAND = 1.0