

# QUANTITY SHEET

QUANTITY	UNIT	KEY	BOTANICAL NAME	COMMON NAME	SIZE	SPACING	REMARKS	ITEM #
EVERGREEN TREES								656.20
3	EA	LL	LARIX LARICINA	LARCH	4'	15' O.C.		
5	EA	AB	ABIES-BALSAMEA PICEA MARIANA	BALSAM FIR BLACK SPRUCE	4'	15' O.C.		
DECIDUOUS TREES								656.30
8	EA	AR	ACER RUBRUM	RED MAPLE	1' CAL.	15' O.C.		
3	EA	FP	FRAXINUS PENNSYLVANICA	GREEN ASH	1' CAL.	15' O.C.		
3	EA	PD	POPULUS DELTOIDES	COTTONWOOD	1' CAL.	15' O.C.		
7	EA	SN	SALIX NIGRA	BLACK WILLOW	1' CAL.	15' O.C.		
DECIDUOUS SHRUBS								656.35
10	EA	CO	CEPHALANTHUS OCCIDENTALIS	BUTTONBUSH	2'-3'	6' O.C.		
18	EA	CS	CORNUS SERICEA	RED-OSIER DOGWOOD	2'-3'	6' O.C.		
80	EA	CC	CRATAEGUS CRUS-GALLI	COCKSPUR HAWTHORNE	2'-3'	6' O.C.		
45	EA	IV	ILEX VERTICILLATA	WINTERBERRY	2'-3'	6' O.C.		
14	EA	VC	VIBURNUM CASSINOIDES	WILD RAISIN	2'-3'	6' O.C.		
12	EA	VT	VIBURNUM TRILOBUM	HIGHBUSH CRANBERRY	2'-3'	6' O.C.		
16	FACINE	SS	SALIX SERICEA	SILKY WILLOW	6'0, 20' LONG		END TO END IN TRENCH	
GROUND COVER AND VINES								656.35
975	EA	SL	SAGGITARIA LATIFOLIA	DUCK POTATO	2' PEAT POT OR BARE ROOT	4' O.C.		
6,550	EA	PA	POLYGONUM AMPHIBIUM	WATER SMARTWEED	2' PEAT POT OR BARE ROOT	2' O.C.		
3700	EA	SA	SCIRPUS ACUTUS	HARDSTEM BULRUSH	2' PEAT POT OR BARE ROOT	2' O.C.	4' O.C. WHEN MIXED W/NL	
4242	CUTTING	SS	SALIX SERICEA	SILKY WILLOW	12'	6' O.C.	UNROOTED CUTTING	
WETLAND SEEDS								651.15
28,40	LB	SE	SECALE CEREALE	WINTER RYE	SEED	10 LB/ACRE		
2.25	LB	RB	NONE	NEW ENGLAND RUSH/BULRUSH MIX	SEED	1LB/ACRE	SOLE SOURCE: *ST	

NOTE: ALL PLANTS TO BE OBTAINED FROM NURSERIES LOCATED IN NEW ENGLAND EXCEPT NEW ENGLAND RUSH/ BULRUSH MIX.  
 \* ST = SOUTHERN TIER CONSULTING INC, P.O. BOX 30, WEST CLARKSVILLE NY 14786

NEW ENGLAND RUSH/BULRUSH SEED MIX		
PERCENT BY NUMBER OF SEEDS (NOT BY WEIGHT)	BOTANICAL NAME	COMMON NAME
37.3%	JUNCUS EFFUSUS	SOFT RUSH
34.4%	SCIRPUS ATROVIRENS	DARK GREEN BULRUSH
26.9%	SCIRPUS CYPERINUS	WOOLGRASS
1.3%	SCIRPUS TABERNAEMONTANI	SOFT STEM BULRUSH
0.1%	SCIRPUS PUNGENS	THREE SQUARE BULRUSH

APPROXIMATE SUMMARY OF QUANTITIES			
QUANTITY	UNIT	ITEMS	ITEM NO.
5	EA	REMOVE SMALL TREES (MOD- DEAD TREES)	201.15
13602	CY	COMMON EXCAVATION	203.15
50	CY	SOLID ROCK EXCAVATION	203.16
28	YD	SAND BORROW (MOD-POTENTIAL TURTLE NESTING AREAS)	203.31
1	EA	REMOVAL OF STRUCTURE (MODIFIED)	529.15
10	MGAL	DUST CONTROL WITH WATER	609.10
1	EA	GUIDE POSTS (MOD-LOG BERM HEMLOCK OR HARDWOOD)	621.85
661	SY	GEOTEXTILE FOR SILT FENCE	649.51
3.8	LB	SEED (MOD.- NEW ENGLAND RUSH/BULRUSH MIX)	651.15
38	LB	SEED - (WINTER RYE)	651.17
9.5	T	HAY MULCH (MODIFIED)	651.25
2585	CY	TOPSOIL	651.35
125	SY	GRUBBING MATERIAL (MODIFIED)	651.40
400	SY	EROSION MATTING	651.10
8	EA	EVERGREEN TREES	656.20
21	EA	DECIDUOUS TREES	656.30
201	EA	DECIDUOUS SHRUBS	656.35
15466	EA	GROUND COVER AND VINES	656.40

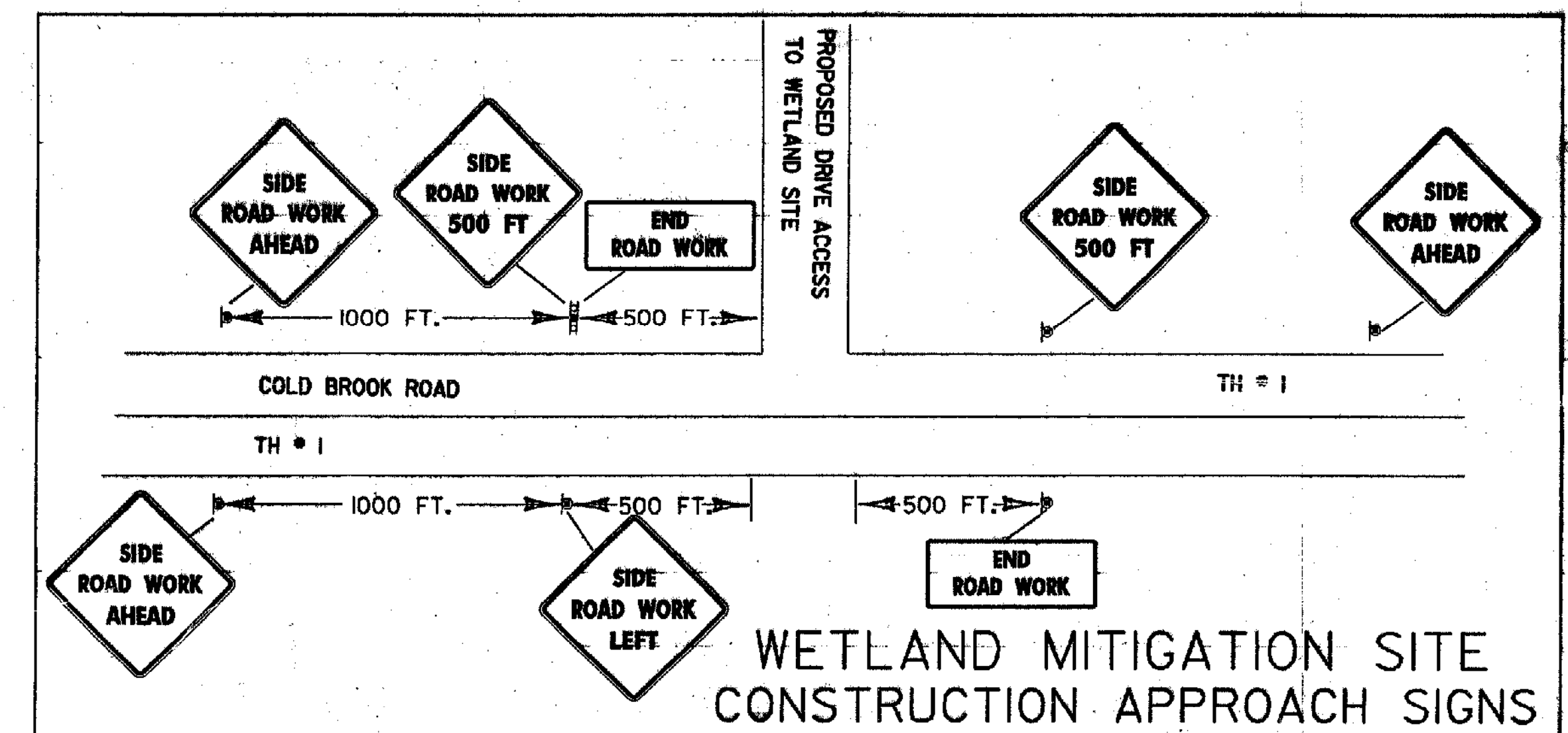

## PROPOSED WETLAND MITIGATION QUANTITY SHEET

PROJECT: <b>SEARSBURG - WILMINGTON</b>	PROJECT NO.: <b>NHF 010-100</b>
DESIGN FILE NAME: IPARM FILE NAME: ZD0960S	PLOT DATE: ****DATE***
SQUAD LEADER: C. W. BRODIE	SURVEY DATE:
	DRAWN BY: K. R. KOLOSKI
	SHEET: 1 OF 12

DATUM  
VERTICAL \_\_\_\_\_  
HORIZONTAL \_\_\_\_\_