

THIS SHEET IS FOR EROSION CONTROL USE ONLY

(S-F) DENOTES GEOTEXTILE FOR SILT FN. & HAY BALES.
 GEOTEXTILE FOR SILT FENCE & HAY BALES
 285+50 RT. ~ 292+50 RT

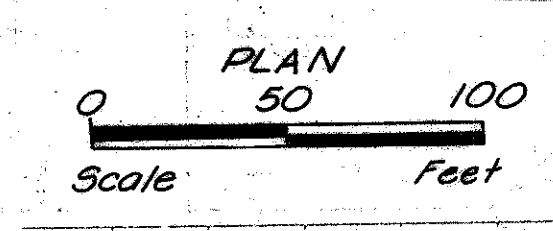
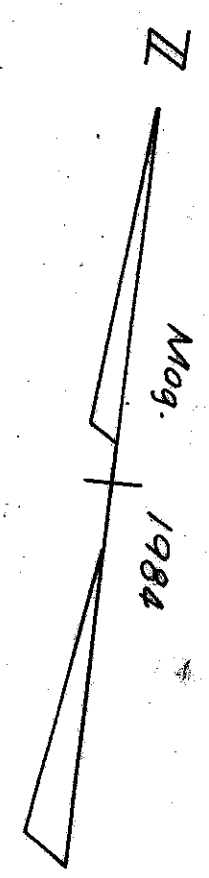
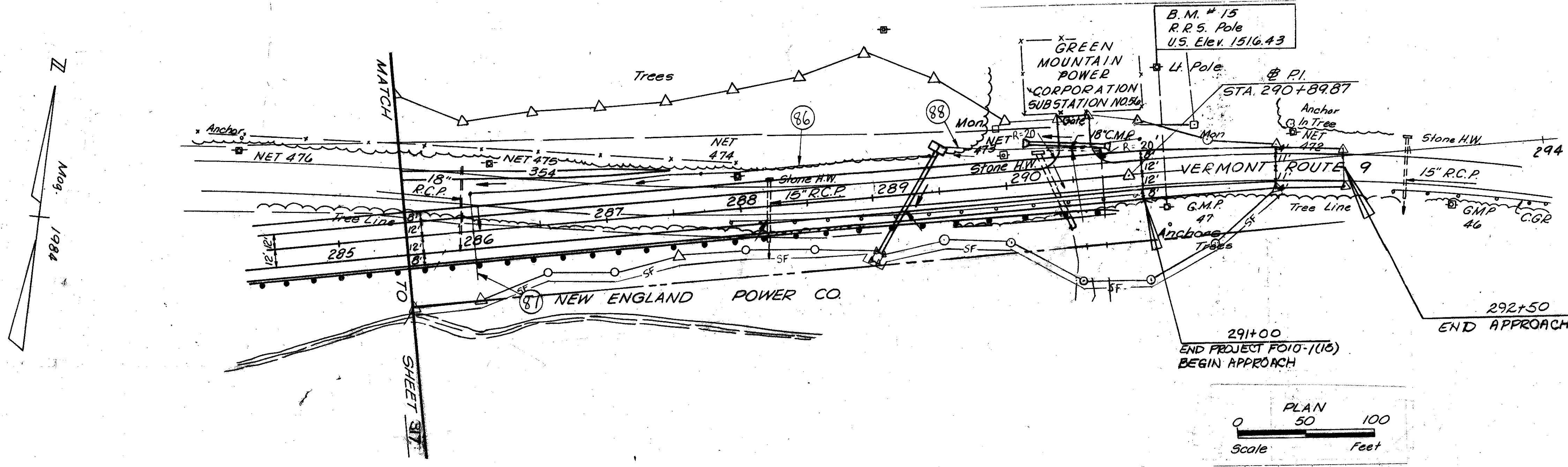

BALED HAY IN DITCHES
 285+00 LT ~ 289+00 LT

THIS DETAIL SHALL
 BE USED IN ALL
 DITCHES

HAY BALE

DETAIL # 3.

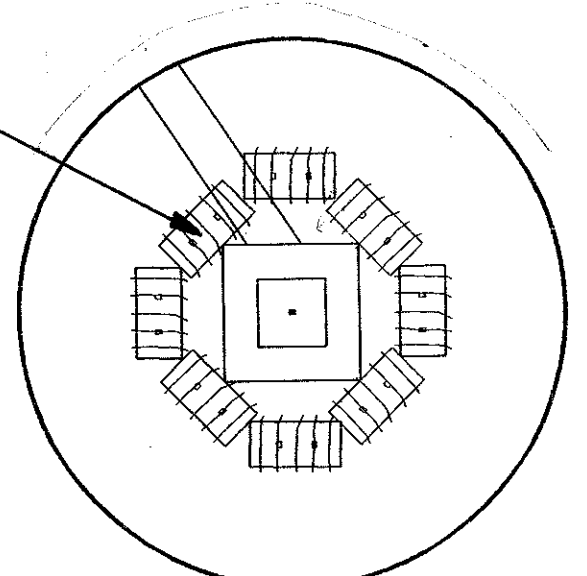

THIS DETAIL SHALL BE USED
 AT ALL DROP INLET LOCATIONS

DETAIL # 10.

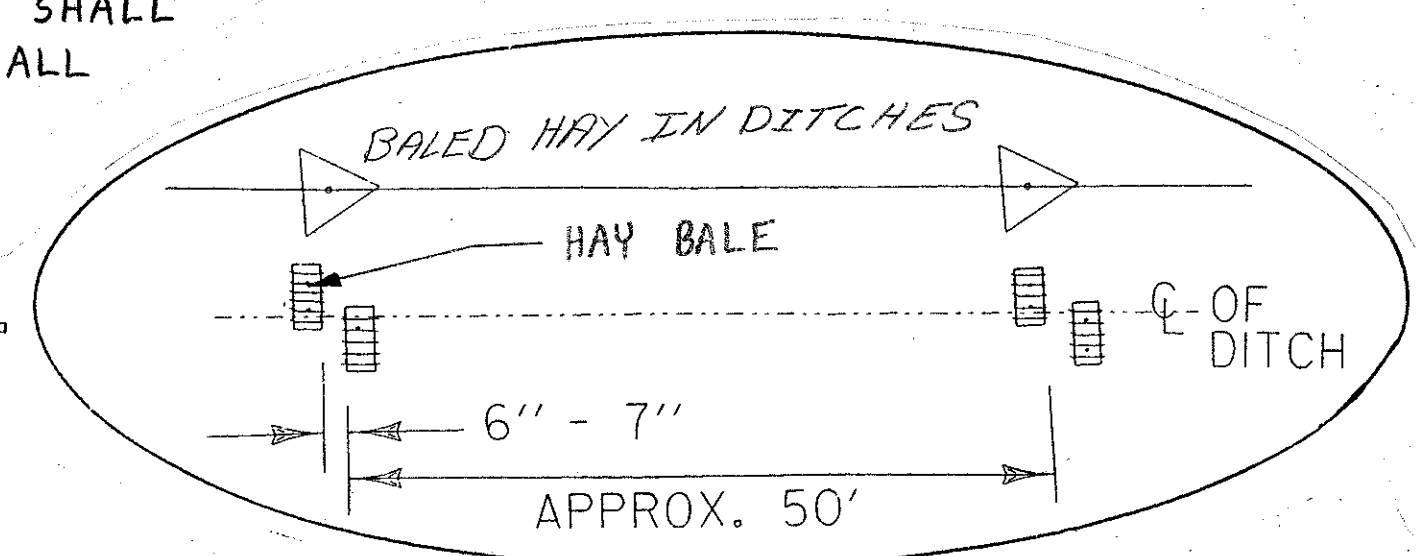

GENERAL NOTES

1. EROSION CONTROL MATERIALS WILL BE PLACED AS ILLUSTRATED ON NEWLY CONSTRUCTED AREAS AS SOON AS POSSIBLE.
2. DURING CONSTRUCTION EVERY EFFORT WILL BE MADE TO KEEP DEBRIS AND SEDIMENT OUT OF THE DITCH. HAY BALES WILL BE USED AS ILLUSTRATED TO INSURE BANK STABILITY.
3. THE HAY BALES SHALL BE INSPECTED AND CLEANED AS NEEDED.

PROJECT: SEARSBURG - WILMINGTON	PROJECT NO.: NH F 010-1(18)
SQUAD LEADER: DELLA SANTA	DRAWN BY: SQUAD B
SHEET: 318 OF 435	