

THIS SHEET IS FOR EROSION CONTROL USE ONLY

CURVE DATA
 $\Delta = 91^\circ - 18' - 19''$ LT
 D = 7°-30'
 R = 763.94'
 T = 781.54'
 L = 1217.40'
 E = 328.95'
 BANK: 0.070 FT./FT.

WEST CONNECTOR CURVE DATA
 $\Delta = 41^\circ - 39' - 27.30''$ RT
 D = 19°-05'-54.94''
 R = 300'
 T = 114.13'
 L = 218.12'
 E = 20.88'

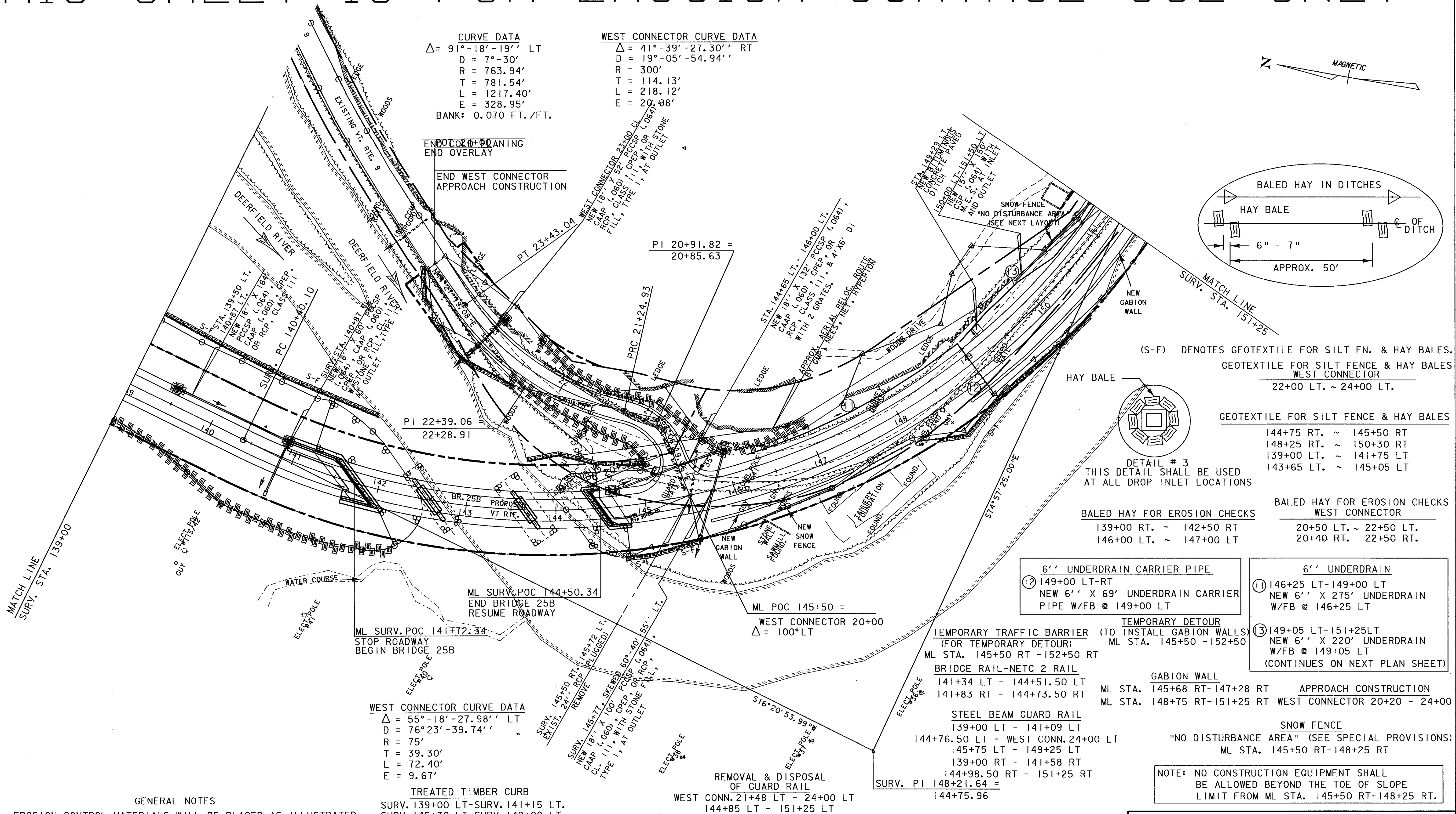

MATCH LINE
 SURV. STA. 139+00

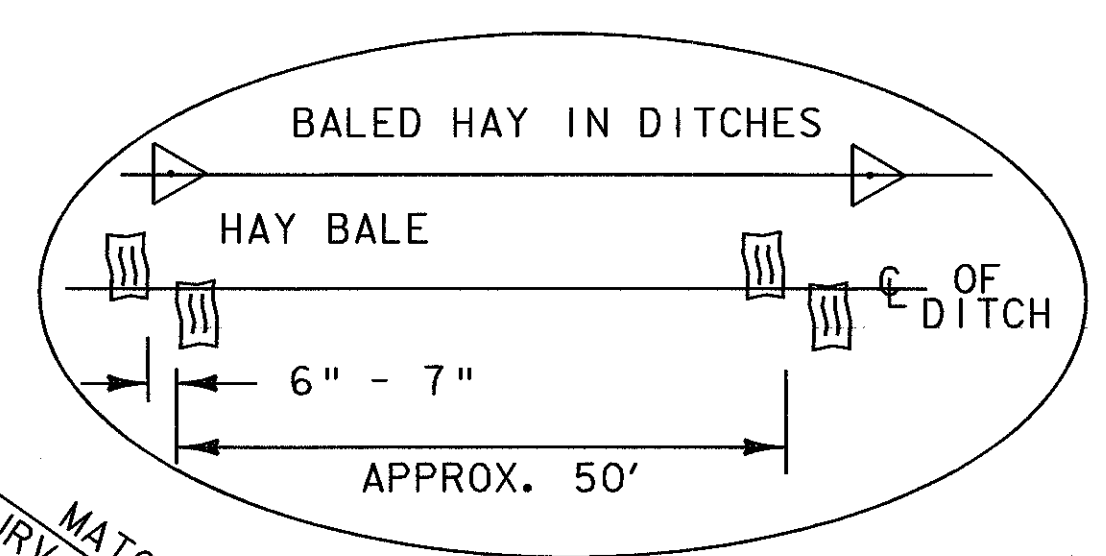
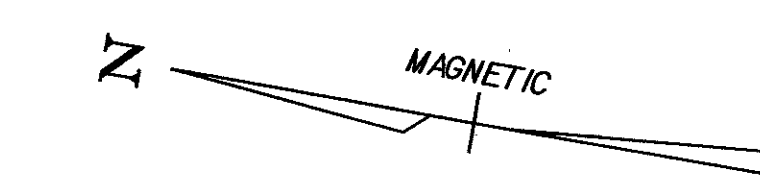

(S-F) DENOTES GEOTEXTILE FOR SILT FN. & HAY BALES.
 GEOTEXTILE FOR SILT FENCE & HAY BALES
 WEST CONNECTOR
 22+00 LT. ~ 24+00 LT.

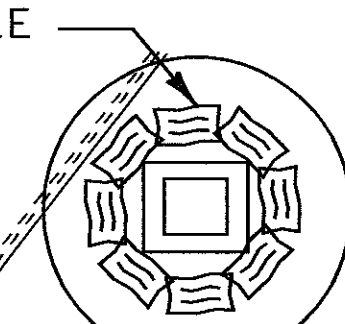

DETAIL # 3
 THIS DETAIL SHALL BE USED
 AT ALL DROP INLET LOCATIONS

GEOTEXTILE FOR SILT FENCE & HAY BALES
 144+75 RT. ~ 145+50 RT
 148+25 RT. ~ 150+30 RT
 139+00 LT. ~ 141+75 LT
 143+65 LT. ~ 145+05 LT

BALED HAY FOR EROSION CHECKS
 139+00 RT. ~ 142+50 RT
 146+00 LT. ~ 147+00 LT

BALED HAY FOR EROSION CHECKS
 WEST CONNECTOR
 20+50 LT. ~ 22+50 LT.
 20+40 RT. ~ 22+50 RT.

6" UNDERDRAIN CARRIER PIPE
 ⑫ 149+00 LT-RT
 NEW 6" X 69' UNDERDRAIN CARRIER
 PIPE W/FB @ 149+00 LT

6" UNDERDRAIN
 ⑪ 146+25 LT-149+00 LT
 NEW 6" X 275' UNDERDRAIN
 W/FB @ 146+25 LT

TEMPORARY DETOUR
 (TO INSTALL GABION WALLS)
 ML STA. 145+50 - 152+50

BRIDGE RAIL-NETC 2 RAIL
 141+34 LT - 144+51.50 LT
 141+83 RT - 144+73.50 RT

⑬ 149+05 LT-151+25 LT
 NEW 6" X 220' UNDERDRAIN
 W/FB @ 149+05 LT
 (CONTINUES ON NEXT PLAN SHEET)

GABION WALL
 ML STA. 145+68 RT-147+28 RT
 ML STA. 148+75 RT-151+25 RT

APPROACH CONSTRUCTION
 WEST CONNECTOR 20+20 - 24+00

STEEL BEAM GUARD RAIL
 139+00 LT - 141+09 LT
 144+76.50 LT - WEST CONN. 24+00 LT
 145+75 LT - 149+25 LT
 139+00 RT - 141+58 RT
 144+98.50 RT - 151+25 RT
 SURV. PI 148+21.64 =
 144+75.96

SNOW FENCE
 "NO DISTURBANCE AREA" (SEE SPECIAL PROVISIONS)
 ML STA. 145+50 RT-148+25 RT

NOTE: NO CONSTRUCTION EQUIPMENT SHALL
 BE ALLOWED BEYOND THE TOE OF SLOPE
 LIMIT FROM ML STA. 145+50 RT-148+25 RT.

WEST CONNECTOR CURVE DATA
 $\Delta = 55^\circ - 18' - 27.98''$ LT
 D = 76°23'-39.74''
 R = 75'
 T = 39.30'
 L = 72.40'
 E = 9.67'

TREATED TIMBER CURB
 SURV. 139+00 LT-SURV. 141+15 LT.
 SURV. 145+70 LT-SURV. 149+00 LT.

WATER SYSTEM ISLAND
 THE WATER SYSTEM ISLAND TO THE EAST OF THE NEW ALIGNMENT AND
 BETWEEN THE TWO BRANCHES OF THE DEERFIELD RIVER SHALL BE
 CONSIDERED A "NO DISTURBANCE AREA" AND, THEREFORE, NO
 CONSTRUCTION ACTIVITY SHALL BE CONDUCTED ON THIS ISLAND.

GUARD RAIL APPROACH
 SECTION, NETC 2 RAIL (MOD.)
 141+09 LT - 141+34 LT
 144+51.50 LT - 144+76.50 LT
 141+58 RT - 141+83 RT
 144+73.50 RT - 144+98.50 RT

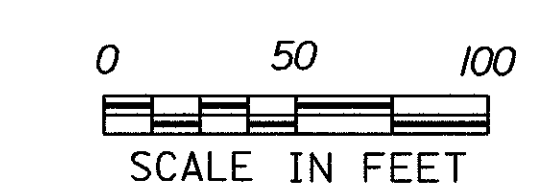

- GENERAL NOTES**
1. EROSION CONTROL MATERIALS WILL BE PLACED AS ILLUSTRATED ON NEWLY CONSTRUCTED AREAS AS SOON AS POSSIBLE.
 2. DURING CONSTRUCTION EVERY EFFORT WILL BE MADE TO KEEP DEBRIS AND SEDIMENT OUT OF THE DITCH. HAY BALES WILL BE USED AS ILLUSTRATED TO INSURE BANK STABILITY.
 3. THE HAY BALES SHALL BE INSPECTED AND CLEANED AS NEEDED.

PROJECT NAME: SEARSBURG - WILMINGTON
 PROJECT NUMBER: NHF OIO-(18)
 PLOT FILE NAME: dd096hb4.1
 PROJECT LEADER: DELLA SANTA
 DESIGN FILE: 78d096/design/dd096nec.dgn
 PLOT DATE: 26-DEC-2001
 DRAWN BY: SQUAD B
 SHEET 307 OF 435