

THIS SHEET IS FOR EROSION CONTROL USE ONLY

CABLE GUARD RAIL
96+50 LT - 110+00 LT
TERMINATE AT 110+00 BY
BURYING IT IN BERM.

**REMOVAL AND DISPOSAL
OF GUARD RAIL**
105+64 LT - 107+94 LT
108+90 LT - 109+77 LT

CONSTRUCT DRIVE
98+94 RT (PAVED)

**RELOCATE MAILBOX,
SINGLE SUPPORT**
98+89 LT - 99+00 LT

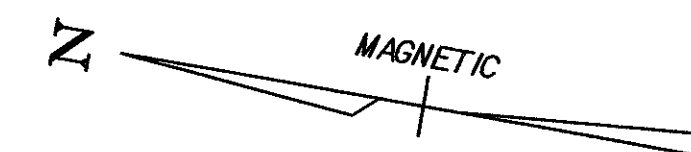

**LANDSCAPING ITEMS FOR
MR. ZUCKER'S PROPERTY**
(PLANTING LOCATION TO BE DETERMINED BY
PROPERTY OWNER AND RESIDENT ENGINEER)
ONE 1 1/2" CORTLAND APPLE TREE (SEMI-DWARF)
ONE 1 1/2" MCINTOSH APPLE TREE (SEMI-DWARF)
ONE 7 GAL. LIBERTY APPLE TREE (SEMI-DWARF)
ONE 7 GAL. RED DELICIOUS APPLE TREE (SEMI-DWARF)
ONE 4 IN 1 APPLE TREE (SEMI-DWARF)
(CORTLAND, LODI, MCINTOSH AND SUMMER RED)
FOUR 6-7' PICEA GLAUCA (EVERGREEN TREES)

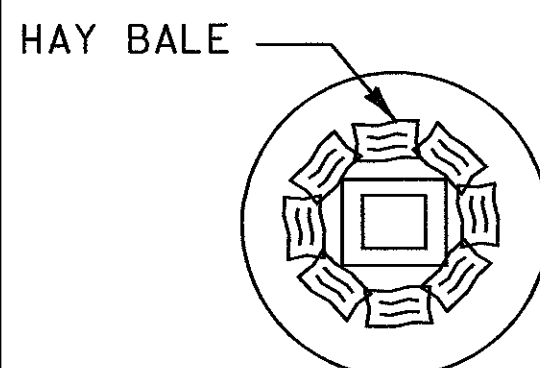

DETAIL # 3
THIS DETAIL SHALL BE USED
AT ALL DROP INLET LOCATIONS

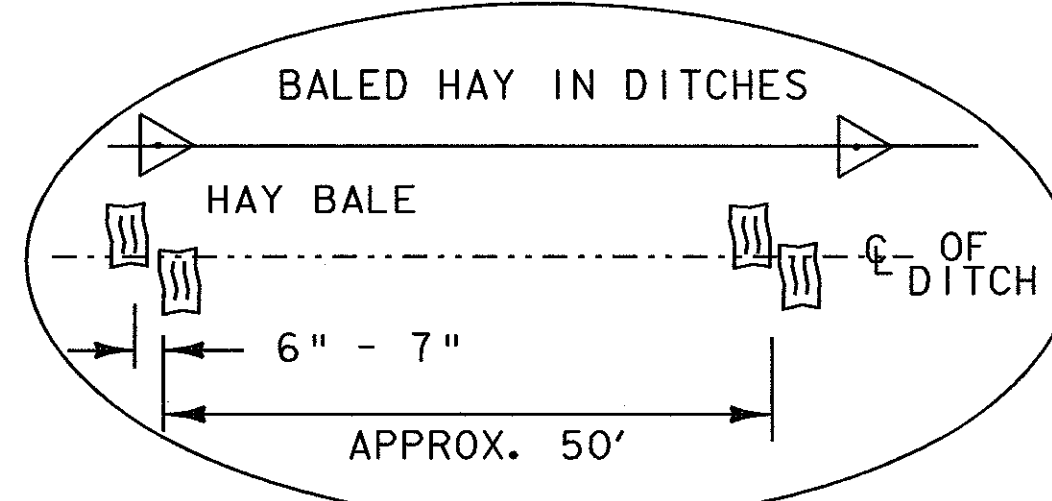

BALED HAY IN DITCHES
101+00 RT - 110+00 RT

GENERAL NOTES

1. EROSION CONTROL MATERIALS WILL BE PLACED AS ILLUSTRATED ON NEWLY CONSTRUCTED AREAS AS SOON AS POSSIBLE.
2. DURING CONSTRUCTION EVERY EFFORT WILL BE MADE TO KEEP DEBRIS AND SEDIMENT OUT OF THE DITCH. HAY BALES WILL BE USED AS ILLUSTRATED TO INSURE BANK STABILITY.
3. THE HAY BALES SHALL BE INSPECTED AND CLEANED AS NEEDED.

EXISTING CURVE DATA
 $\Delta = 13^{\circ}-05'$ RT
D = 1"
R = 5729.58'
T = 657.02'
L = 1308.33'
E = 37.55'
BANK: 0.021 FT./FT.

(S-F) DENOTES GEOTEXTILE FOR SILT FN. & HAY BALES.
GEOTEXTILE FOR SILT FENCE & HAY BALES
96+50 LT. ~ 107+50 LT

ML STA. 96+50
BEGIN PROJECT
NHF 010-1 (18)

PI 107+50.49 =
107+48.20

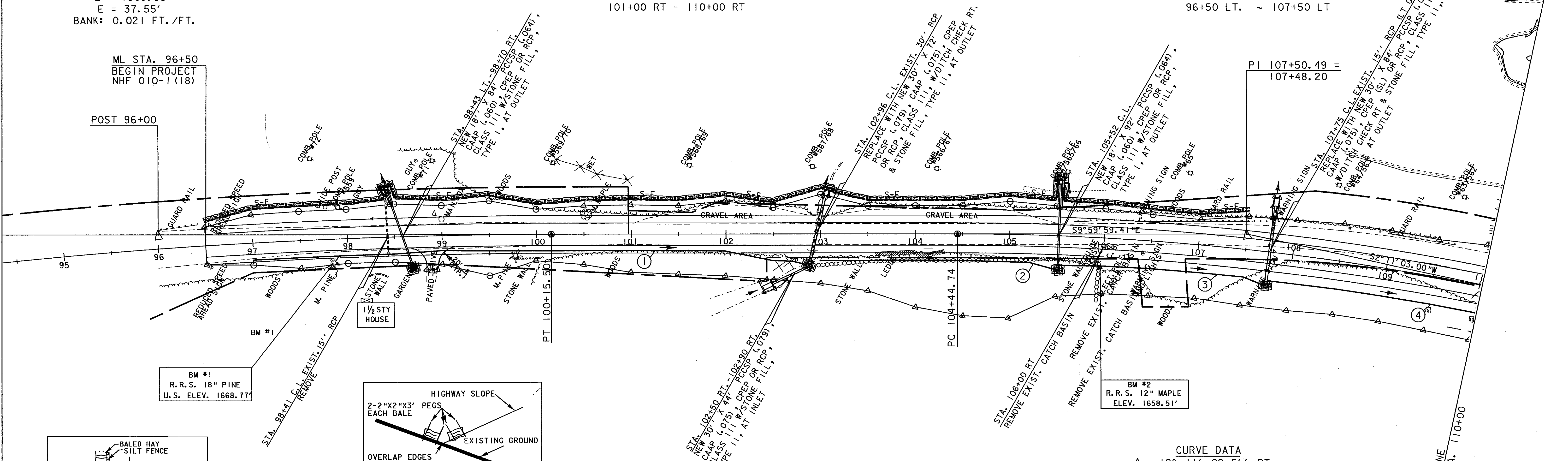

BM #1
R.R.S. 18" PINE
U.S. ELEV. 1668.77'

BM #2
R.R.S. 12" MAPLE
ELEV. 1658.51'

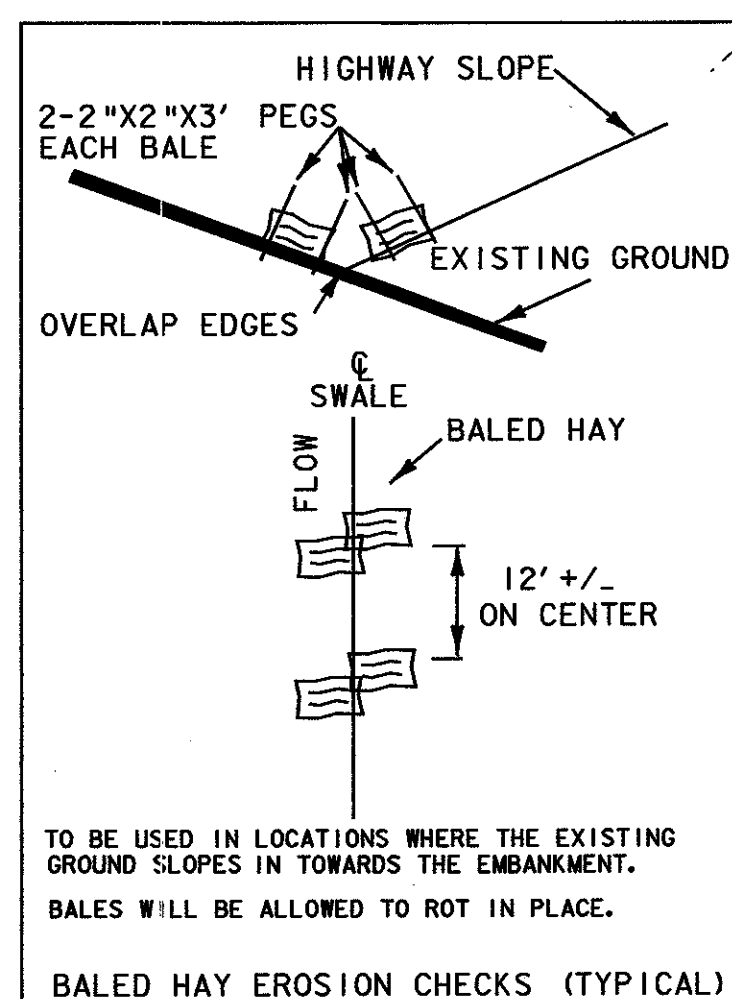
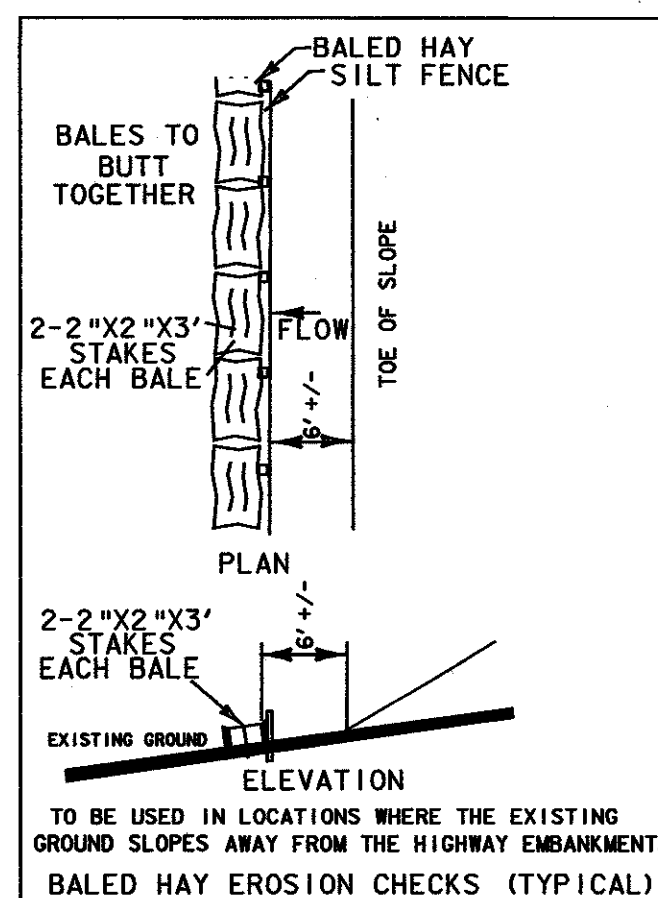

- 6" UNDERDRAIN**
- ① 97+00 RT-102+90 RT
NEW 6" X 590' UNDERDRAIN
W/FB @ 97+00 RT & 99+50 RT
 - ② 103+00 RT-105+52 RT
NEW 6" X 252' UNDERDRAIN
W/FB @ 103+00 RT
 - ③ 105+54 RT-107+75 RT
NEW 6" X 221' UNDERDRAIN
W/FB @ 105+54 RT
 - ④ 107+77 RT-110+20 RT
NEW 6" X 221' UNDERDRAIN
W/FB @ 107+77 RT

CURVE DATA
 $\Delta = 12^{\circ}-11'-02.5''$ RT
D = 2"
R = 2864.79'
T = 305.75'
L = 609.20'
E = 16.27'
BANK: 0.038 FT./FT.

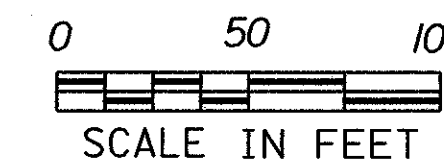

NOTE: PROPOSED CENTERLINE FROM 96+50 TO 100+15.5 SHALL FOLLOW THE CENTERLINE OF THE EXISTING PAVEMENT.

PROJECT NAME: SEARSBURG - WILMINGTON
PROJECT NUMBER: NHF 010-(18)
PLOT FILE NAME: dd096hbl1
PROJECT LEADER: DELLA SANTA
DESIGN FILE: 78D096/DESIGN/DD096CNUJ.DGN
PLOT DATE: 13-DEC-2001
DRAWN BY: SQUAD B
SHEET 304 OF 435