

THIS SHEET IS FOR WETLANDS AND RARE AND ENDANGERED SPECIES ONLY

**DRILLING AND BLASTING
SOLID ROCK SUBGRADE**
251+75 - 258+25
E. CONN. 10+20 - E. CONN. 11+75

268+75 LT.
NEW 15" X 28" CSP.064 W/CSPES @
INLET & OUTLET

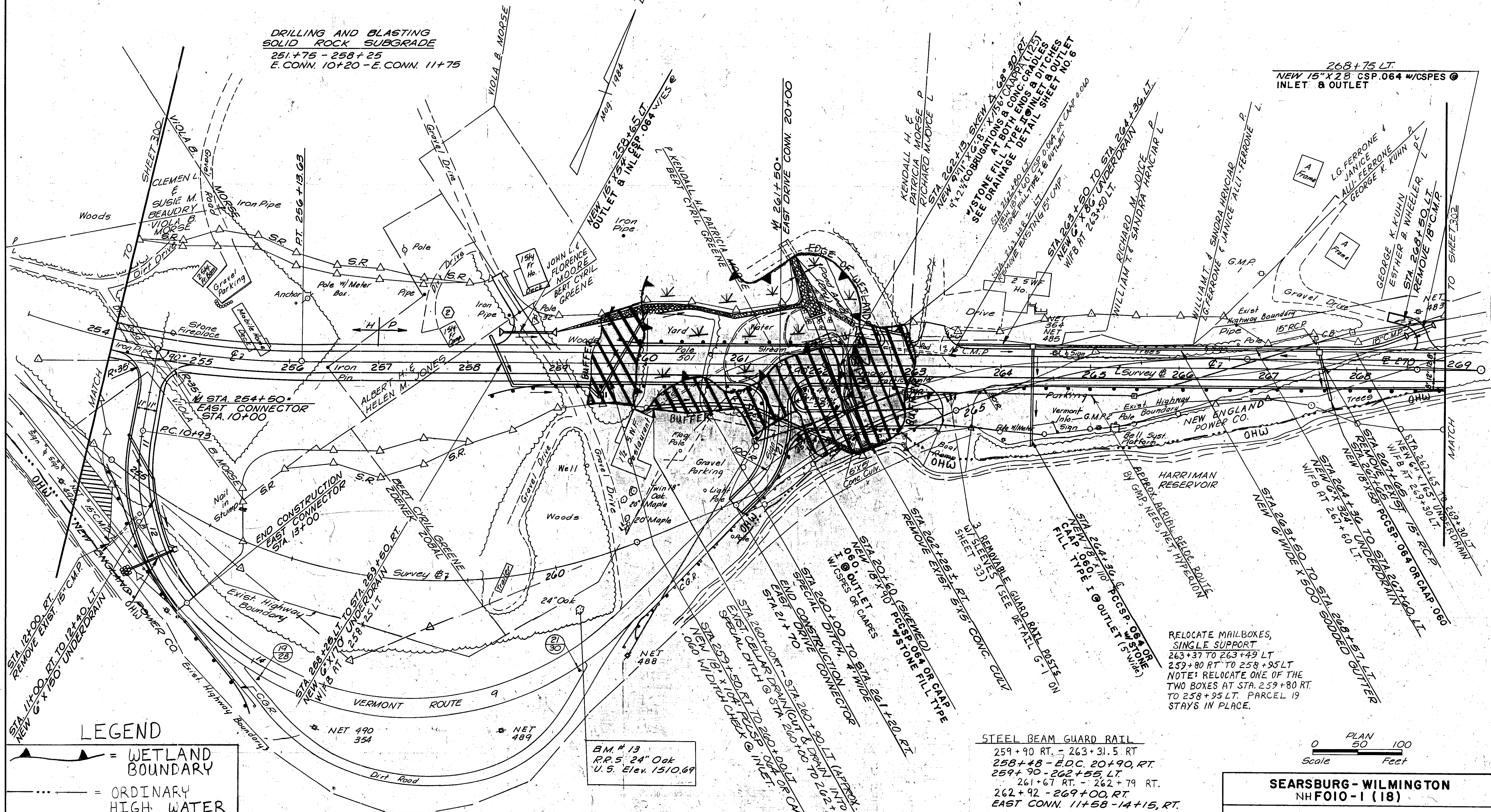

IN CHARGE OF: _____
 DESIGNED BY: _____
 CHECKED BY: _____
 DATE: _____

LEGEND

- = WETLAND BOUNDARY
- = ORDINARY HIGH WATER
- = COE DATA
- = CLASS II WETLAND BUFFER IMPACT

EXCAVATION OF SURFACES AND PAVEMENTS
W 251+70, RT. TO EAST CONN. 11+90, RT.

BM. # 13
RR. 5 24" Oak
U.S. Elev. 1510.69

CONSTRUCT DRIVE
258+65, LT. (GRAVEL) 12' W
262+80, LT. (GRAVEL) 20' W
263+24, LT. (GRAVEL) 22' W
263+50, RT. (GRAVEL) 30' W
268+75, LT. (GRAVEL) 12' W
261+67 64' RT TO 263+35 59' RT (GRAVEL) 18' W

STEEL BEAM GUARD RAIL
259+90 RT. - 263+31.5 RT
258+48 - E.D.C. 20+90, RT.
259+90 - 262+55, LT.
261+67 RT. - 262+79 RT.
262+92 - 269+00, RT.
EAST CONN. 11+58 - 14+15, RT.

REMOVAL AND DISPOSAL OF GUARD RAIL
261+80 RT - 263+00, RT.
261+80, RT. - 262+60, RT.
254+00 RT - E. CONN. 14+40 RT.

RELOCATE MAILBOXES,
SINGLE SUPPORT
263+37 TO 263+49 LT
259+80 RT TO 258+95 LT
NOTE: RELOCATE ONE OF THE
TWO BOXES AT STA. 259+80 RT.
TO 258+95 LT. PARCEL 19
STAYS IN PLACE.



SEARSBURG - WILMINGTON NHFO10-1 (18)		
MAINLINE		
McFARLAND-JOHNSON ENGINEERS, INC. BINGHAMTON NEW YORK		
SCALE AS NOTED	DATE	SHEET 301 OF 435