

**GIRDER ELEVATION - BR 25**  
(NOT TO SCALE)

\* MEMBERS INDICATED SHALL BE CHARPY V-NOTCH (CVN) TESTED IN ACCORDANCE WITH SECTION 714.01 OF THE SPECIFICATION.

**NOTES:**

- ALL STRUCTURAL STEEL SHALL BE AASHTO M270 GR 50W UNLESS OTHERWISE NOTED.
- FOR FIELD SPLICE DETAILS, SEE TYPICAL GIRDER SPLICE DETAILS, BRIDGE SHEET BR215 AND BR215A.
- ALL STRUCTURAL STEEL WITHIN 10 FEET OF END OF GIRDER SHALL BE COATED WITH A PROTECTIVE PAINT SYSTEM, WITH THE FINAL COAT TO BE DARK BROWN (COLOR CHIP #20059) TO BLEND WITH THE WEATHERING STEEL. THE COST OF PAINTING SHALL BE PAID UNDER ITEM 513.25. \*STRUCTURAL PAINTING SHOP APPLIED. IN ADDITION A GREASE COATING SHALL BE APPLIED TO PAINTED AREAS. THE COLOR SHALL MATCH THE COLOR OF THE PAINT COAT AS PER SUPPLEMENTARY SPECIFICATION 513.06.
- ALL BEARING STIFFENER PLATES SHALL BE VERTICAL IN THEIR FINAL ERECTED POSITION.
- ENDS OF GIRDERS SHALL BE FABRICATED SO THAT THE ENDS WILL BE VERTICAL UNDER FULL DEAD LOAD.
- IN AREAS OF UNPAINTED STEEL CONTACT SURFACES OF BOLTED CONNECTIONS SHALL BE BLAST CLEANED IF RUSTED BEFORE CONNECTION IS MADE. IN AREAS OF PAINTED STEEL, PRIMER SHALL REMAIN ON THE SURFACES OF STEEL CONNECTION CONTACTS.
- FOR CROSSFRAME DETAILS, SEE SHEET BR216 AND BR217.
- TOP OF STUDS SHALL EXTEND ABOVE BOTTOM LAYER OF DECK REINFORCEMENT.
- BUTT WELDED FLANGE PLATES SHALL BE OFFSET 5'-0" FROM BUTT WELDED WEB PLATES.
- NUMBER OF STUDS SPECIFIED. ACTUAL SPACING VARIES - 1/4".

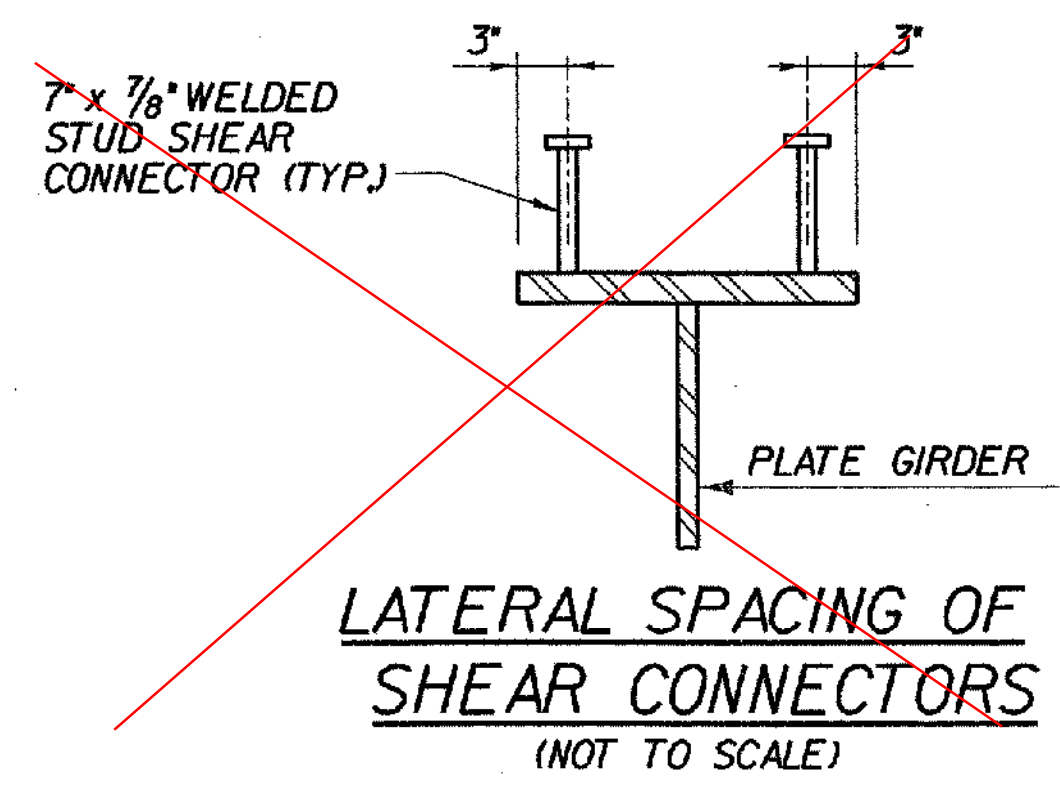

BR 25															
GIRDER	RADIUS	SPAN LENGTHS (ALONG ARC) FT-IN			TOTAL LENGTH CLBRG. ABUT. TO ABUT.	TOTAL GIRDER LENGTH	GIRDER	SPLICE 1		SPLICE 2		POINT OF DEAD LOAD CONTRAFLECTURE			
		L 1	L 2	L 3				"A"	TYPE	"B"	TYPE	Z (1)	Z (2)	Z (3)	Z (4)
G1	1254.74'	64'-5 1/4"	125'-9 3/16"	54'-2 1/2"	242'-10 9/16"	244'-5 9/16"	G1	27'-1"	1	20'-11"	1	39'-11 1/16"	24'-8 3/4"	20'-7 3/16"	49'-3 3/16"
G2	1263.99'	63'-9 1/16"	124'-10 1/16"	53'-11"	241'-0 7/8"	242'-7 7/8"	G2	21'-7"	2	21'-10"	1	35'-11 1/16"	22'-2 1/16"	21'-2 1/4"	42'-5 3/16"
G3	1273.24'	63'-2 1/16"	124'-0"	53'-7 7/16"	239'-3"	240'-10"	G3	24'-10"	1	28'-1"	2	36'-1 5/8"	21'-5 5/8"	22'-2 1/16"	45'-9 3/16"
G4	1282.49'	62'-7 1/2"	123'-1 3/16"	53'-4 5/16"	237'-6 5/8"	239'-1 7/8"	G4	15'-0"	3	23'-6"	2	40'-9 5/16"	20'-6 1/2"	22'-9 1/2"	41'-11 5/16"
G5	1291.74'	62'-1"	122'-4 1/16"	53'-1 1/16"	235'-11 1/8"	237'-6 1/8"	G5	15'-5"	1	20'-3"	1	48'-6 5/16"	19'-9 5/8"	24'-11 7/8"	52'-4 7/16"
GIRDER	TOP FLANGE SECTION LENGTHS (ALONG ARC)					BOTTOM FLANGE SECTION LENGTHS (ALONG ARC)									
	DIT	D2 T	D3 T	D4 T	D5 T	D1 B	D2 B	D3 B	D4 B	D5 B					
G1	52'-5 1/4"	24'-0"	101'-9 3/16"	24'-0"	42'-2 1/2"	52'-5 1/4"	36'-11 3/8"	76'-2 1/4"	37'-4 3/16"	42'-2 1/2"	24'-0"	101'-9 9/16"	24'-0"		
G2	51'-9 1/16"	24'-0"	100'-11 1/16"	24'-0"	41'-11"	51'-9 1/16"	36'-2 5/8"	75'-8 1/16"	36'-11 3/8"	41'-11"	24'-0"	100'-11 1/16"	24'-0"		
G3	51'-2 1/16"	24'-0"	100'-0"	24'-0"	41'-7 7/16"	51'-2 1/16"	-	148'-0"	-	41'-7 7/16"					
G4	50'-7 1/2"	24'-0"	99'-1 3/16"	24'-0"	41'-4 1/16"	50'-7 1/2"	-	147'-1 3/16"	-	41'-4 1/16"					
G5	50'-1"	24'-0"	98'-4 1/16"	24'-0"	41'-1 1/16"	50'-1"	-	146'-4 1/16"	-	41'-1 1/16"					

**CHA** CLOUGH, HARBOUR & ASSOCIATES LLP  
ENGINEERS, SURVEYORS, PLANNERS & LANDSCAPE ARCHITECTS  
11 WINNERS CIRCLE ALBANY, NEW YORK, 12205

**STATE OF VERMONT**  
**AGENCY OF TRANSPORTATION**

Town of	SEARSBURG	Bridge No.	BR 25
Highway No.	VT. RTE. 9	Log Sta.	
		Surv. Sta.	
VT. RTE. 9 OVER DEERFIELD RIVER			
GIRDER ELEVATION - BR 25			
Designed By	D. VIENI	Drawn by	K. DETRICK/J. LAGONE
Checked By	M. OLSTAD	Date	12/2001
		Bridge Design Supervisor	M. OLSTAD
		Date	12/2001
PROJECT	SEARSBURG - WILMINGTON	PROJECT NO.	NHF 010-108
L.G.C. Info.			
Bridge Sheet No.	BR212	Sheet	138 OF 435

FILE NAME = \\19255\NET\15\BR025\25.stndlev.plt  
DATE/TIME = 12/18/01  
USER = 564