

CURVE DATA	
REV P.C. - STA.	113+61.81
REV P.T. - STA.	122+89.88
Δ	41°-45'-47.87" LT.
R	1273.24'
Dc	4'-30"
L	928.07'
T	485.74'
E	89.51'
BANK:	0.067 FT/FT

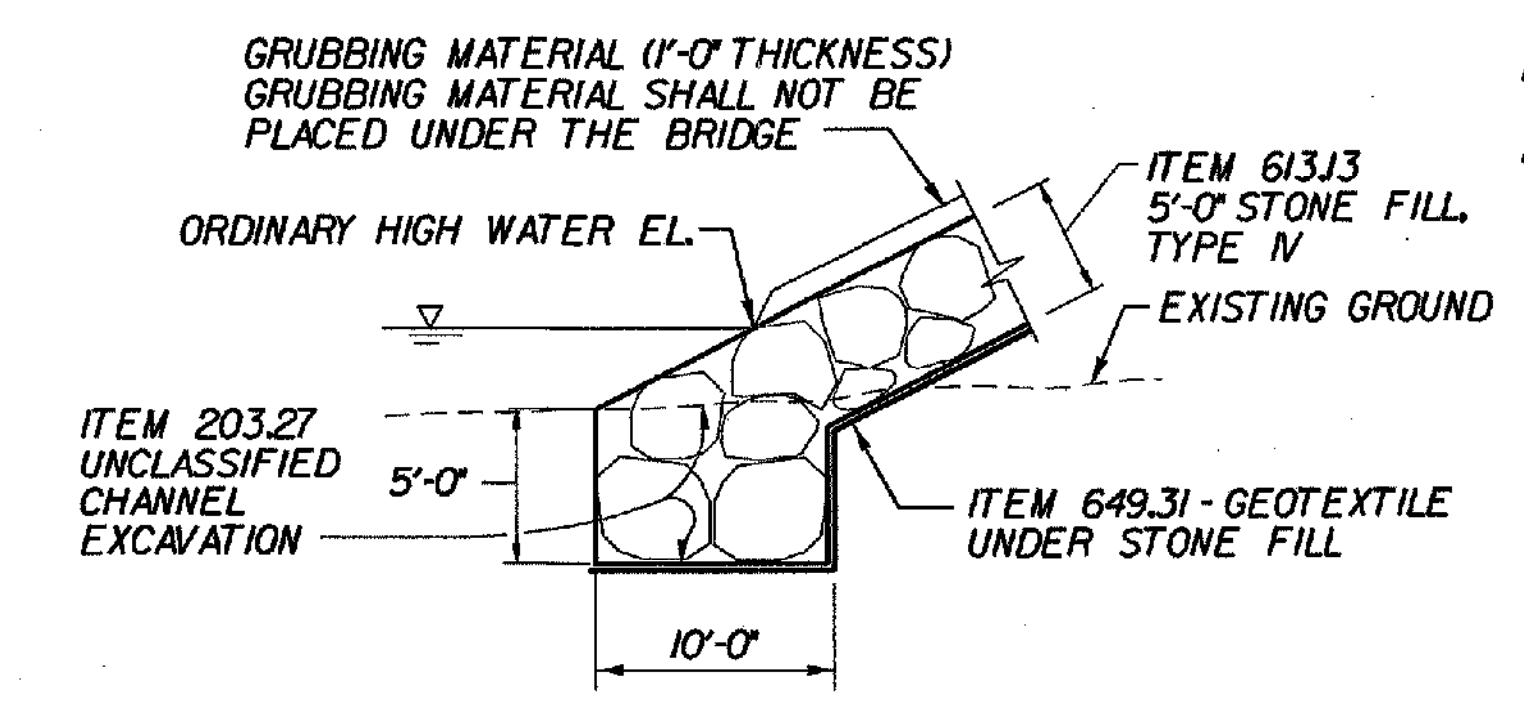
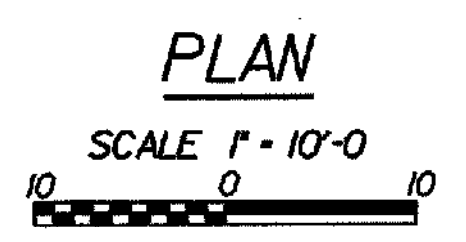
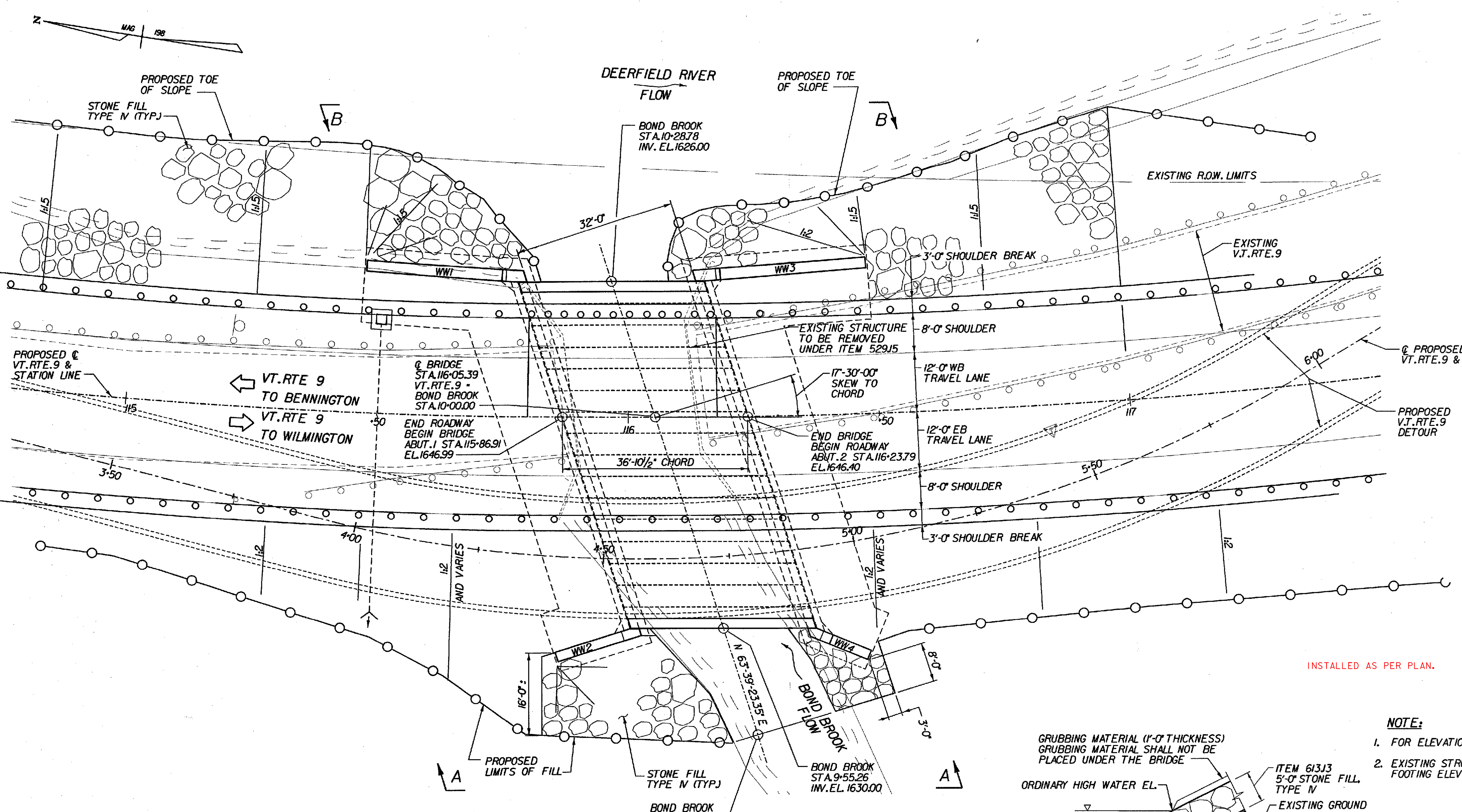

INSTALLED AS PER PLAN.

- NOTE:**
- FOR ELEVATION A-A AND B-B, SEE BRIDGE SHEET BR103.
 - EXISTING STRUCTURE TO BE REMOVED TO BOTTOM OF FOOTING ELEVATION, ITEM 529J5.

STATE OF VERMONT AGENCY OF TRANSPORTATION			
Town Of	SEARSBURG	Bridge No.	24
Highway No.	VT. RTE. 9	Log Sta.	
		Surv. Sta.	116+00
VT. RTE. 9 OVER BOND BROOK			
PLAN			
Designed By	M. GOGUEN	Drawn by	J. LAGONE
Checked By	M. OLSTAD	Bridge Design Supervisor	M. OLSTAD
Date	12/2001	Date	12/2001
PROJECT	SEARSBURG - WILMINGTON	PROJECT NO.	NHF 010-11(B)
I.G.C. Info.		Bridge Sheet No. BR100	

CHA CLOUGH, HARBOUR & ASSOCIATES LLP
ENGINEERS, SURVEYORS, PLANNERS
& LANDSCAPE ARCHITECTS
WINNERS CIRCLE ALBANY, NEW YORK, 12205