

IN CHARGE OF: \_\_\_\_\_  
 DESIGNED BY: \_\_\_\_\_  
 CHECKED BY: \_\_\_\_\_

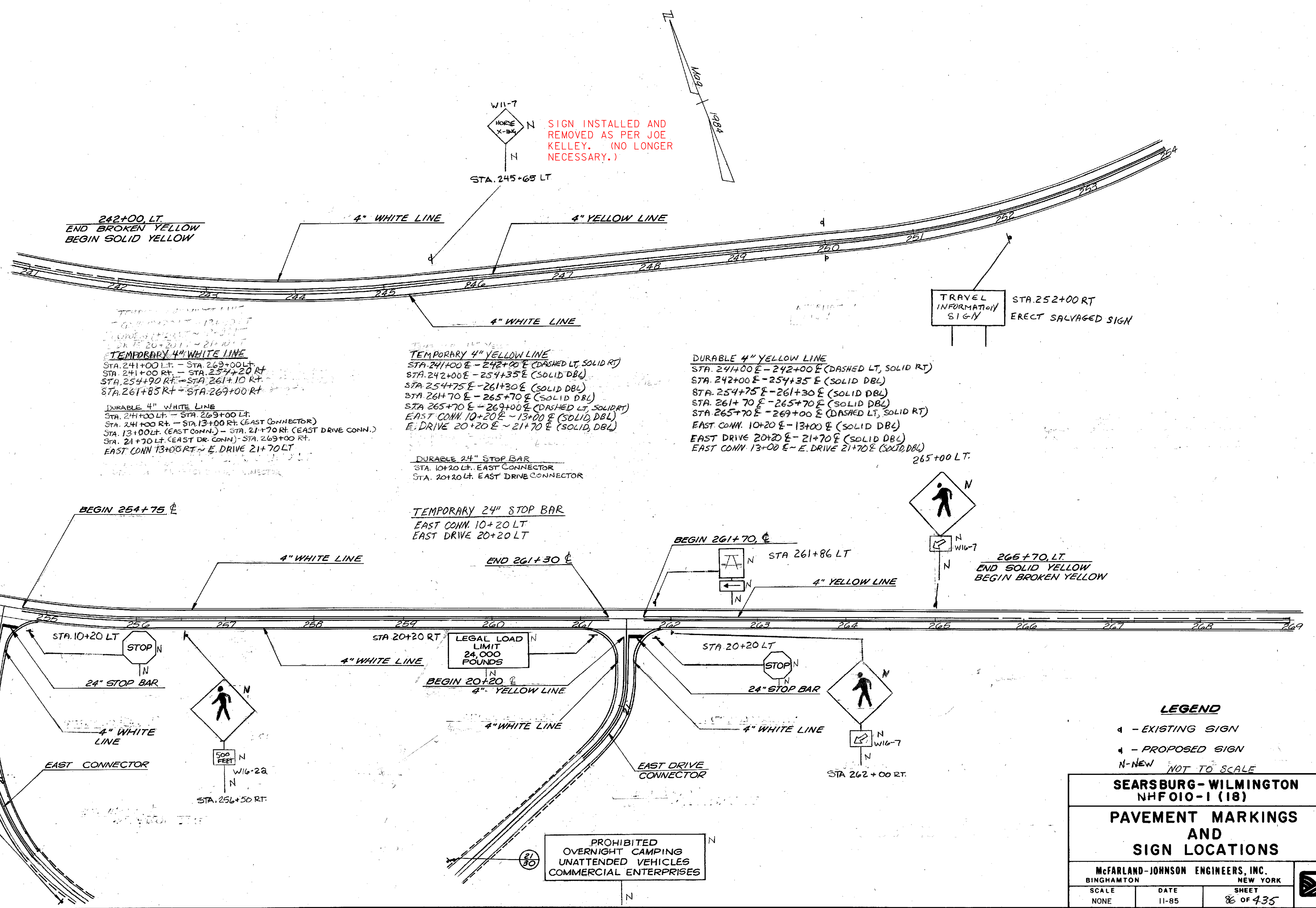

W11-7  
 SIGN INSTALLED AND REMOVED AS PER JOE KELLEY. (NO LONGER NECESSARY.)

242+00 LT.  
 END BROKEN YELLOW  
 BEGIN SOLID YELLOW

TEMPORARY 4" WHITE LINE  
 STA. 241+00 LT. - STA. 269+00 LT.  
 STA. 241+00 RT. - STA. 254+20 RT.  
 STA. 254+90 RT. - STA. 261+10 RT.  
 STA. 261+85 RT. - STA. 269+00 RT.

DURABLE 4" WHITE LINE  
 STA. 241+00 LT. - STA. 269+00 LT.  
 STA. 241+00 RT. - STA. 13+00 RT. (EAST CONNECTOR)  
 STA. 13+00 LT. (EAST CONN.) - STA. 21+70 RT. (EAST DRIVE CONN.)  
 STA. 21+70 LT. (EAST DR. CONN.) - STA. 269+00 RT.  
 EAST CONN. 13+00 RT. - E. DRIVE 21+70 LT.

TEMPORARY 4" YELLOW LINE  
 STA. 241+00 E. - 242+00 E. (DASHED LT, SOLID RT)  
 STA. 242+00 E. - 254+35 E. (SOLID DBL)  
 STA. 254+75 E. - 261+30 E. (SOLID DBL)  
 STA. 261+70 E. - 265+70 E. (SOLID DBL)  
 STA. 265+70 E. - 269+00 E. (DASHED LT, SOLID RT)  
 EAST CONN. 10+20 E. - 13+00 E. (SOLID, DBL)  
 E. DRIVE 20+20 E. - 21+70 E. (SOLID, DBL)

DURABLE 4" YELLOW LINE  
 STA. 241+00 E. - 242+00 E. (DASHED LT, SOLID RT)  
 STA. 242+00 E. - 254+35 E. (SOLID DBL)  
 STA. 254+75 E. - 261+30 E. (SOLID DBL)  
 STA. 261+70 E. - 265+70 E. (SOLID DBL)  
 STA. 265+70 E. - 269+00 E. (DASHED LT, SOLID RT)  
 EAST CONN. 10+20 E. - 13+00 E. (SOLID DBL)  
 EAST DRIVE 20+20 E. - 21+70 E. (SOLID DBL)  
 EAST CONN. 13+00 E. - E. DRIVE 21+70 E. (SOLID, DBL)

TEMPORARY 24" STOP BAR  
 EAST CONN. 10+20 LT  
 EAST DRIVE 20+20 LT

TRAVEL INFORMATION SIGN  
 STA. 252+00 RT  
 ERECT SALVAGED SIGN

END 254+35 E  
 STA. 254+60 RT  
 253+50

STA. 10+20 RT  
 LEGAL LOAD LIMIT  
 24,000 POUNDS

PROHIBITED OVERNIGHT CAMPING UNATTENDED VEHICLES COMMERCIAL ENTERPRISES

BEGIN 254+75 E  
 4" WHITE LINE

STA. 10+20 LT  
 STOP

4" WHITE LINE  
 EAST CONNECTOR

W16-22  
 500 FEET  
 STA. 256+50 RT.

END 261+30 E  
 4" WHITE LINE

STA. 20+20 RT  
 LEGAL LOAD LIMIT  
 24,000 POUNDS

4" WHITE LINE  
 EAST DRIVE CONNECTOR

PROHIBITED OVERNIGHT CAMPING UNATTENDED VEHICLES COMMERCIAL ENTERPRISES

BEGIN 261+70 E  
 STA. 261+86 LT  
 4" YELLOW LINE

STA. 20+20 LT  
 STOP

W16-7  
 STA. 262+00 RT.

W16-7  
 265+70 LT.  
 END SOLID YELLOW  
 BEGIN BROKEN YELLOW

**LEGEND**

- ◻ - EXISTING SIGN
- ◻ - PROPOSED SIGN
- N-NEW NOT TO SCALE

<b>SEARSBURG-WILMINGTON</b> NHFO10-1 (18)		
<b>PAVEMENT MARKINGS AND SIGN LOCATIONS</b>		
McFARLAND-JOHNSON ENGINEERS, INC. BINGHAMTON NEW YORK		
SCALE NONE	DATE 11-85	SHEET 8 OF 435