

USGEN NEW ENGLAND, INC.,
JOINED BY
VERMONT LAND TRUST, INC.

NOTE: NO CONSTRUCTION EQUIPMENT SHALL
BE ALLOWED BEYOND THE TOE OF SLOPE
LIMIT FROM ML STA. 151+25 LT-154+50 LT.

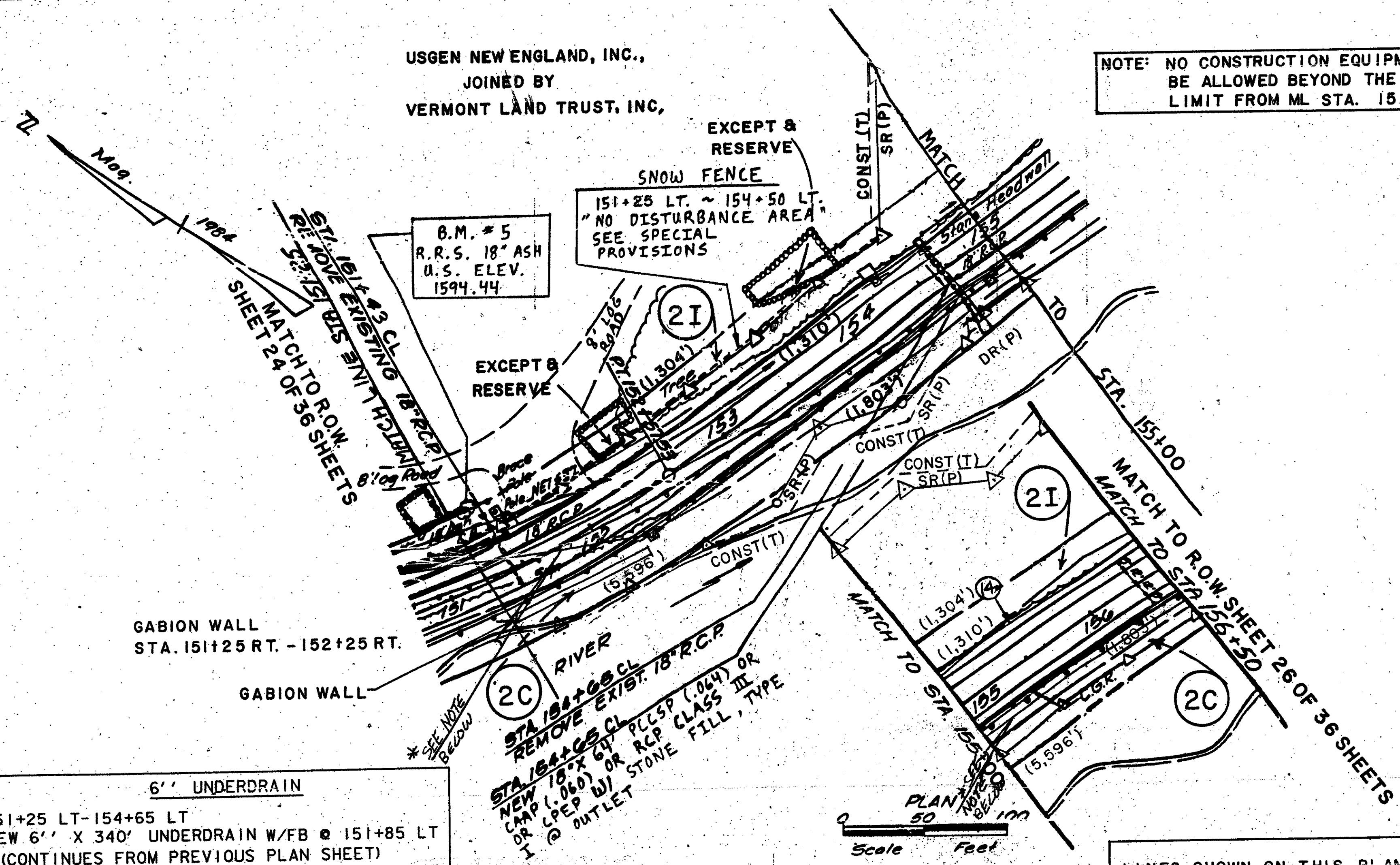

6" UNDERDRAIN

⑬ 151+25 LT-154+65 LT
NEW 6" X 340' UNDERDRAIN W/FB @ 151+85 LT
(CONTINUES FROM PREVIOUS PLAN SHEET)

⑭ 154+70 LT-157+00 LT
NEW 6" X 230' UNDERDRAIN W/FB @ 154+70 LT
NOTE: ON NEXT PLAN SHEET THE UNDERDRAIN
NUMBERING SKIPS ⑮ AND ⑯
AND RESUMES WITH ⑰

USGEN NEW ENGLAND, INC.,
JOINED BY
VERMONT LAND TRUST, INC.

*NOTE: APPROX. AERIAL RELOC. ROUTE
BY GMP, NEES, NET, HYPERION

LINES SHOWN ON THIS PLAN AS EXISTING
PROPERTY LINES (P/L) ARE BELIEVED TO
BE ACCURATE BUT SHOULD NOT BE RELIED
UPON FOR PURPOSES UNRELATED TO THE
STATE OF VERMONT'S ACQUISITION OF LAND
AND RIGHTS FOR THIS PROJECT.

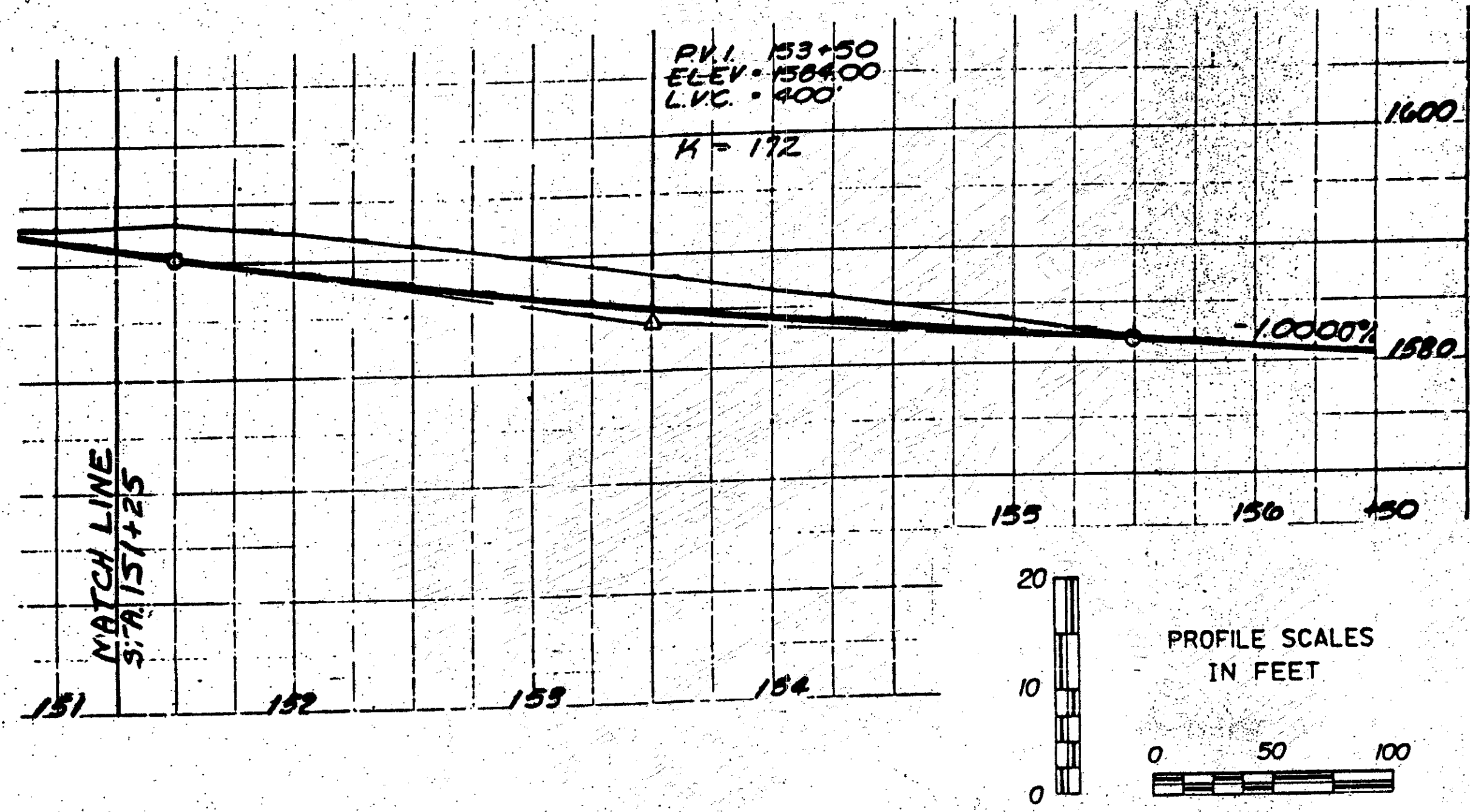

FOR R.O.W. USE ONLY

REVISED

PROJECT NAME: SEARSBURG - WILMINGTON
PROJECT NUMBER: NHF 010-1(18)

PLOT FILE NAME: DD096L05 PLOT DATE: 07-OCT-2000
PROJECT LEADER: DELLA SANTA DRAWN BY: SQUAD B
DESIGN FILE: 78D096/DESIGN/DD096CBR.DGN

ROW SHEET 25 OF 36