

CABLE GUARD RAIL
 96+50 LT - 110+00 LT
 TERMINATE AT 110+00 BY
 BURYING IT IN BERM.

**REMOVAL AND DISPOSAL
 OF GUARD RAIL**
 105+64 LT - 107+94 LT
 108+90 LT - 109+77 LT

CONSTRUCT DRIVE
 98+94 RT (PAVED)

**RELOCATE MAILBOX,
 SINGLE SUPPORT**
 98+89 LT - 99+00 LT

**LANDSCAPING ITEMS FOR
 MR. ZUCKER'S PROPERTY**
 (PLANTING LOCATION TO BE DETERMINED BY
 PROPERTY OWNER AND RESIDENT ENGINEER)
 ONE 1 1/2" CORTLAND APPLE TREE (SEMI-DWARF)
 ONE 1 1/2" MCINTOSH APPLE TREE (SEMI-DWARF)
 ONE 7 GAL. LIBERTY APPLE TREE (SEMI-DWARF)
 ONE 7 GAL. RED DELICIOUS APPLE TREE (SEMI-DWARF)
 ONE 4 IN 1 APPLE TREE (SEMI-DWARF)
 (CORTLAND, LODI, MCINTOSH AND SUMMER RED)
 FOUR 6-7' PICEA GLAUCA (EVERGREEN TREES)

**USGEN NEW
 ENGLAND, INC.
 JOINED BY
 VERMONT LAND
 TRUST INC.**

EXISTING CURVE DATA
 $\Delta = 13^{\circ}-05' RT$
 D = 1'
 R = 5729.58'
 T = 657.02'
 L = 1308.33'
 E = 37.55'
 BANK: 0.021 FT./FT.

**BEGIN R.O.W. PROJECT
 STA. 98+27 60'LT.**

ML STA. 96+50
 BEGIN PROJECT
 NHF 010-1 (18)

POST 96+00

PI 107+50.49 =
 107+48.20

TO R.O.W. SHEET 23 OF 36

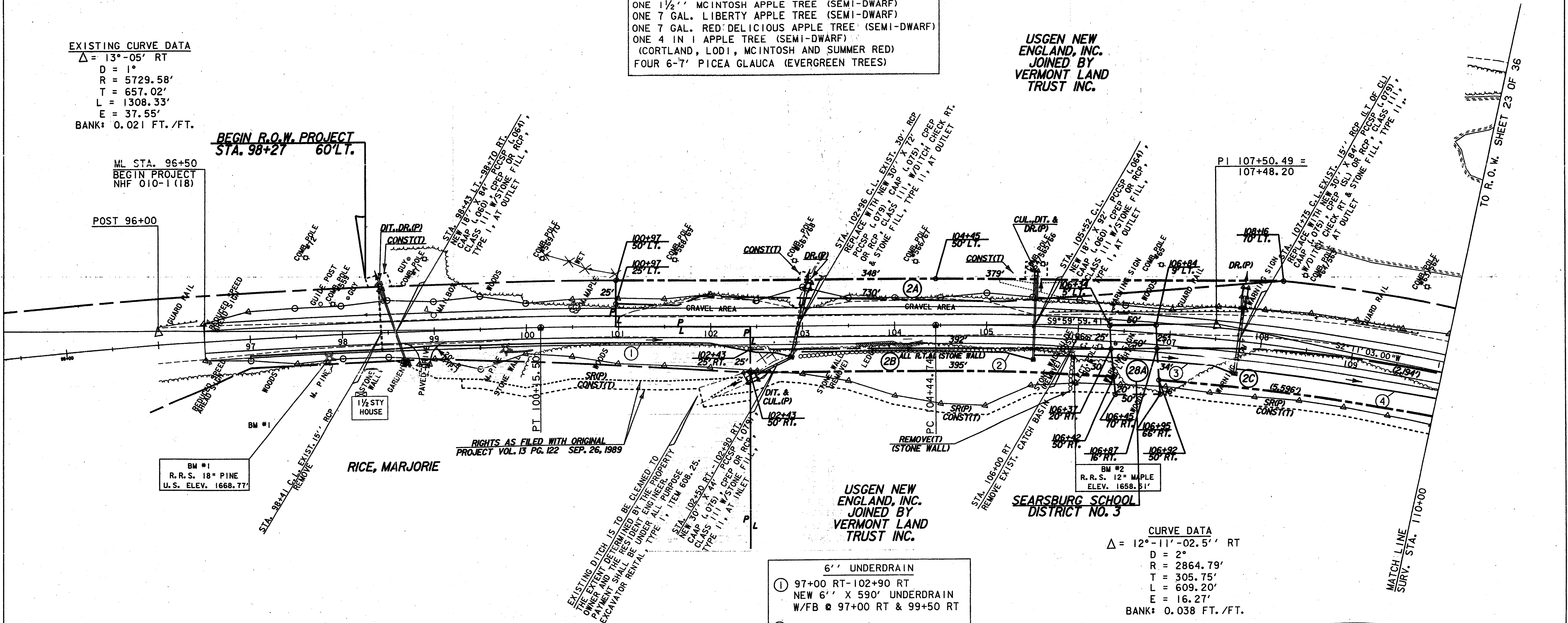

BM #1
 R.R.S. 18" PINE
 U.S. ELEV. 1668.77'

BM #2
 R.R.S. 12" MAPLE
 ELEV. 1658.61'

RIGHTS AS FILED WITH ORIGINAL
 PROJECT VOL. 13 PG. 122 SEP. 26, 1989

EXISTING DITCH IS TO BE CLEANED TO
 THE EXTENT DETERMINED BY THE PROPERTY
 OWNER AND THE RESIDENT ENGINEER.
 PAYMENT SHALL BE UNDER ALL PURPOSE
 EXCAVATOR RENTAL, TYPE 1, ITEM 608.25.
 STA. 102+50 RT - 102+90 RT.
 CLASS III W/STONE FILL, TYPE I, AT INLET.

- 6" UNDERDRAIN**
- ① 97+00 RT-102+90 RT
 NEW 6" X 590' UNDERDRAIN
 W/FB @ 97+00 RT & 99+50 RT
 - ② 103+00 RT-105+52 RT
 NEW 6" X 252' UNDERDRAIN
 W/FB @ 103+00 RT
 - ③ 105+54 RT-107+75 RT
 NEW 6" X 221' UNDERDRAIN
 W/FB @ 105+54 RT
 - ④ 107+77 RT-110+20 RT
 NEW 6" X 221' UNDERDRAIN
 W/FB @ 107+77 RT

CURVE DATA
 $\Delta = 12^{\circ}-11'-02.5' RT$
 D = 2'
 R = 2864.79'
 T = 305.75'
 L = 609.20'
 E = 16.27'
 BANK: 0.038 FT./FT.

LINES SHOWN ON THIS PLAN AS EXISTING
 PROPERTY LINES (P/L) ARE BELIEVED TO
 BE ACCURATE BUT SHOULD NOT BE RELIED
 UPON FOR PURPOSES UNRELATED TO THE
 STATE OF VERMONT'S ACQUISITION OF LAND
 AND RIGHTS FOR THIS PROJECT.

NOTE: PROPOSED CENTERLINE FROM 96+50 TO 100+15.5 SHALL
 FOLLOW THE CENTERLINE OF THE EXISTING PAVEMENT.

FOR R.O.W. USE ONLY

PROJECT NAME: SEARSBURG - WILMINGTON
 PROJECT NUMBER: NHF 010-1(18)
 PLOT FILE NAME: DD096L01 PLOT DATE: 06-JUN-2001
 PROJECT LEADER: DELLA SANTA DRAWN BY: SQUAD B
 DESIGN FILE: 78D096/DESIGN/DD096CNU.DGN
 R. O. W. SHEET 22 OF 36

