

DATE	
BY	
REVISIONS	
NO.	
DATE	
BY	
REVISIONS	
NO.	
DATE	
BY	
REVISIONS	
NO.	
DATE	
BY	
REVISIONS	
NO.	

DATE	
BY	
REVISIONS	
NO.	
DATE	
BY	
REVISIONS	
NO.	
DATE	
BY	
REVISIONS	
NO.	

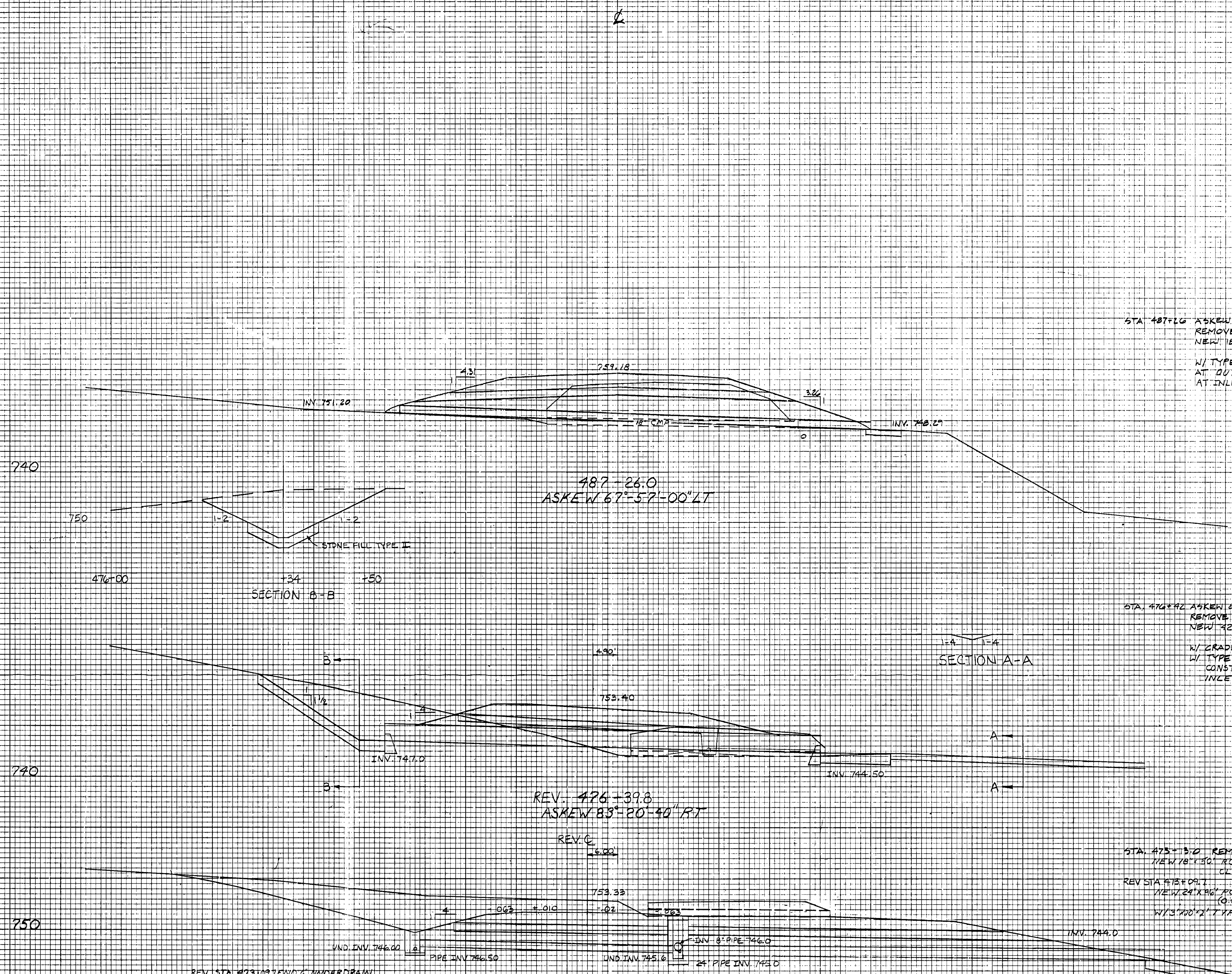

STA 487+26 ASKEW 67°-57'-00" LT
 REMOVE EXIST 18" CMP
 NEW 18" x 36" PCCSP / CAAP
 (0.004') / (0.000') / CPEP
 W/ TYPE I STONE FILL 3' x 7' x 1'
 AT OUTLET, W/ END SECTION
 AT INLET

STA 476+42 ASKEW 83°-20'-40"
 REMOVE 24" x 12" x 40" BOX CULVERT
 NEW 42" x 54" PCCSP / CAAP
 (0.109') / (0.103')
 W/ GRADLE HEADWALLS AT INLET AND OUTLET
 W/ TYPE II STONE FILL 7' x 14' x 2' AT OUTLET,
 CONSTRUCT INLET DITCH W/ TYPE II STONE FILL
 INLET AND SPECIAL DITCH @ OUTLET

STA 473+13 REMOVE EXIST 18" RCP
 NEW 18" x 54" RCP / CPEP (SL)
 CL III
 REV STA 473+09.7
 NEW 24" x 36" PCCSP / CAAP / RCP / CPEP
 (0.064') / (0.060') / CL III
 W/ 13" x 10" TYPE I STONE FILL AT OUTLET

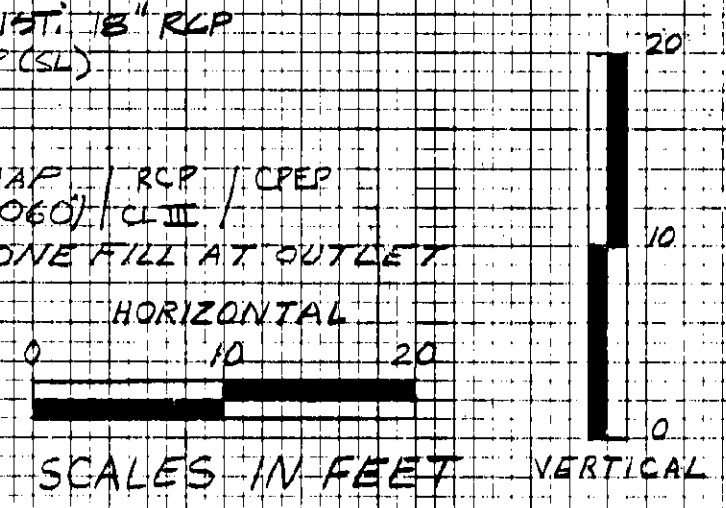

CROSS SECTIONS
 STA 473+13 TO STA 487+26
 GROTON RYEGATE P226-1(30)
 SHEET 118 OF 152