

INDEX OF SHEETS

- 1. TITLE SHEET
- 2. INDEX OF SHEETS

STATE OF VERMONT AGENCY OF TRANSPORTATION



PROPOSED IMPROVEMENT TOWNS OF GROTON AND RYEGATE COUNTY OF CALEDONIA U.S. ROUTE 302 (MINOR ARTERIAL)

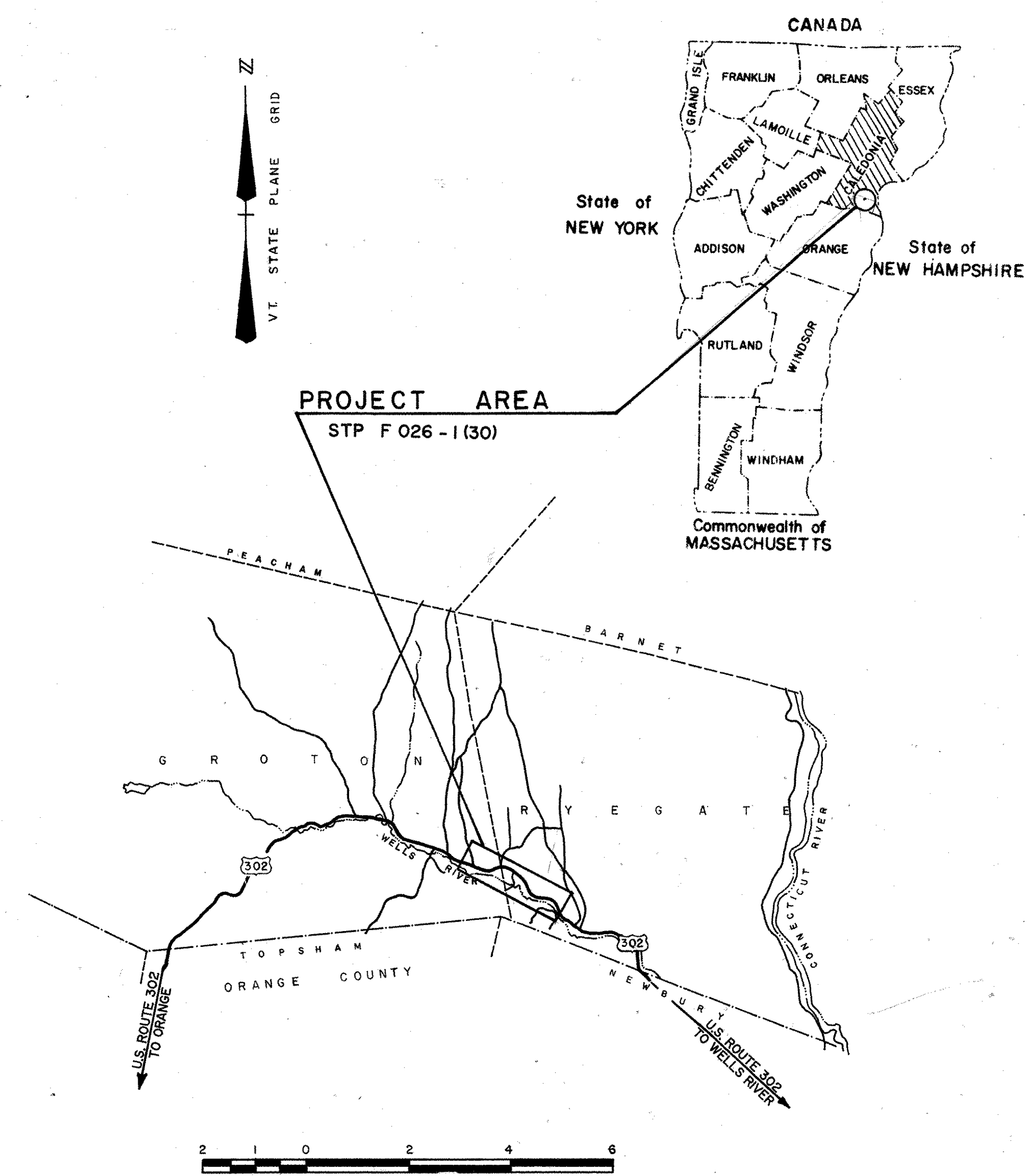

RECORD PLANS

CONTRACTOR: WINTERSET, LYNDONVILLE, VT.
 RESIDENT ENGINEER: ROSS CLARK
 CONSTRUCTION BEGAN: June 9, 1997
 CONSTRUCTION COMPLETED: Oct. 16, 1998
 RECORD PLANS BY: Jacques Couture

I HEREBY CERTIFY THAT ALL THE CONSTRUCTION REQUIRED BY THIS SET OF DRAWINGS HAS BEEN ACCOMPLISHED AS INDICATED HEREIN.

BY [Signature] FOR R. Clark RESIDENT ENGINEER
 DATE 02-24-03

NOTE: Any further information concerning final quantities, amounts or other details relative to this project may be found on microfilm in Central Files.

BEGINNING AT A POINT ON U.S. ROUTE 302 APPROXIMATELY 7.091 MILES
 EASTERLY OF THE TOPSHAM-GROTON TOWN LINE AND EXTENDING
 EASTERLY 2.121 MILES.

LENGTH OF ROADWAY 11199.48 FEET = 2.121 MILES
 LENGTH OF BRIDGE 0.00 FEET = 0.000 MILES
 LENGTH OF PROJECT 11199.48 FEET = 2.121 MILES

WORK TO BE PERFORMED UNDER THIS PROJECT INCLUDES GRADING, DRAINAGE,
 SUBBASE, AND PAVEMENT FOR A U.S. HIGHWAY RELOCATION.

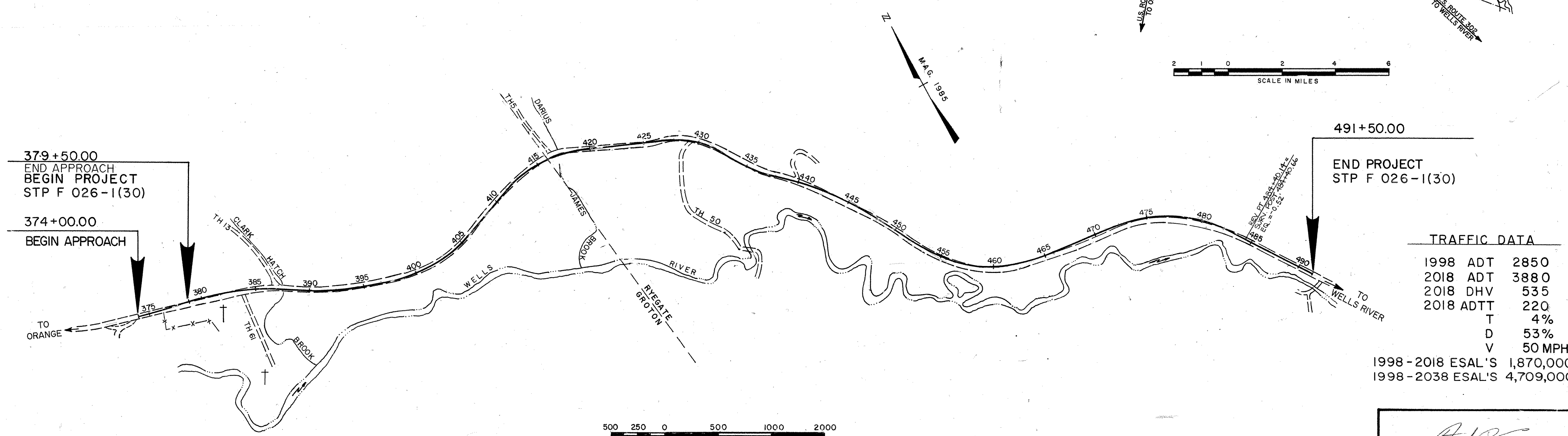

CONVENTIONAL SIGNS

- COUNTY LINE
- TOWN LINE
- LIMITS OF ACCESS
- POINT OF ACCESS
- FENCE LINE
- STONE WALL
- TRAVELED WAY
- GUARD RAIL
- RAILROAD
- SURVEY LINE
- CULVERT
- POWER POLE
- TELEPHONE POLE
- TREES
- CONTROL OF ACCESS
- PROPERTY LINE
- R.O.W TAKING LINE
- SLOPE RIGHTS
- TOP OF CUT
- TOE OF SLOPE

DATUM
 VERTICAL NGVD 1929
 HORIZONTAL N/A



TRAFFIC DATA

1998 ADT	2850
2018 ADT	3880
2018 DHV	535
2018 ADTT	220
T	4%
D	53%
V	50 MPH
1998-2018 ESAL'S	1,870,000
1998-2038 ESAL'S	4,709,000

APPROVED [Signature] DATE 3/17/97
 DIRECTOR OF ENGINEERING

DEPARTMENT OF TRANSPORTATION
 FEDERAL HIGHWAY ADMINISTRATION

APPROVED _____ DATE _____
 DIVISION ADMINISTRATOR

GROTON-RYEGATE
 STP F 026-1(30)

SHEET 1 OF 152 SHEETS

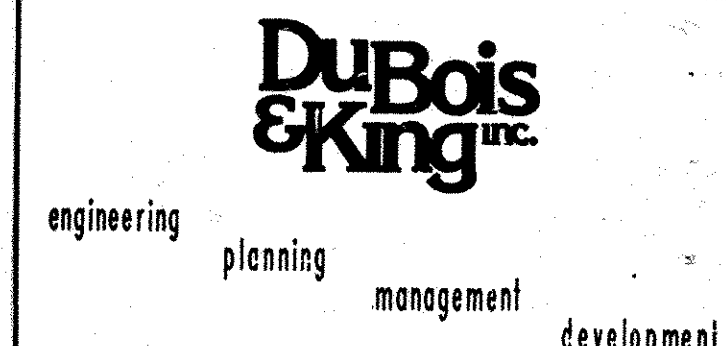

THESE PLANS ARE SUBJECT TO SUCH ENGINEERING CHANGES AS MAY BE REQUIRED BY THE FEDERAL HIGHWAY ADMINISTRATION OR THE CHIEF ENGINEER. CONSTRUCTION IS TO BE CARRIED ON IN ACCORDANCE WITH THESE PLANS AND THE STANDARD SPECIFICATIONS FOR CONSTRUCTION DATED 1990, AS APPROVED BY THE FEDERAL HIGHWAY ADMINISTRATION IN MARCH 15, 1990 FOR USE ON THIS PROJECT INCLUDING ALL SUBSEQUENT REVISIONS AND SUCH REVISED SPECIFICATIONS AND SPECIAL PROVISIONS AS ARE INCORPORATED IN THESE PLANS.