

### PRECAST CONCRETE BOX CULVERTS

1. BOX CULVERT SHALL BE DESIGNED BY A LICENSED PROFESSIONAL ENGINEER REGISTERED IN THE STATE OF VERMONT.  
DESIGN CRITERIA:

- A. SOIL UNIT WEIGHT = 140 PCF
- B. DESIGN LIVE LOAD = AASHTO HL-93
- C. MINIMUM CLEAR INSIDE DIMENSIONS: 10'-0" SPAN AND 10'-0" RISE
- D. MINIMUM COVER OVER BOX = 11 1/2" +/-

2. WATER REPELLENT, SILANE SHALL BE APPLIED TO ALL EXPOSED CONCRETE SURFACES, EXCEPT THOSE RECEIVING AN ANTI-GRAFFITI COATING. WATER REPELLENT, SILANE SHALL BE APPLIED TO THE BOTTOM OF THE BOX CULVERT ONLY ON THE END SECTIONS WITHOUT A TOP SECTION (ROOF). THE INTERIOR WALLS AND CEILING OF THE BOX CULVERT SHALL RECEIVE AN ANTI-GRAFFITI COATING. PAYMENT FOR THE ANTI-GRAFFITI COATING AND ITS APPLICATION WILL BE CONSIDERED INCIDENTAL TO CONTRACT ITEM 540.10, PRECAST CONCRETE STRUCTURE, (10' x 10' x 94' BOX).

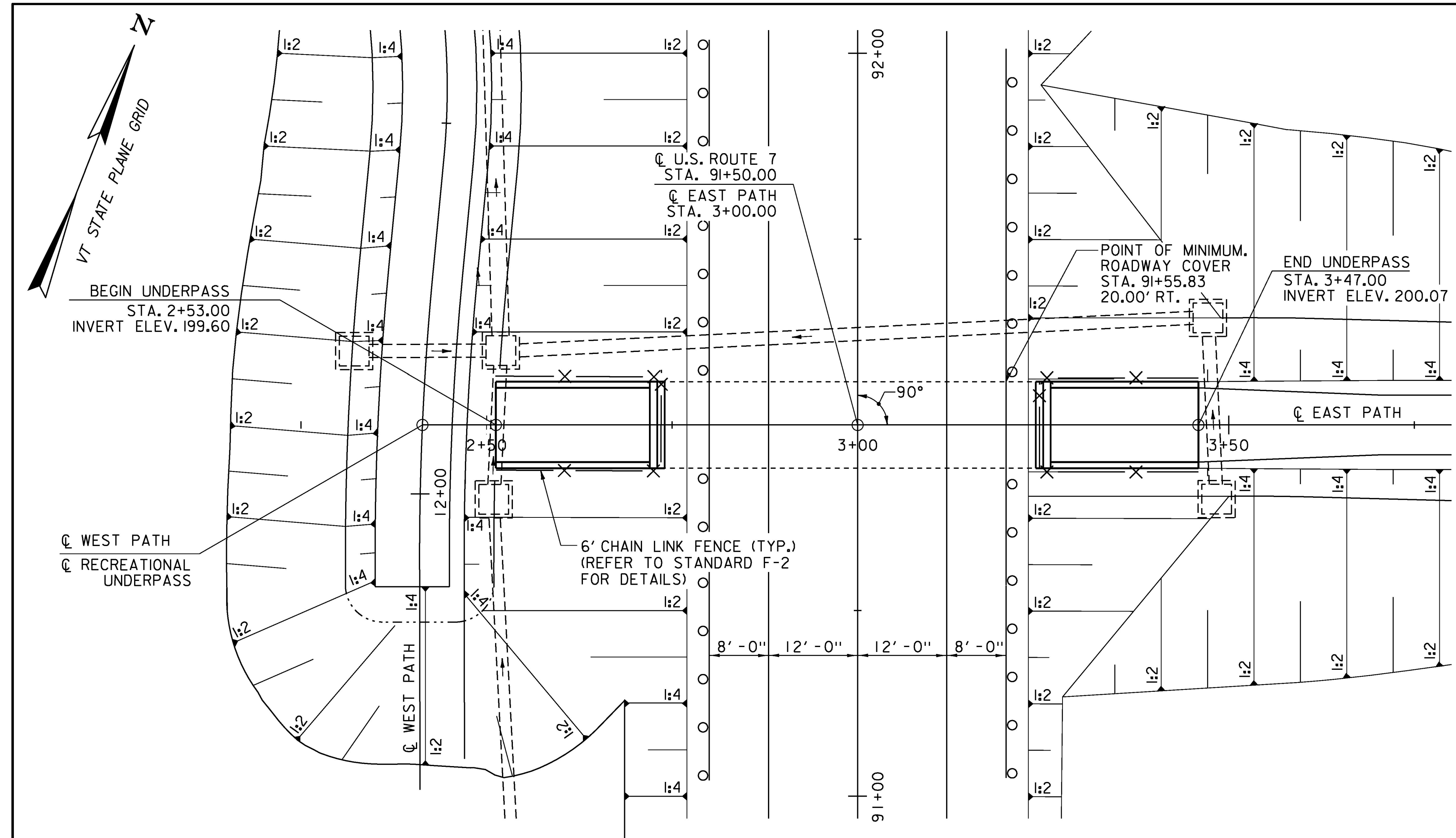

PLAN

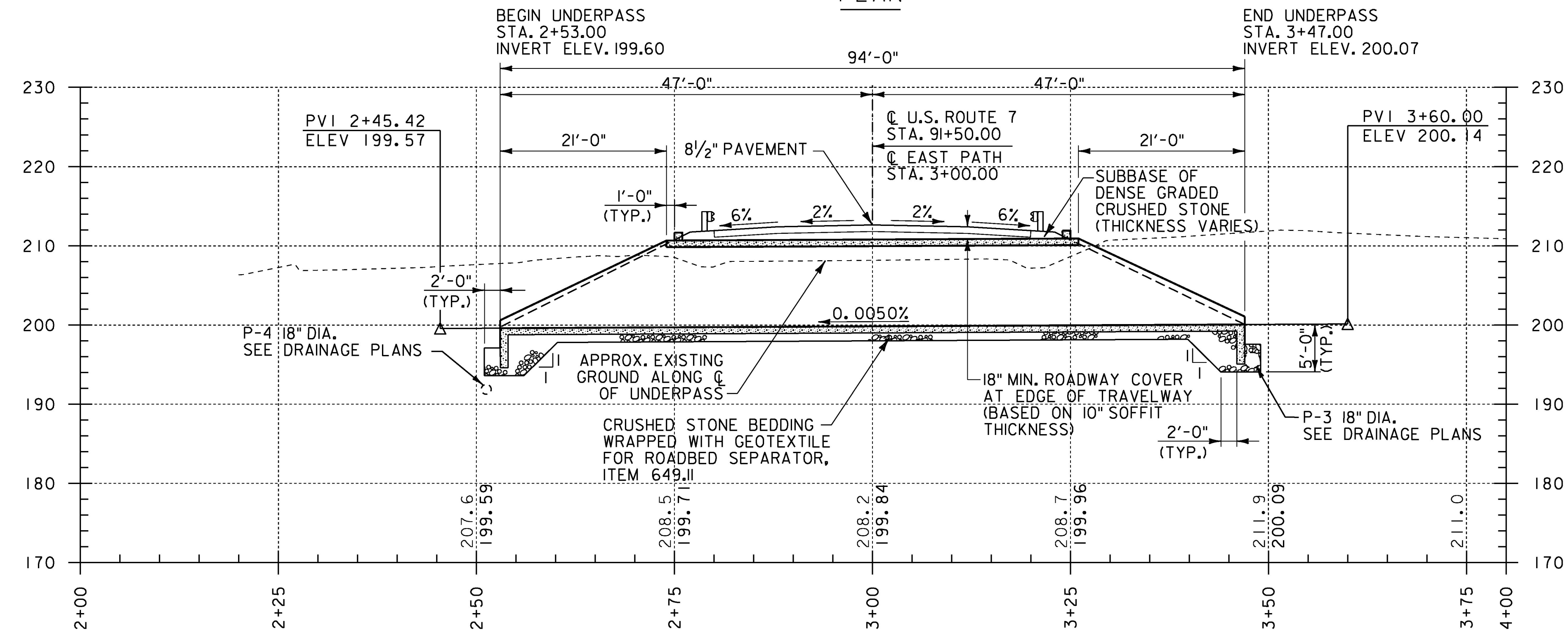

LONGITUDINAL SECTION  
(ALONG C OF UNDERPASS)

NOTE: STATIONING SHOWN ALONG EAST PATH.  
ELEVATIONS SHOWN TO THE NEAREST TENTH ARE EXISTING GROUND.  
ELEVATIONS SHOWN TO THE NEAREST HUNDRETH ARE FINISH GRADE.



PROJECT NAME: CHARLOTTE	
PROJECT NUMBER: F EGC 019-4(20)	
FILE NAME: \$FILES\$	PLOT DATE: 15-MAR-2016
PROJECT LEADER: G. BOGUE	DRAWN BY: J. SOTER
DESIGNED BY: T. KNIGHT	CHECKED BY: G. BOGUE
BRIDGE 141A LAYOUT SHEET	SHEET 251 OF 499