



SOIL CLASSIFICATION
 STOCKBRIDGE AND NELLIS
 STONEY LOAMS
 3-8% SLOPES
 K = 0.28
 MEDIUM EROSION POTENTIAL

SOIL CLASSIFICATION
 ENOSBURG AND WHATELY
 0-3% SLOPES
 K = 0.24
 LOW EROSION POTENTIAL

SOIL CLASSIFICATION
 STOCKBRIDGE AND NELLIS
 STONEY LOAMS
 8-15% SLOPES
 K = 0.28
 MEDIUM EROSION POTENTIAL

SOIL CLASSIFICATION
 STOCKBRIDGE AND NELLIS
 EXTREMELY STONEY LOAMS
 15-60% SLOPES
 K = 0.28
 HIGH EROSION POTENTIAL

SOIL CLASSIFICATION
 STOCKBRIDGE AND NELLIS
 STONEY LOAMS
 3-8% SLOPES
 K = 0.28
 MEDIUM EROSION POTENTIAL

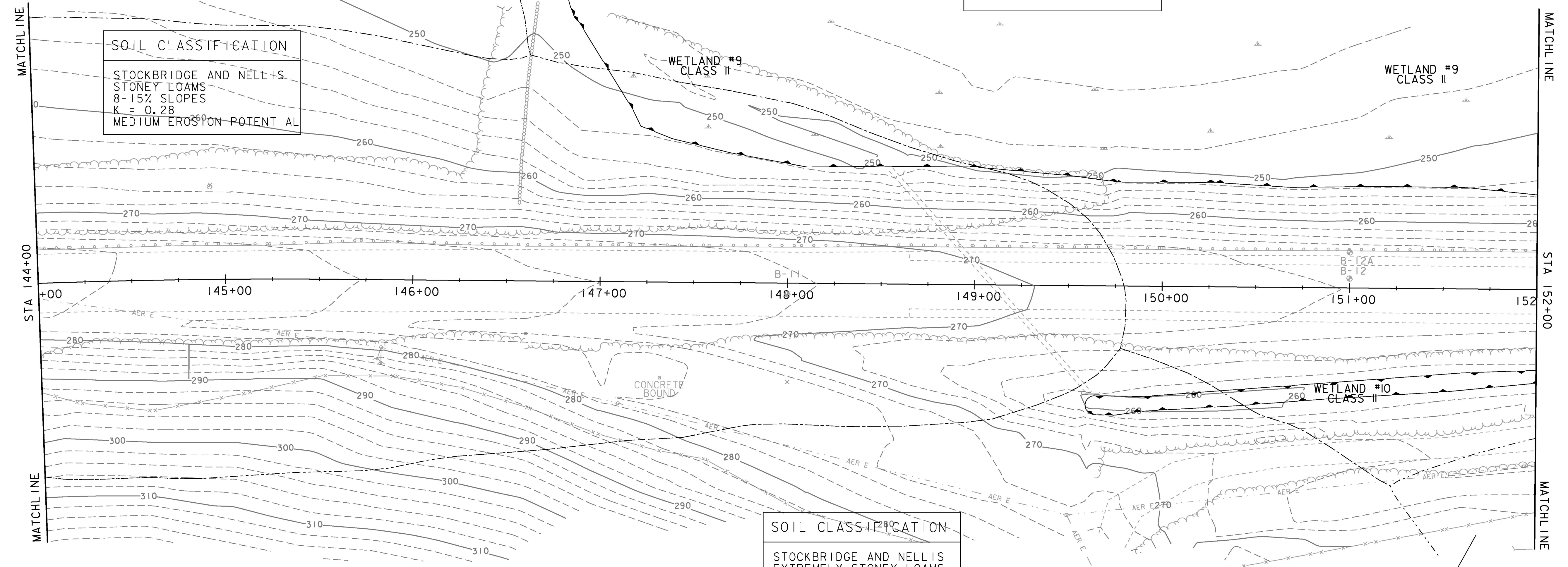

PROJECT NAME: CHARLOTTE	
PROJECT NUMBER: F EGC 019-4(20)	
FILE NAME: d78d062_ero_existing_bdr.dgn	PLOT DATE: 15-MAR-2016
PROJECT LEADER: K. UPMAL	DRAWN BY: B. KIPP
DESIGNED BY: C. LEACH	CHECKED BY: C. LEACH
EPSC EXISTING CONDITIONS SHEET 18	SHEET 135 OF 499