

CONSTRUCT GRAVEL DRIVES		
LOCATION/TYPE	RADII STA/OFFSET	APPROX. WIDTH
STA 141+86 RT/(C)	STA 141+51.55/42.02 FT STA 142+23.95/42.06 FT	26 FT

RELOCATE MAILBOX, MULTIPLE SUPPORT
STA 142+08 RT (3)

REMOVING AND RESETTING FENCE
STA 136+00 - 140+73 LT (IN-USE WOVEN WIRE)

REMOVAL OF EXISTING FENCE
STA 139+90 - 140+37 RT (ABANDONED BARBED WIRE)
STA 140+91 - 141+44 RT (ABANDONED BARBED WIRE)
STA 142+18 - 144+00 RT (ABANDONED BARBED WIRE)

STEEL BEAM GUARDRAIL, GALVANIZED
STA 136+00 - 144+00 LT

REMOVAL AND DISPOSAL OF GUARDRAIL
STA 140+17 - 144+00 LT

SPECIAL PROVISION (HAND-PLACED BITUMINOUS CONCRETE MATERIAL, DRIVES)
STA 141+86 RT

REMOVE STONEWALL (COMMON EXCAVATION)
STA 134+87 - 139+39 RT

SPECIAL PROVISION (REMOVE AND STOCKPILE STONEWALL)
STA 136+00 - 139+39 RT

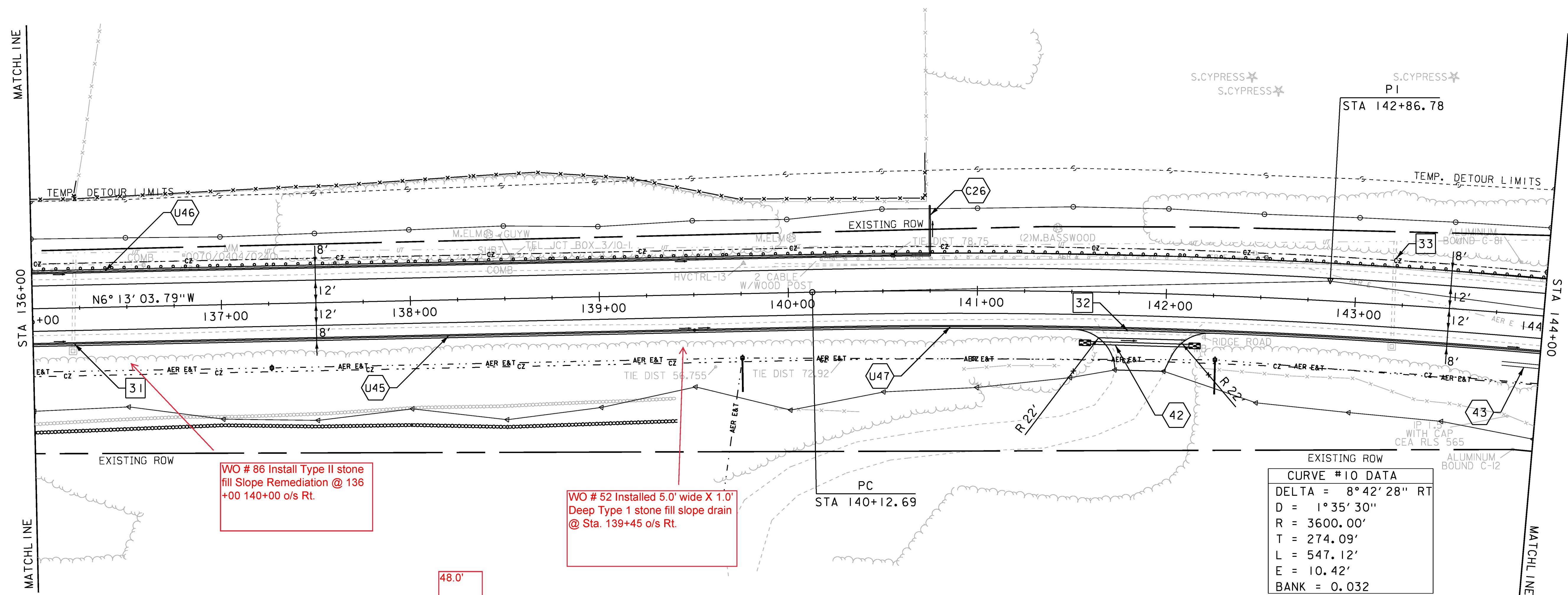

WO # 86 Install Type II stone fill Slope Remediation @ 136+00 140+00 o/s Rt.

WO # 52 Installed 5.0' wide X 1.0' Deep Type 1 stone fill slope drain @ Sta. 139+45 o/s Rt.

CURVE #10 DATA	
DELTA	= 8°42'28" RT
D	= 1°35'30"
R	= 3600.00'
T	= 274.09'
L	= 547.12'
E	= 10.42'
BANK	= 0.032

- EXISTING DRAINAGE**
- 31 STA 136+22 C/L REMOVE EXISTING 18" RCP AND DI
 - 32 STA 141+60 - 142+20 RT REMOVE EXISTING 15" CGMP
 - 33 STA 143+20 C/L REMOVE EXISTING 18" RCP AND DI

- NEW DRAINAGE**
- 42 STA 141+61 - 142+13 RT NEW 12" X 52' CPEP W/STONE PAD AT INLET & OUTLET
 - 43 STA 143+80 - 144+00 RT CONSTRUCT GRASS LINED TREATMENT SWALE SEE GRASS LINED TREATMENT SWALE DETAILS

- 8-INCH UNDERDRAIN**
- 45 STA 136+00 - 139+50 RT NEW 8" X 350' UNDERDRAIN W/FLUSHING BASIN AT 135+00 RT
 - 46 STA 136+00 - 140+75 LT NEW 8" X 475' UNDERDRAIN W/FLUSHING BASIN AT 135+00 LT
 - 47 STA 139+50 - 144+00 RT NEW 8" X 450' UNDERDRAIN W/FLUSHING BASIN AT 139+50 RT

- 8-INCH UNDERDRAIN CARRIER PIPE**
- C26 STA 140+75 LT NEW 8" X 27' UD CARRIER PIPE

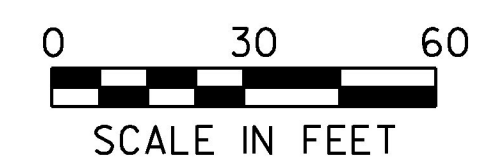

PROJECT NAME:	CHARLOTTE	PLOT DATE:	15-MAR-2016
PROJECT NUMBER:	F EGC 019-4(20)	DRAWN BY:	B. KIPP
FILE NAME:	d78d062_nul_bdr.dgn	CHECKED BY:	C. LEACH
DESIGNED BY:	B. KIPP	PLAN SHEET 17	SHEET 95 OF 499