

CONSTRUCT GRAVEL DRIVES		
LOCATION/TYPE	RADII STA/OFFSET	APPROX. WIDTH
STA 129+90 RT/(R)	STA 129+74.49/32.00 FT STA 130+10.93/32.00 FT	14 FT
STA 132+25 RT/(F)	STA 132+02.81/32.00 FT STA 132+47.19/32.00 FT	20 FT
STA 134+31 RT/(R)	STA 134+09.57/32.00 FT STA 134+47.77/32.00 FT	14 FT

CONSTRUCT PAVED DRIVES		
LOCATION/TYPE	RADII STA/OFFSET	APPROX. WIDTH
STA 132+13 LT/(C)	STA 131+89.50/42.00 FT STA 132+53.28/42.00 FT	20 FT

RELOCATE MAILBOX, SINGLE SUPPORT
 STA 134+39 LT
 REMOVING AND RESETTING FENCE
 STA 132+62 - 136+00 LT (IN-USE WOVEN WIRE)
 STEEL BEAM GUARDRAIL, GALVANIZED
~~STA 128+00 - 131+44 LT~~
~~STA 132+90 - 136+00 LT~~
 MANUFACTURED TERMINAL SECTION, FLARED
~~STA 131+44 - 131+82 LT~~
~~STA 132+52 - 132+90 LT~~
 REMOVAL AND DISPOSAL OF GUIDE POSTS
 STA 129+93 LT
 STA 134+05 RT
 STA 134+51 RT
 STA 135+17 LT

SPECIAL PROVISION (HAND-PLACED BITUMINOUS CONCRETE MATERIAL, DRIVES)
 STA 129+90 RT
 STA 132+25 RT
 STA 134+31 RT
 SPECIAL PROVISION (REMOVE AND STOCKPILE STONEWALL)
 STA 134+87 - 136+00 RT

Eliminated as per WO # 60

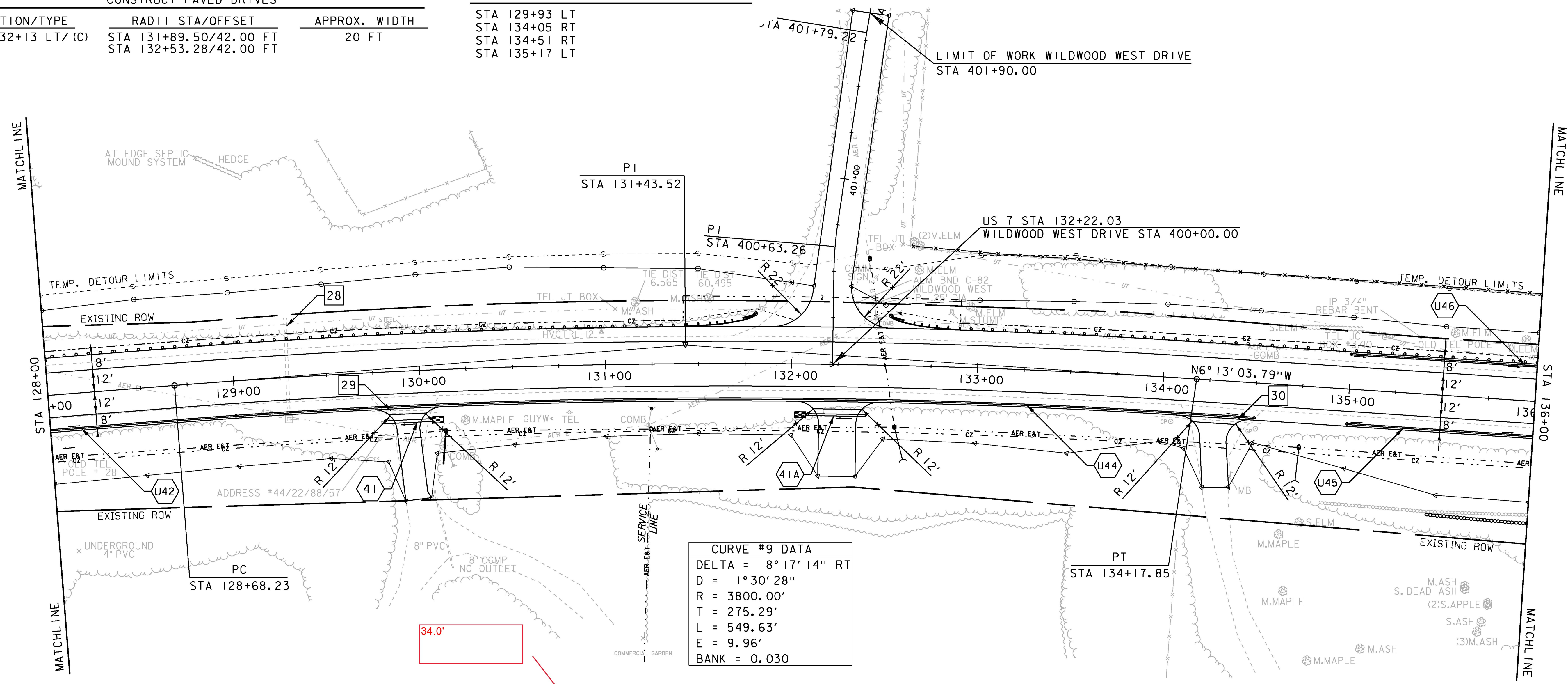

EXISTING DRAINAGE	
28	STA 129+29 C/L REMOVE EXISTING 18" RCP AND DI
29	STA 129+74 - 130+09 RT REMOVE EXISTING 18" CGMP
30	STA 133+96 - 134+55 RT REMOVE EXISTING 15" CGMP

NEW DRAINAGE	
41	STA 129+79 - 130+06 RT NEW 18" X 27' CPEP W/STONE PAD AT INLET
41A	STA 132+08 - 132+40 RT NEW 12" X 32' CPEP W/STONE PAD AT OUTLET

8-INCH UNDERDRAIN	
U42	STA 128+00 - 129+00 RT NEW 8" X 100' UNDERDRAIN W/FLUSHING BASIN AT 129+00 RT
U44	STA 129+00 - 134+50 RT NEW 8" X 550' UNDERDRAIN W/FLUSHING BASIN AT 134+50 RT
U45	STA 135+00 - 136+00 RT NEW 8" X 100' UNDERDRAIN W/FLUSHING BASIN AT 135+00 RT
U46	STA 135+00 - 136+00 LT NEW 8" X 100' UNDERDRAIN W/FLUSHING BASIN AT 135+00 LT

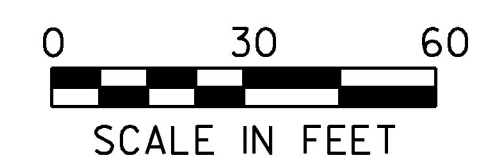

PROJECT NAME:	CHARLOTTE	FILE NAME:	d78d062_nul_bdr.dgn	PLOT DATE:	15-MAR-2016
PROJECT NUMBER:	F EGC 019-4(20)	PROJECT LEADER:	K. UPMAL	DRAWN BY:	B. KIPP
		DESIGNED BY:	B. KIPP	CHECKED BY:	C. LEACH
		PLAN SHEET 16		SHEET	93 OF 499