

CONSTRUCT GRAVEL DRIVES		
LOCATION/TYPE	RADII STA/OFFSET	APPROX. WIDTH
STA 120+17 LT/(R)	STA 119+79.01/30.00 FT STA 120+19.60/32.00 FT	10 FT

- REMOVING AND RESETTING FENCE  
STA 120+14 - 120+94 LT (ORNAMENTAL WOOD POST & RAIL)
- STEEL BEAM GUARDRAIL, GALVANIZED  
STA 120+81 - 128+00 LT
- MANUFACTURED TERMINAL SECTION, FLARED  
STA 120+43 - 120+81 LT
- REMOVAL AND DISPOSAL OF GUIDE POSTS  
STA 123+60 LT

SPECIAL PROVISION (HAND-PLACED BITUMINOUS CONCRETE MATERIAL, DRIVES)  
STA 120+17 LT

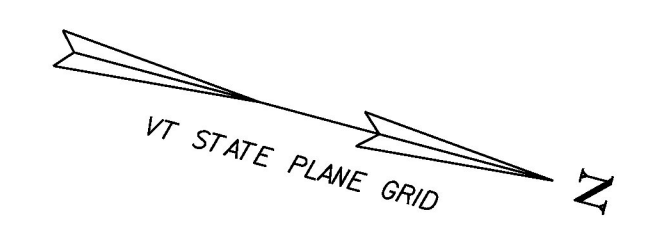

WO # 99 Install Stine Lined Swale @ 119+25 - 129+75 o/s Rt.

Eliminated as per WO # 60.

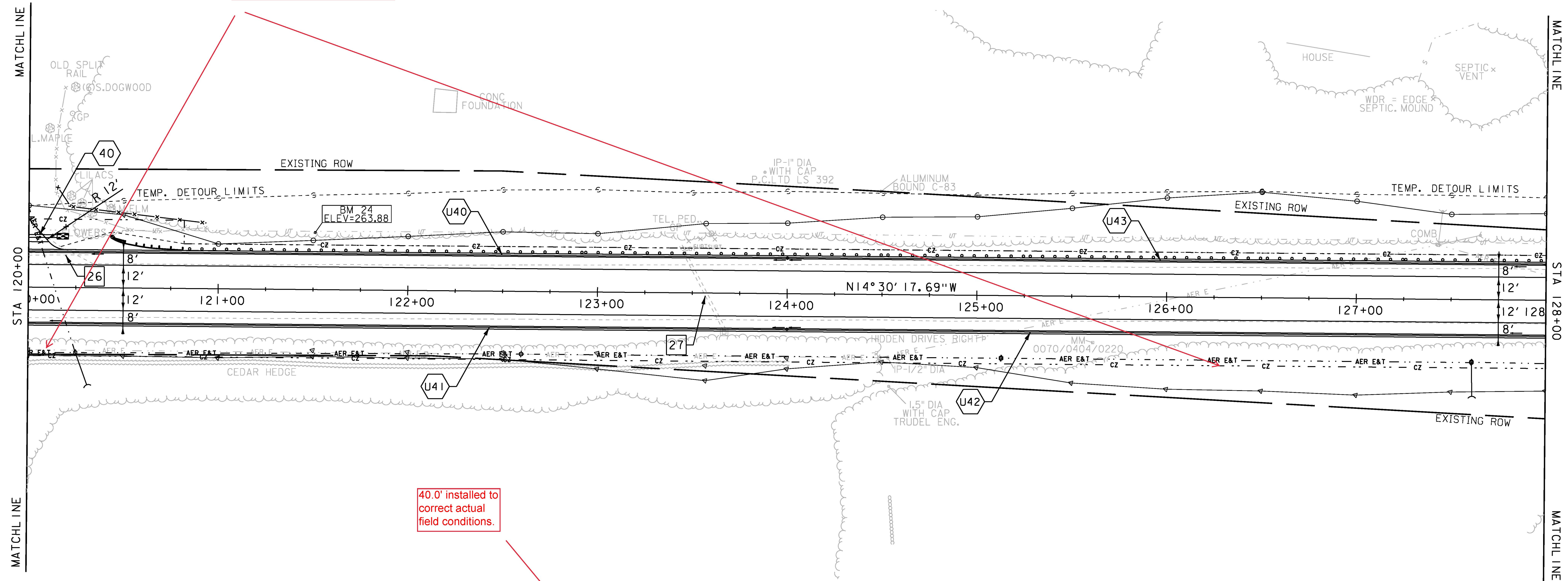

EXISTING DRAINAGE	
26	STA 120+00 - 120+32 LT REMOVE EXISTING 15" CGMP
27	STA 123+43 LT - 123+67 RT REMOVE EXISTING 18" RCP AND DI

NEW DRAINAGE	
40	STA 120+00 - 120+15 LT NEW 18" X 15' CPEP W/STONE PAD AT INLET & OUTLET

8-INCH UNDERDRAIN	
U40	STA 120+00 - 124+00 LT NEW 8" X 400' UNDERDRAIN W/FLUSHING BASIN AT 124+00 LT
U41	STA 120+00 - 124+00 RT NEW 8" X 400' UNDERDRAIN W/FLUSHING BASIN AT 124+00 RT

8-INCH UNDERDRAIN	
U42	STA 124+00 - 128+00 RT NEW 8" X 400' UNDERDRAIN W/FLUSHING BASIN AT 129+00 RT
U43	STA 124+00 - 128+00 LT NEW 8" X 400' UNDERDRAIN W/FLUSHING BASIN AT 128+00 LT

40.0' installed to correct actual field conditions.

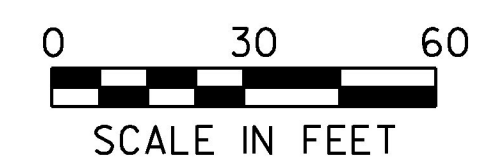

PROJECT NAME: CHARLOTTE	PLOT DATE: 15-MAR-2016
PROJECT NUMBER: F EGC 019-4(20)	DRAWN BY: B. KIPP
FILE NAME: d78d062_nul_bdr.dgn	CHECKED BY: C. LEACH
DESIGNED BY: B. KIPP	SHEET 91 OF 499