

| CONSTRUCT GRAVEL DRIVES | | |
|-------------------------|--|---------------|
| LOCATION/TYPE | RADII STA/OFFSET | APPROX. WIDTH |
| STA 35+95 RT/(R) | STA 35+74.25/32.00 FT STA 36+16.97/32.00 FT | 19 FT |
| STA 36+00 LT/(R) | STA 35+85.11/32.00 FT STA 36+27.16/32.00 FT | 15 FT |
| STA 36+70 LT/(R) | STA 36+51.94/32.00 FT STA 36+88.05/32.00 FT | 12 FT |
| STA 38+10 RT/(R) | STA 37+70.40/32.00 FT STA 38+16.00/32.00 FT | 16 FT |

| RELOCATE MAILBOX, SINGLE SUPPORT | |
|---|---------------------------------------|
| STA 36+17 RT | WOVEN WIRE FENCE WITH WOOD POSTS |
| STA 34+97 - 36+07 LT | REMOVING AND RESETTNG FENCE |
| STA 32+00 - 34+97 LT (IN-USE ELECTRIC W/METAL POSTS) | REMOVAL OF EXISTING FENCE |
| STA 32+71 - 33+79 RT (CHAIN-LINK) | |
| STA 36+21 - 36+58 LT (ORNAMENTAL WOOD PLANK) | |
| STA 36+78 - 37+68 LT (ORNAMENTAL WOOD PLANK) | |
| REMOVAL OF EXISTING FENCE | |
| STA 32+00 - 35+89 LT (WOVEN & BARBED WIRE W/WOOD POSTS) | |
| STA 35+89 - 36+06 LT (IN-USE WOOD PLANK) | |
| STA 34+97 - 35+92 LT (WOVEN WIRE FENCE W/WOOD POSTS) | |
| STA 32+00 - 32+68 RT (ABANDONED BARBED WIRE) | |
| STA 37+79 - 40+00 LT (IN-USE WOVEN WIRE W/WOOD POSTS) | |
| STEEL BEAM GUARDRAIL, GALVANIZED | |
| STA 38+40 - 40+00 LT | MANUFACTURED TERMINAL SECTION, FLARED |
| STA 38+02 - 38+40 LT | |

| REMOVAL AND DISPOSAL OF GUIDE POSTS | |
|--|--|
| STA 32+13 RT | |
| STA 36+07 RT | |
| STA 39+68 LT | |
| STA 39+76 LT | |
| STA 39+83 LT | |
| SPECIAL PROVISION (HAND-PLACED BITUMINOUS CONCRETE MATERIAL, DRIVES) | |
| STA 35+95 RT | |
| STA 36+00 LT | |
| STA 36+70 LT | |
| STA 38+10 RT | |

| SPECIAL PROVISION (BARBED WIRE FENCE, CEDAR POST 4-STRAND) | |
|--|--|
| STA 32+00 - 33+79 RT | |

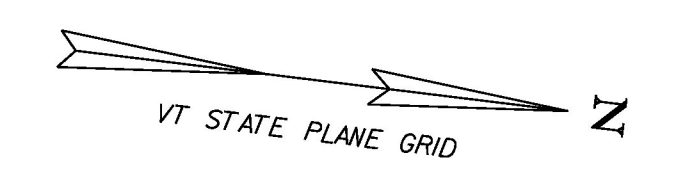

Install Two (2) Rail White Vinyl PVC Fencing @ 36+21 - 36+58 & 36+78 - 37+68 o/s Lt. WO # 34.

38+02 - 38+40 & 40+90 - 41+38 o/s Lt.

38+40 - 40+90 o/s Lt.

| CURVE #4 DATA | |
|---------------|-------------|
| DELTA = | 4°00'52" LT |
| D = | 0°34'23" |
| R = | 10000.00' |
| T = | 350.46' |
| L = | 700.64' |
| E = | 6.14' |
| BANK = | NC |

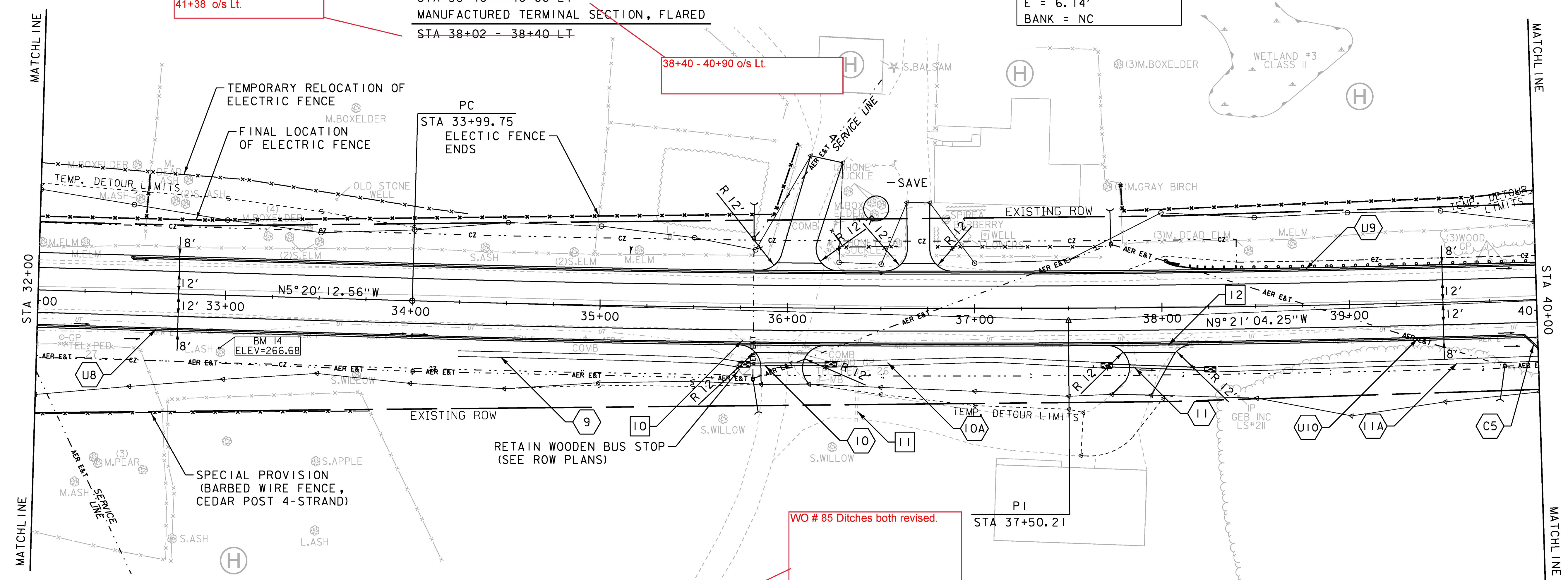

| EXISTING DRAINAGE | |
|-------------------|--|
| 10 | STA 35+69 - 36+09 RT REMOVE EXISTING 15" CGMP |
| 11 | STA 36+38 RT RETAIN EXISTING 15" CGMP |
| 12 | STA 37+76 - 38+16 RT REMOVE EXISTING 12" CGMP |

| NEW DRAINAGE | |
|--------------|--|
| 9 | STA 34+25 - 35+75 RT CONSTRUCT GRASS LINED TREATMENT SWALE SEE GRASS LINED TREATMENT SWALE DETAILS |
| 10 | STA 35+81 - 36+20 RT NEW 18" X 40' CPEP W/STONE PAD AT INLET & OUTLET |
| 10A | STA 36+26 - 37+67 RT CONSTRUCT GRASS LINED TREATMENT SWALE SEE GRASS LINED TREATMENT SWALE DETAILS |

| NEW DRAINAGE | |
|--------------|--|
| 11 | STA 37+73 - 38+22 RT NEW 18" X 50' CPEP W/STONE PAD AT INLET & OUTLET |
| 11A | STA 38+28 - 40+00 RT CONSTRUCT GRASS LINED TREATMENT SWALE SEE GRASS LINED TREATMENT SWALE DETAILS |

| 8-INCH UNDERDRAIN | |
|-------------------|--|
| U8 | STA 32+00 - 34+00 RT NEW 8" X 200' UNDERDRAIN W/FLUSHING BASIN AT 28+30 RT |
| U9 | STA 32+50 - 40+00 LT NEW 8" X 750' UNDERDRAIN W/FLUSHING BASIN AT 32+50 & 36+50 LT |
| U10 | STA 34+00 - 39+93 RT NEW 8" X 595' UNDERDRAIN W/FLUSHING BASIN AT 34+00 RT |

| 8-INCH UNDERDRAIN CARRIER PIPE | |
|--------------------------------|---|
| C5 | STA 39+93 - 40+00 RT NEW 8" X 7' UD CARRIER PIPE |

WO # 85 Ditches both revised.



| | |
|-----------------|---------------------|
| PROJECT NAME: | CHARLOTTE |
| PROJECT NUMBER: | F EGC 019-4(20) |
| FILE NAME: | d78d062_nul_bdr.dgn |
| DESIGNED BY: | B. KIPP |
| PLANNED BY: | B. KIPP |
| CHECKED BY: | C. LEACH |
| PLOT DATE: | 15-MAR-2016 |
| DRAWN BY: | B. KIPP |
| CHECKED BY: | C. LEACH |
| SHEET | 69 OF 499 |