

CONSTRUCT GRAVEL DRIVES		
LOCATION/TYPE	RADII STA/OFFSET	APPROX. WIDTH
STA 18+10 LT/ (R)	STA 17+92.33/32.00 FT STA 18+27.58/32.00 FT	12 FT
STA 18+75 RT/ (R)	STA 18+63.07/32.00 FT STA 19+00.67/32.00 FT	12 FT
STA 18+82 LT/ (R)	STA 18+67.28/32.00 FT STA 19+12.38/32.00 FT	14 FT

RELOCATE MAILBOX, MULTIPLE SUPPORT
 STA 18+56 RT (3)
REMOVAL OF EXISTING FENCE
 STA 17+41 - 17+44 LT (ORNAMENTAL 2 FT PICKET FENCE)
 STA 16+13 - 16+18 RT (ABANDONED WOOD POST & RAIL)
 STA 16+16 - 18+03 RT (ABANDONED WOOD POST & ELECTRIC TAPE)
 STA 17+74 - 18+04 RT (ABANDONED WOOD POST & ELECTRIC TAPE)
 STA 18+59 - 18+79 LT (ORNAMENTAL WOOD SNAKE RAIL)
 STA 19+45 - 23+63 RT (IN-USE BARBED WIRE)
 STA 19+67 - 20+15 LT (ABANDONED BARBED WIRE)
 STA 20+27 - 23+62 LT (ABANDONED BARBED WIRE)
 STA 22+38 - 22+42 RT (ABANDONED BARBED WIRE)
STEEL BEAM GUARDRAIL, GALVANIZED
 STA 19+48 - 24+00 LT
MANUFACTURED TERMINAL SECTION, FLARED
 STA 19+10 - 19+48 LT

SPECIAL PROVISION (HAND-PLACED BITUMINOUS CONCRETE MATERIAL, DRIVES)
 STA 18+10 LT
 STA 18+75 RT (10 FT APRON)
 STA 18+82 LT
SPECIAL PROVISION (BARBED WIRE FENCE, CEDAR POST 4-STRAND)
 STA 19+50 - 23+62 RT

Field Conditions analysis determined that G.R. was not required @ this location. WO # 16.

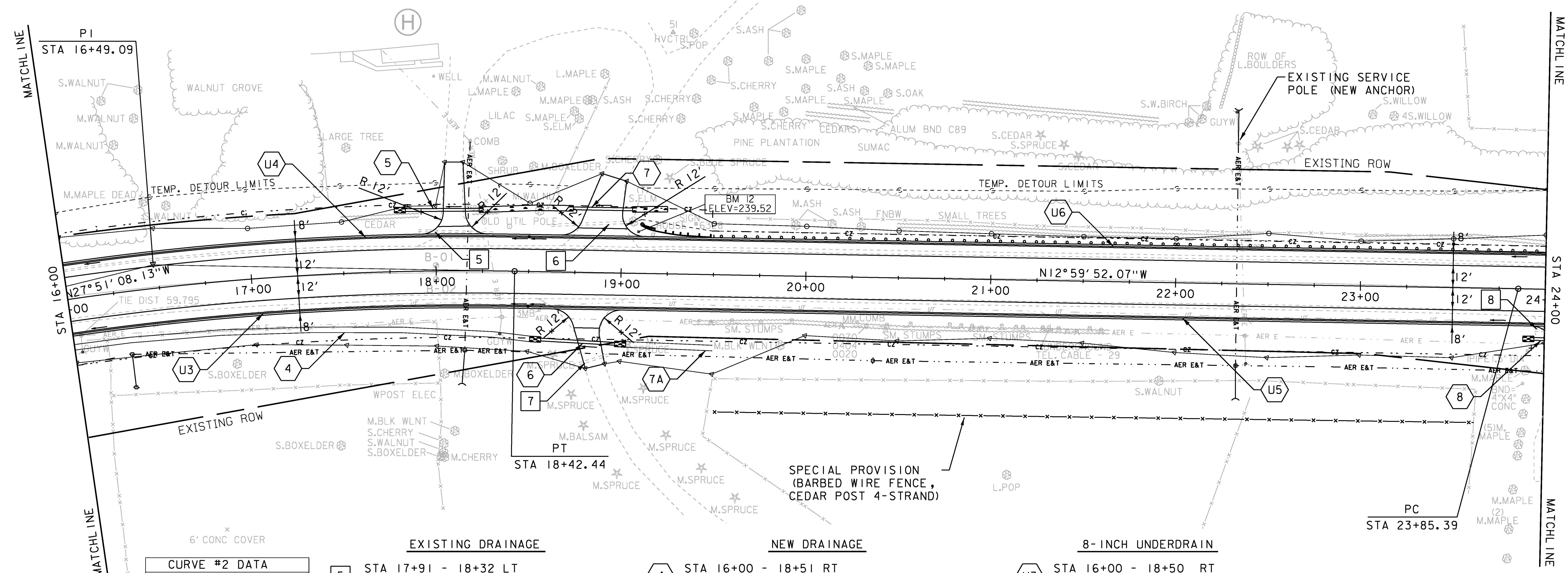
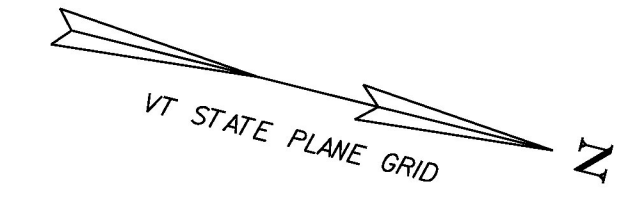

CURVE #2 DATA
 DELTA = 14°51'16" RT
 D = 3°49'11"
 R = 1500.00'
 T = 195.54'
 L = 388.89'
 E = 12.69'
 BANK = 0.062

- EXISTING DRAINAGE**
- 5 STA 17+91 - 18+32 LT
REMOVE EXISTING 12" CPEP & HDW (2)
 - 6 STA 18+62 - 19+03 LT
REMOVE EXISTING 15" CPEP
 - 7 STA 18+75 - 18+93 RT
REMOVE 15" EXISTING CGMP
 - 8 STA 23+95 - 24+00 RT
REMOVE EXISTING 15" CGMP HDW (2)

- NEW DRAINAGE**
- 4 STA 16+00 - 18+51 RT
CONSTRUCT GRASS LINED TREATMENT SWALE
SEE GRASS LINED TREATMENT SWALE DETAILS
 - 5 STA 17+84 - 18+23 LT
NEW 18" X 40" CPEP
W/STONE PAD AT INLET & OUTLET
 - 6 STA 18+57 - 18+97 RT
NEW 18" X 40" CPEP
W/STONE PAD AT INLET & OUTLET
 - 7 STA 18+74 - 19+06 LT
NEW 18" X 32" CPEP
W/STONE PAD AT INLET & OUTLET
 - 7A STA 19+03 - 19+50 RT
CONSTRUCT GRASS LINED TREATMENT SWALE
SEE GRASS LINED TREATMENT SWALE DETAILS
 - 8 STA 23+95 - 24+00 RT
NEW 18" X 5" CPEP
W/STONE PAD AT INLET & OUTLET

- 8-INCH UNDERDRAIN**
- U3 STA 16+00 - 18+50 RT
NEW 8" X 250' UNDERDRAIN
W/FLUSHING BASIN AT 18+50 RT
 - U4 STA 16+00 - 18+50 LT
NEW 8" X 250' UNDERDRAIN
W/FLUSHING BASIN AT 18+50 LT
 - U5 STA 18+50 - 24+00 RT
NEW 8" X 550' UNDERDRAIN
W/FLUSHING BASIN AT 25+00 RT
 - U6 STA 18+50 - 24+00 LT
NEW 8" X 550' UNDERDRAIN
W/FLUSHING BASIN AT 25+00 LT

125.0' DR's # 5 & # 7 were combined. See WO # 15.

30.0'

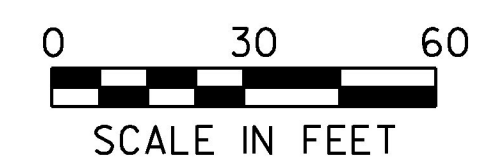

PROJECT NAME: CHARLOTTE	PLOT DATE: 15-MAR-2016
PROJECT NUMBER: F EGC 019-4(20)	DRAWN BY: B. KIPP
FILE NAME: d78d062_nul_bdr.dgn	CHECKED BY: C. LEACH
DESIGNED BY: B. KIPP	SHEET 65 OF 499
PLAN SHEET 2	